

# Gail Bolt Woodworth & Platts Addition to Whittier

Being a subdivision of lot 2 BIK E  
of the Pickering Land and Water Company's Subdivision of the

John M Thomas Ranch  
Los Angeles County Cal  
Surveyed Dec 1887 by Jessup Reece & Clappitt Surveyors  
Scale 70ft to 1 inch

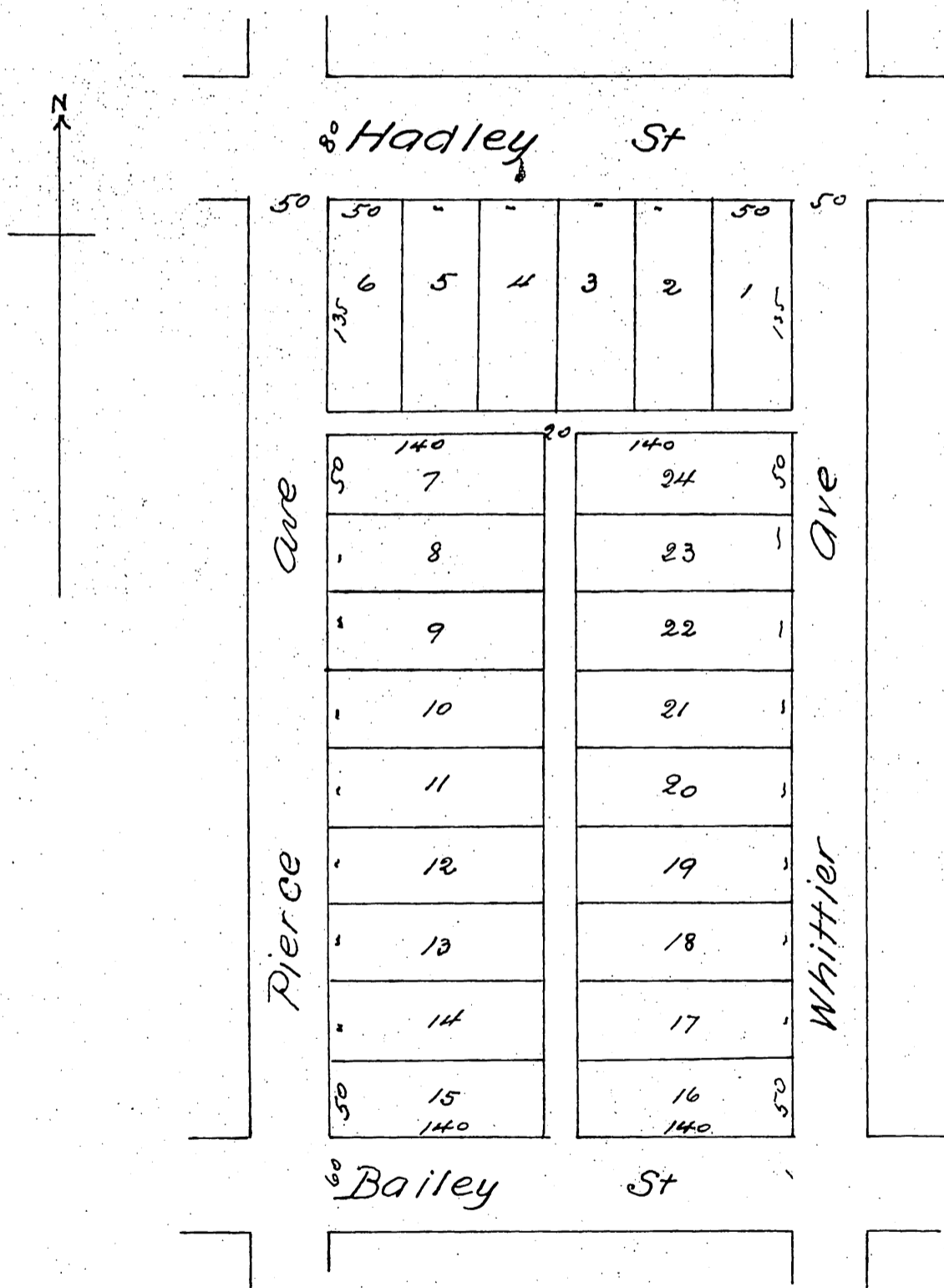

A full true and correct copy of the original reduced  
to 100ft to one inch) recorded January 6<sup>th</sup> 1888 at 7 min  
past 2 P.M. at request of J.H. Woodworth &  
Frank A Gibson Co. Recorder  
by Wm E. Johnston Deputy.