

Bailey's Subdivision Whittier

Being a subdivision of Lot 3 Block F
of the

Pickering Land and Water Company's Subdivision of the
John M Thomas Ranch

Los Angeles County Cal

Surveyed Dec 1887 by Jessup Reece & Clappitt Surveyors
Scale 70 feet to inch

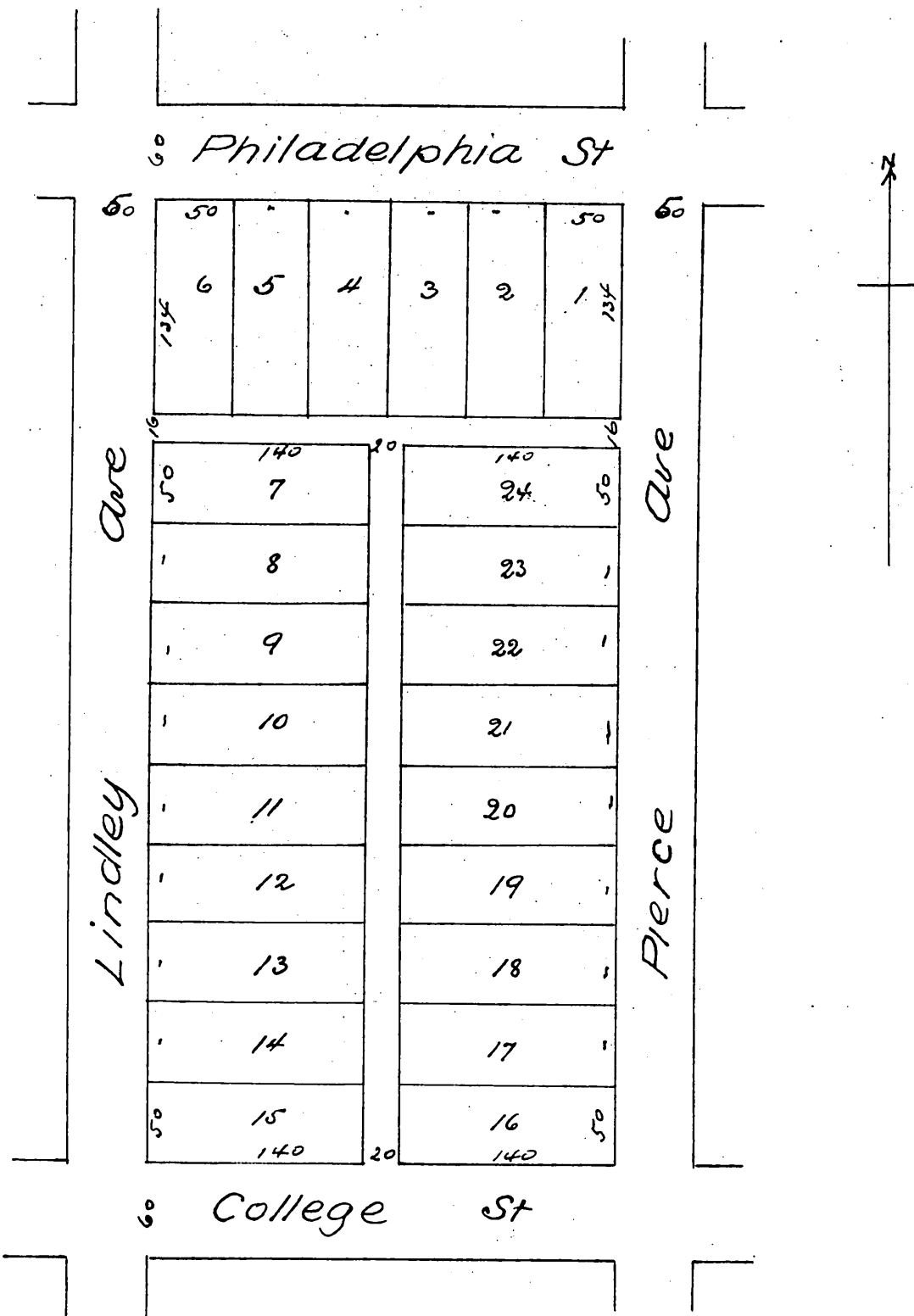

A full true and correct copy of the original
(reduced to the scale of 100 feet to one inch)
recorded January 9th 1888 at the request of Geo J. Bailey
Frank A. Gibson Co. Recorder
by Wm G. Johnston Deputy