

15
MR-31

BLOCK G

Goodwin Addition

to the Town of

SANTA ANA, CAL.

Description The same being the East one half of Block
Dresser Tract reserving from the North side 15 feet
and from the South side 25 feet for road purposes
Harry F. Stafford
Surveyor.

IN ORANGE COUNTY

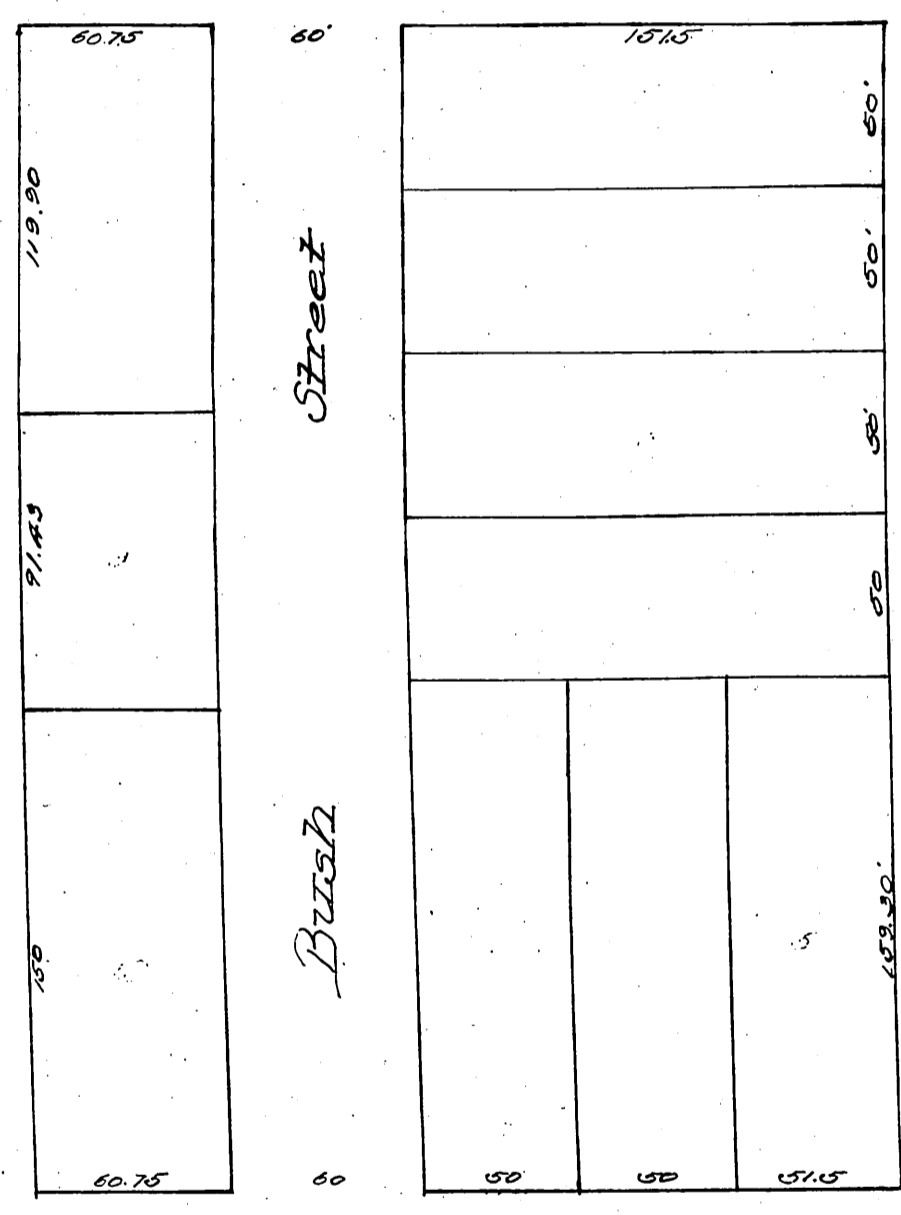

Enlarged to the scale of 60 feet to the inch.
Recorded at request of First Nat. Bank Jan 16, 1888.