

*Map*  
*of*  
*William Everett's Subdivision*  
*of Lot 1 Block 178,*  
*City of Pomona, Cal.*  
*Jas. T. Taylor & Co. Surveyors*  
*Jan 1888*  
*Scale 100ft = 1 in.*

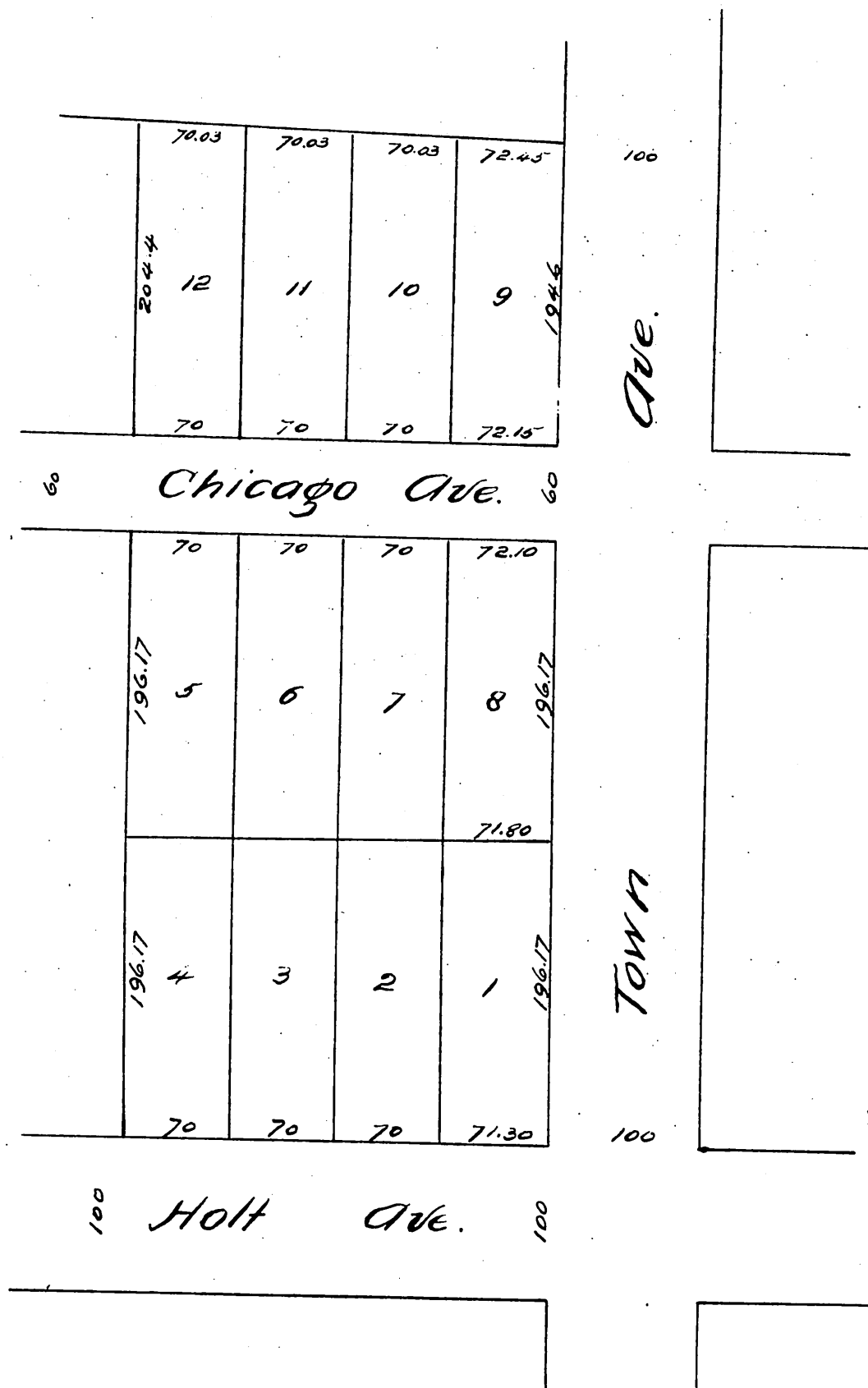

A full true and correct copy of the  
 original, recorded Feb 1, 1888 at 10  
 44 A M. at request of Jas. T. Taylor  
 & Co.  
 Frank A. Gibson County Recorder  
 By Wm. E. Johnston, Deputy.