

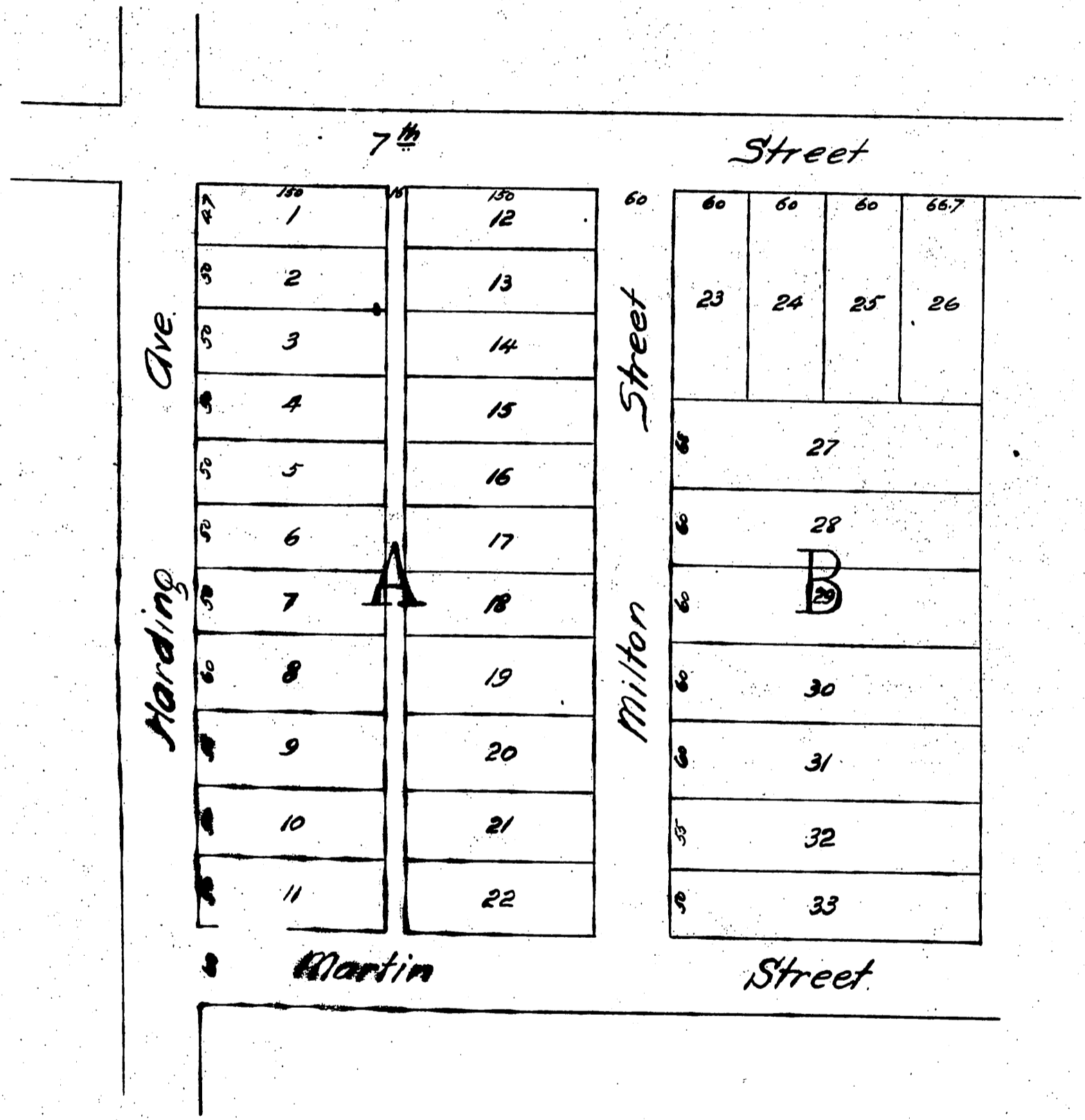

Map
of
Hilbish Re-subdivision
of the North 8^{1/2} acres of Block 128 of the MacLay
Rancho, Ex Mission de San Fernando re-
subdivided in accordance with a resolution
of the Board of Supervisors of Los Angeles
County, Cal. passed May 7th 1888.



A full, true and correct copy of the original
 (returned to the scale of 100 feet to one inch)
 recorded June 6, 1888 at 20 min. past 4 P.M.
 at request of J. M. Hilbish.
 Frank G. Gibson, County Recorder.
 by George Bayler, Deputy.