

PLAT  
 OF  
 Peck's Subdivision of Block 33  
 San Pedro, California.

Scale 80 ft to one inch.

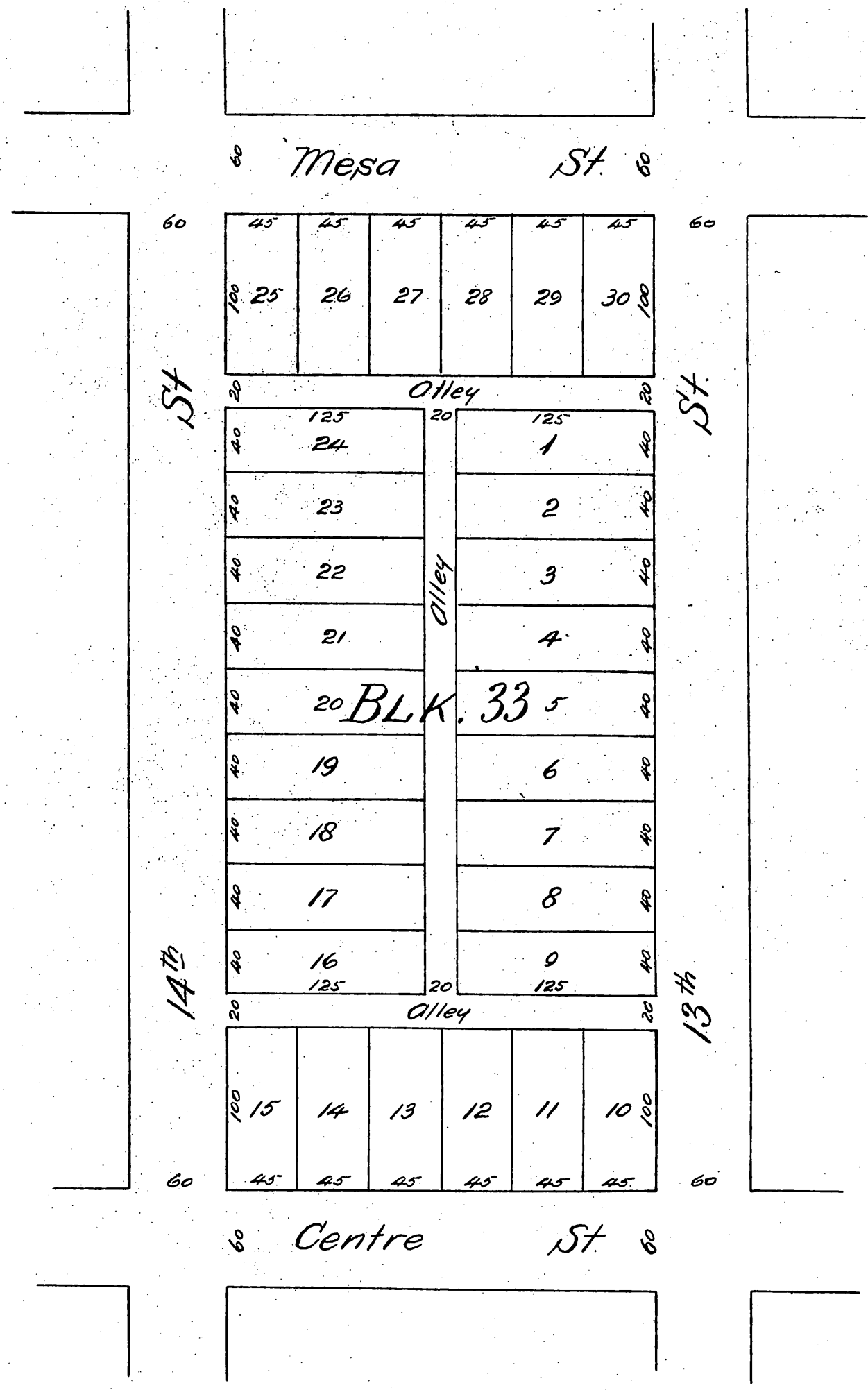

A full, true and correct copy of the original  
 recorded June 9, 1888 at 45 min. past 9 A.M.  
 at request of Geo H. Peck Jr.  
 Frank Q. Gibson, County Recorder.  
 by George Baylee, Deputy.