

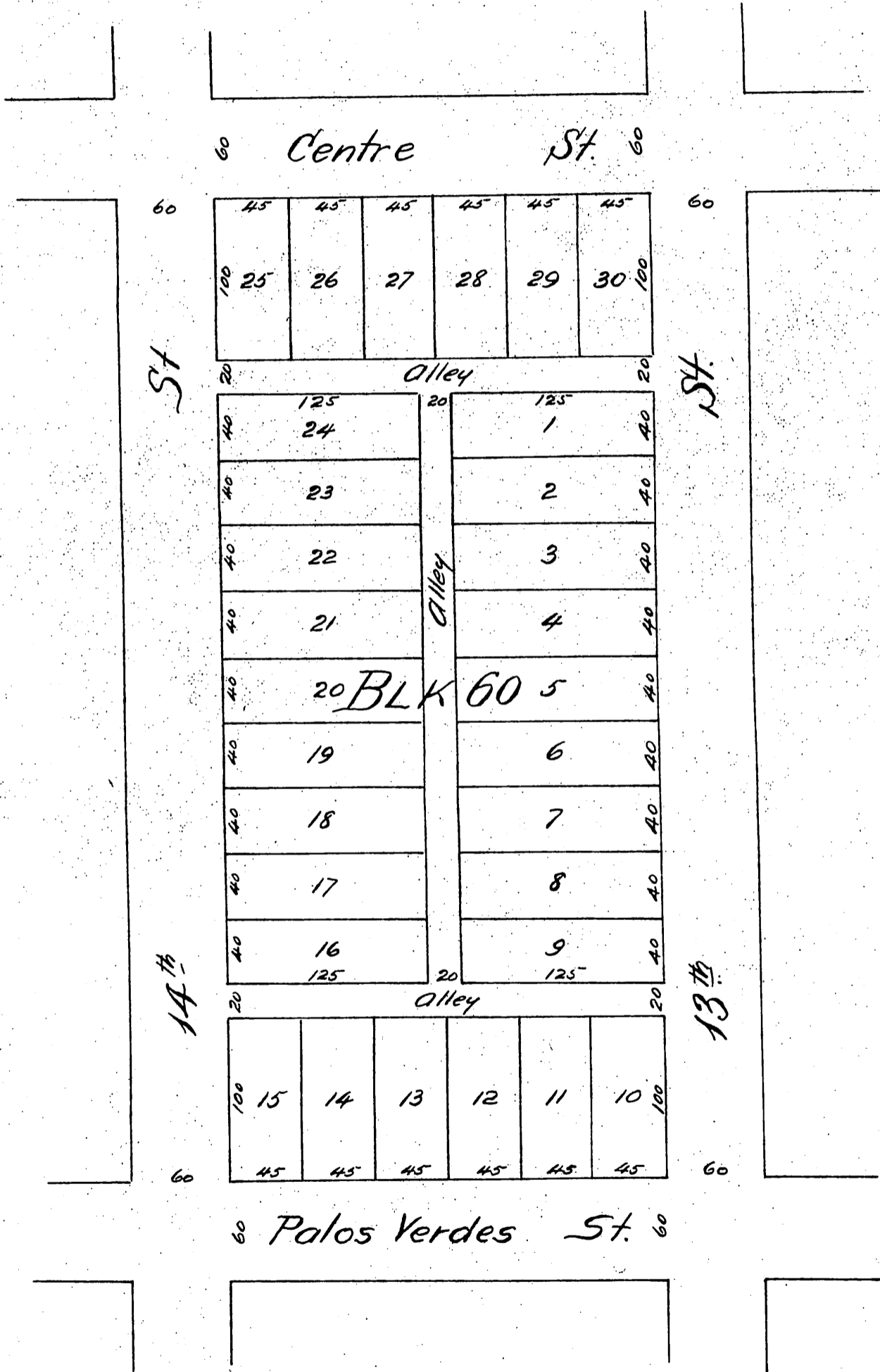

PLAT  
 OF  
 Peck's Subdivision of Block 60  
 San Pedro, California

Scale 80 ft to one inch.



A full, true and correct copy of the original  
 recorded June 9, 1888 at 44 min. past 9 A.M.  
 at request of Geo. H. Peck, Jr.

Frank A. Gibson, County Recorder.  
 by George Bugbee, Deputy.