

MAP

OF

a part of Building Lots of the "Mott Tract" in the City & County of
Los Angeles California.

Scale of one inch to four chains

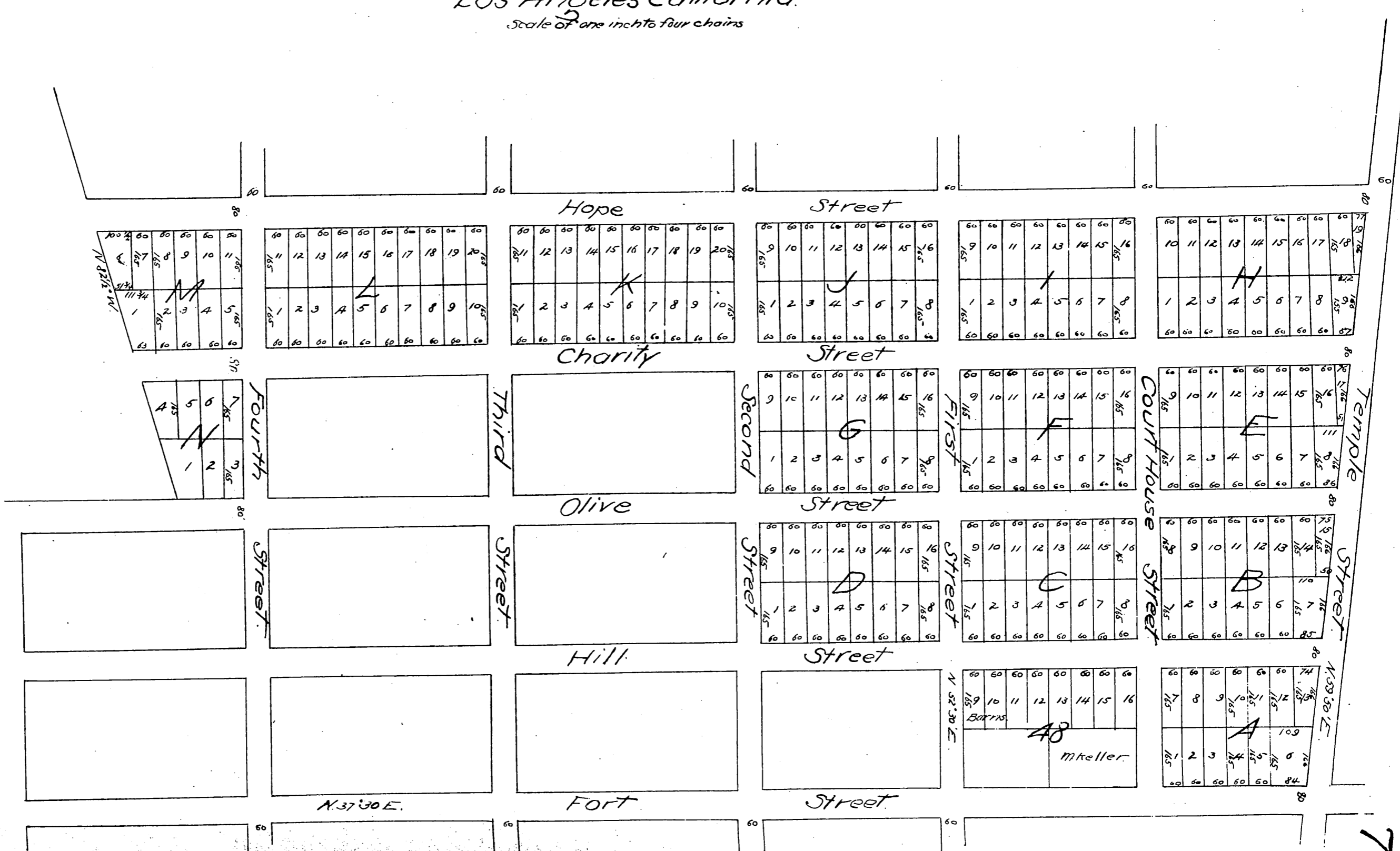

A full true and correct copy of the original recorded
March 2nd 1889 at 11 o'clock A.M. at request of S.
H. Mott

T. D. MOTT Co Recorder
By J. W. Gillette Deputy.