

A true and correct copy of the original filed for record on November 23^d 1868 at request of A. J. King Esq. City Attorney.

J. D. Mott Recorder.
by S. H. Mott. Deputy.

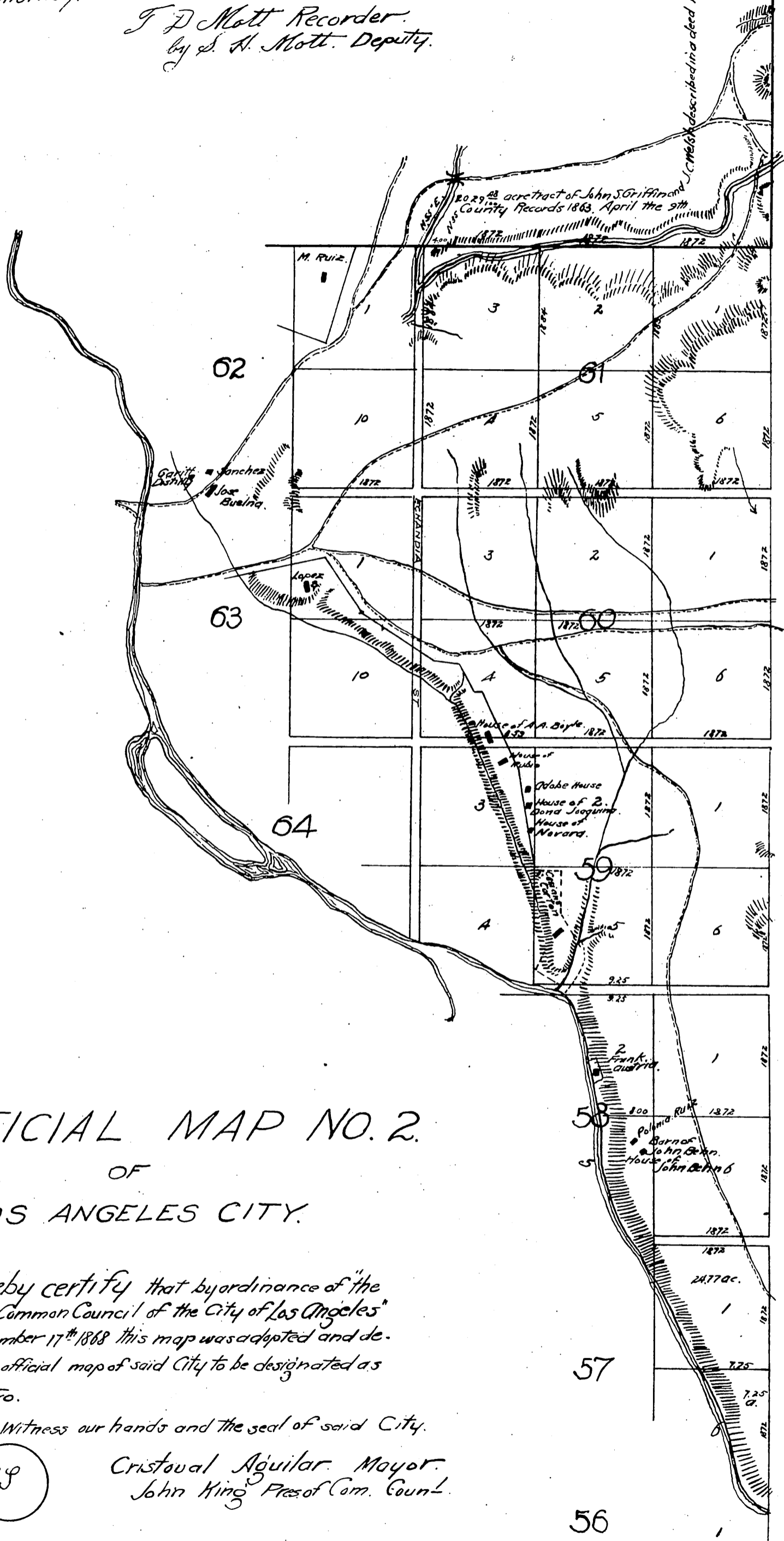

OFFICIAL MAP NO. 2. OF LOS ANGELES CITY.

We hereby certify that by ordinance of "the Mayor and Common Council of the City of Los Angeles" approved November 17th 1868 this map was adopted and declared to be an official map of said City to be designated as Number Two.

Witness our hands and the seal of said City.

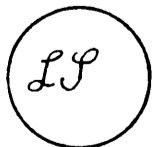

Cristoval Aguilar Mayor.
John King Pres of Com. Counl.