

# MOUNT PLEASANT TRACT.

Being a Subdivision  
of parts of

Lots 1, 2 & 6 of Block 63, Hancock's Survey

Aug. 1875

Moore & Kelleher

Scale 200 ft. one inch.

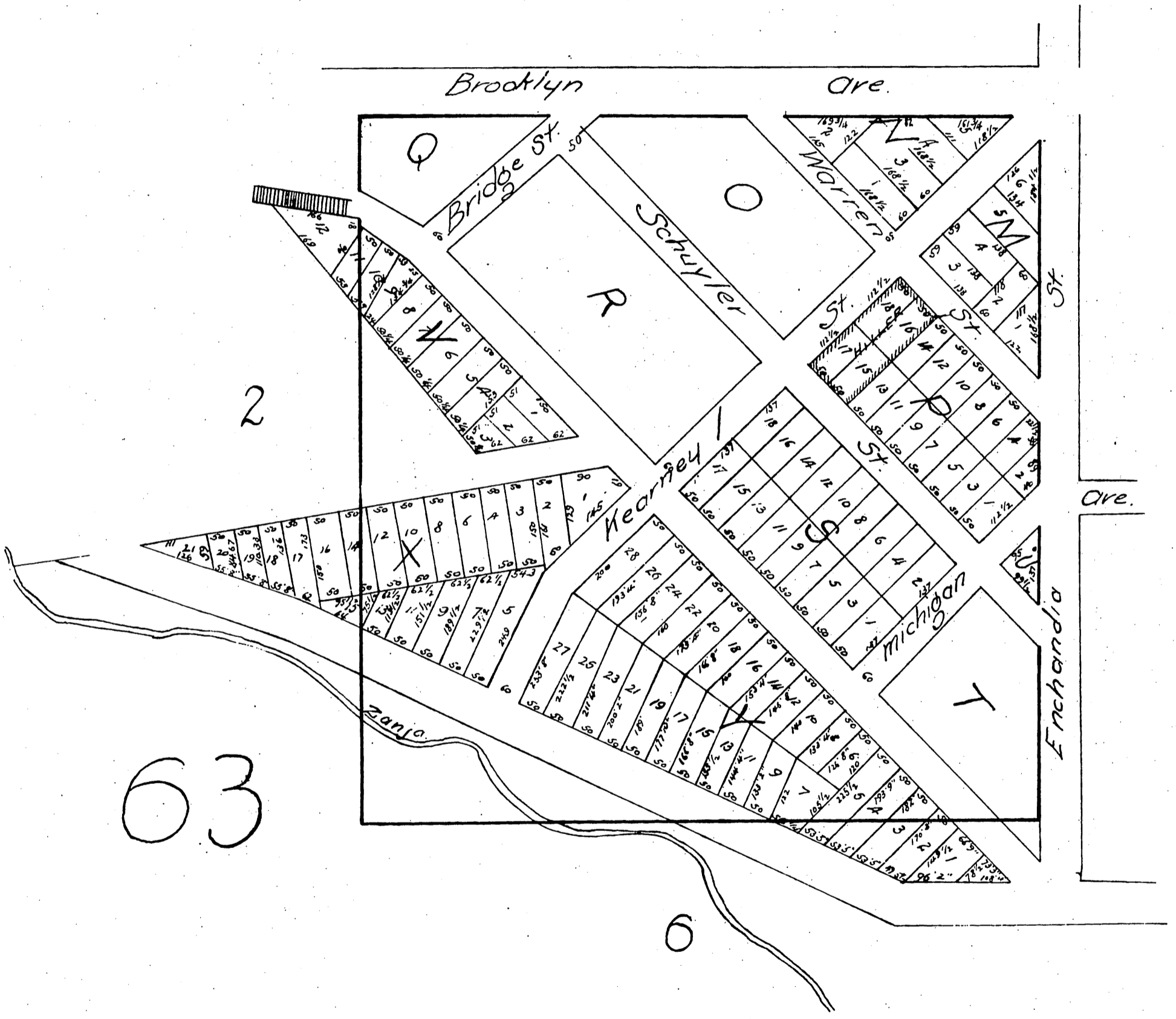

A full true and correct copy of the original recorded Aug 25, 1875  
at 35 mins past 11 A.M. for J. Lozzerich.

J. W. Gillette Co. Recorder.