

Note by County Recorder

The original is on a scale of 20 chains to the inch and was reduced as below to accommodate the size of this book.

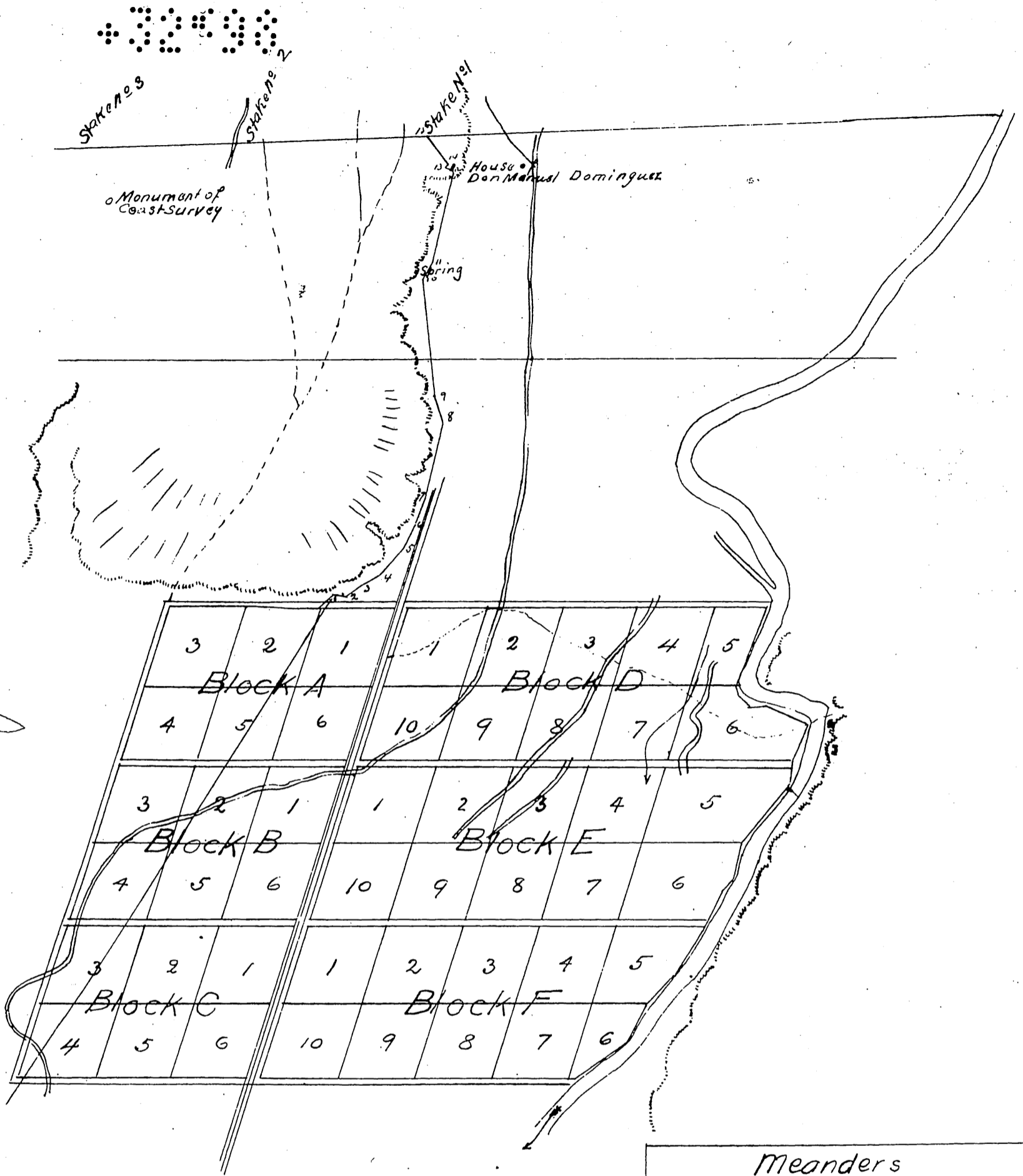

Meanders to connect with Township corner						
Sta	Course	Dist	N	S	E	W
Sec 34 ² / ₁₆	N 61 1/2° E	99.88	47.66		37.77	
Sanz de la Buzita Post 1	N 88° E	247.89	8.65		247.74	
	S 31° E	9.62		8.24	4.96	
SW. corner	S 20 3/4° W	0.14		0.13		0.05
	S 68 1/4° E	2.09		0.77	1.94	
SEC of corridor	S 14 1/2° W	24.00		23.24		6.01
11	S 26 1/2° W	5.00		4.48		2.21
10	S 5° E	30.44		29.89	2.61	
9	S 12° E	7.00		6.85	1.46	
8	S 9 1/2° W	20.00		19.75		3.30
7	S 17° W	7.00		6.69		3.05
6	S 30 3/4° W	6.00		5.16		3.07
5	S 47° W	10.00		6.82		7.31
4	S 60° W	4.50		2.25		3.89
3	S 51 1/4° W	6.50		4.07		5.07
2	N 76° W	2.50	0.60			2.42
1	S 52 3/4° W	4.50		2.72		3.58
			56.91	121.04	346.48	38.96
				56.91	38.96	
				64.13	307.52	

A full, true and correct copy of the original recorded May 2nd 1870 at 4 o'clock P.M. at request of Manuel Dominguez

Thomas D. Mott Recorder
By S.H. Mott Deputy