

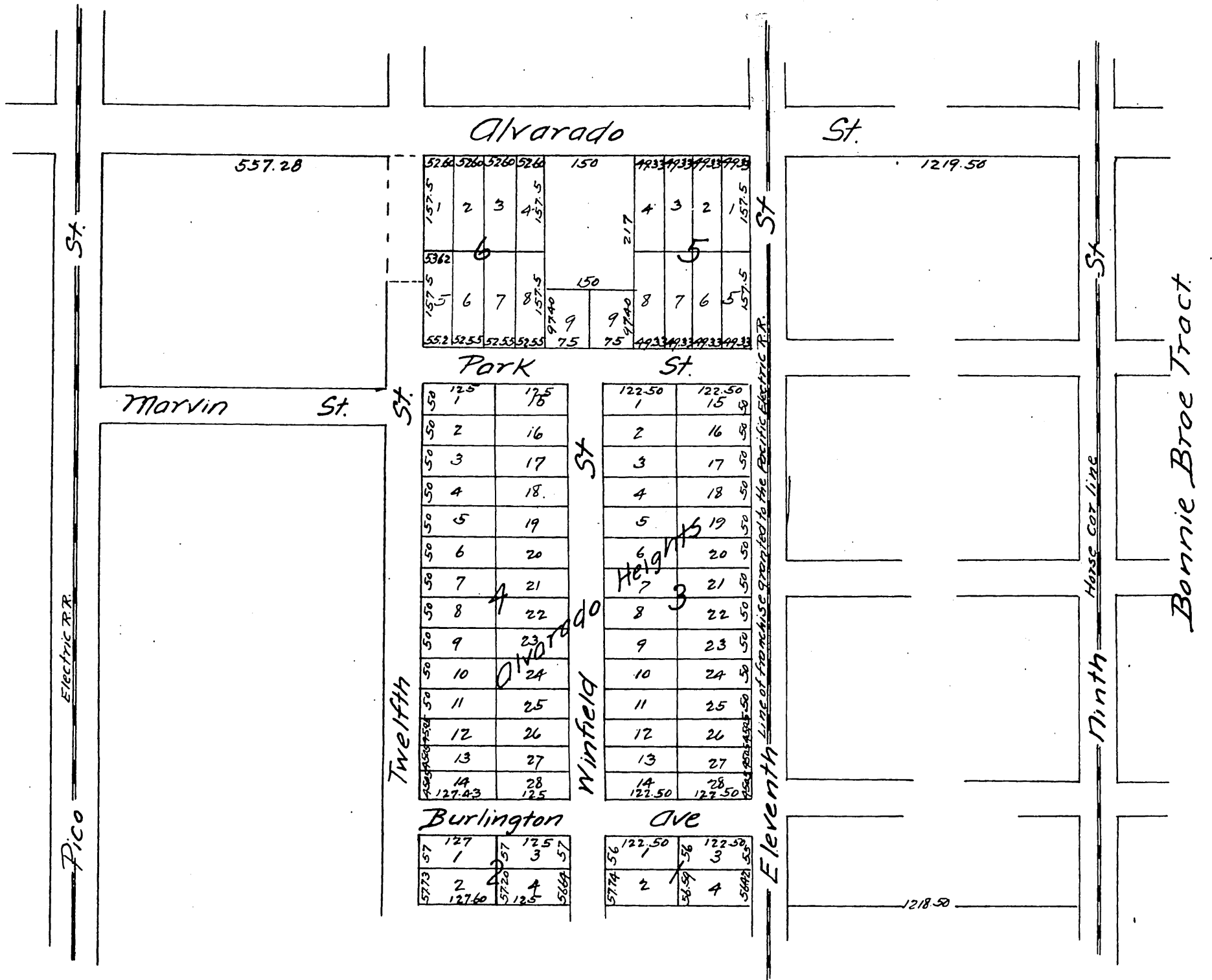

MAP
OF
Alvarado Heights.
Being a subdivision of the North one half of
Lot 5, Blk 36 Hancock's Survey of Donation Lots in
Los Angeles City Cal.
as surveyed by Buckner and Donaldson Sept 1887.



A full, true and correct copy of the original.
(reduced to the scale of 200 feet to one inch)
Recorded Nov 1, 1888 at 19 min past 3 P.M.
at request of C. E. Day
Frank G. Gibson County Recorder.
By George Bugbee Deputy.