

*Subdivision*  
*OF*  
*Section 25, T. 2 S. R. 15. W. S. B. M.*  
*being part of the*  
*Centinela and Sausal Redondo Ranchos*  
*Los Angeles Co. Calif.*

Oct. 18<sup>th</sup> 1888    Geo. Tod. Jr. Surveyor

Scale one inch = 300 feet.

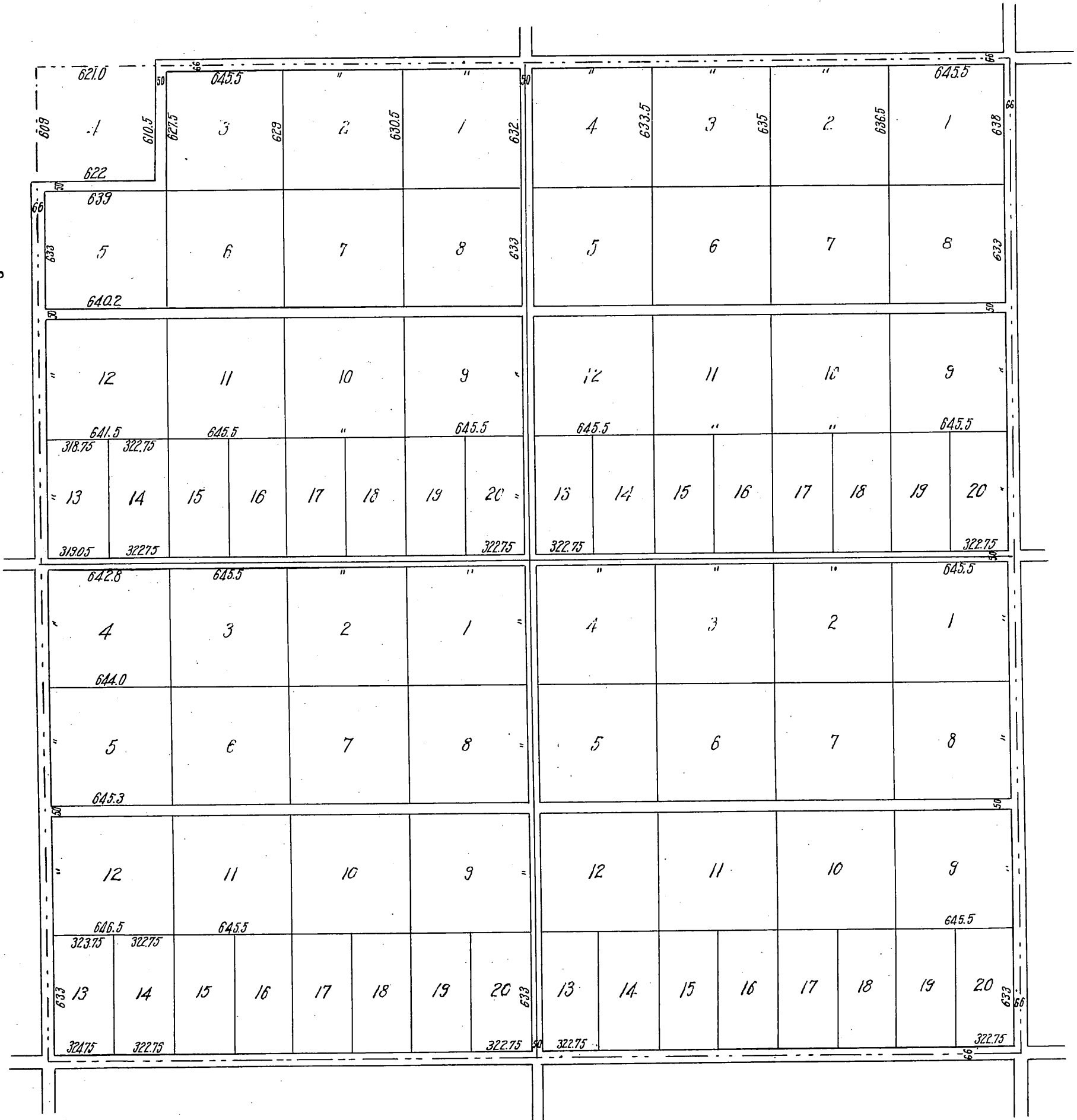

(Reduced to the scale of 600 feet to one inch)  
 Recorded Nov. 10. 1888  
 at request of E. J. Cox.

Vacation of roads See D:12-105  
 Arizona Ave. St. on east See D: 5716-32 D:19-66  
 Ballona Road changed to Nectarine St. - ord. 37755