

Replat of the Mountain View Tract

as recorded in book 21, page 77 of Miscellaneous Records of
Los Angeles Co, Cal

Surveyed by James E. Place C.E.
Scale 120 feet to 1 inch. J.O. Marsh Draughtsman.

For vac. of Banbury St. Pasqual Ave, Chapman St. see II: 8-25 and 88.

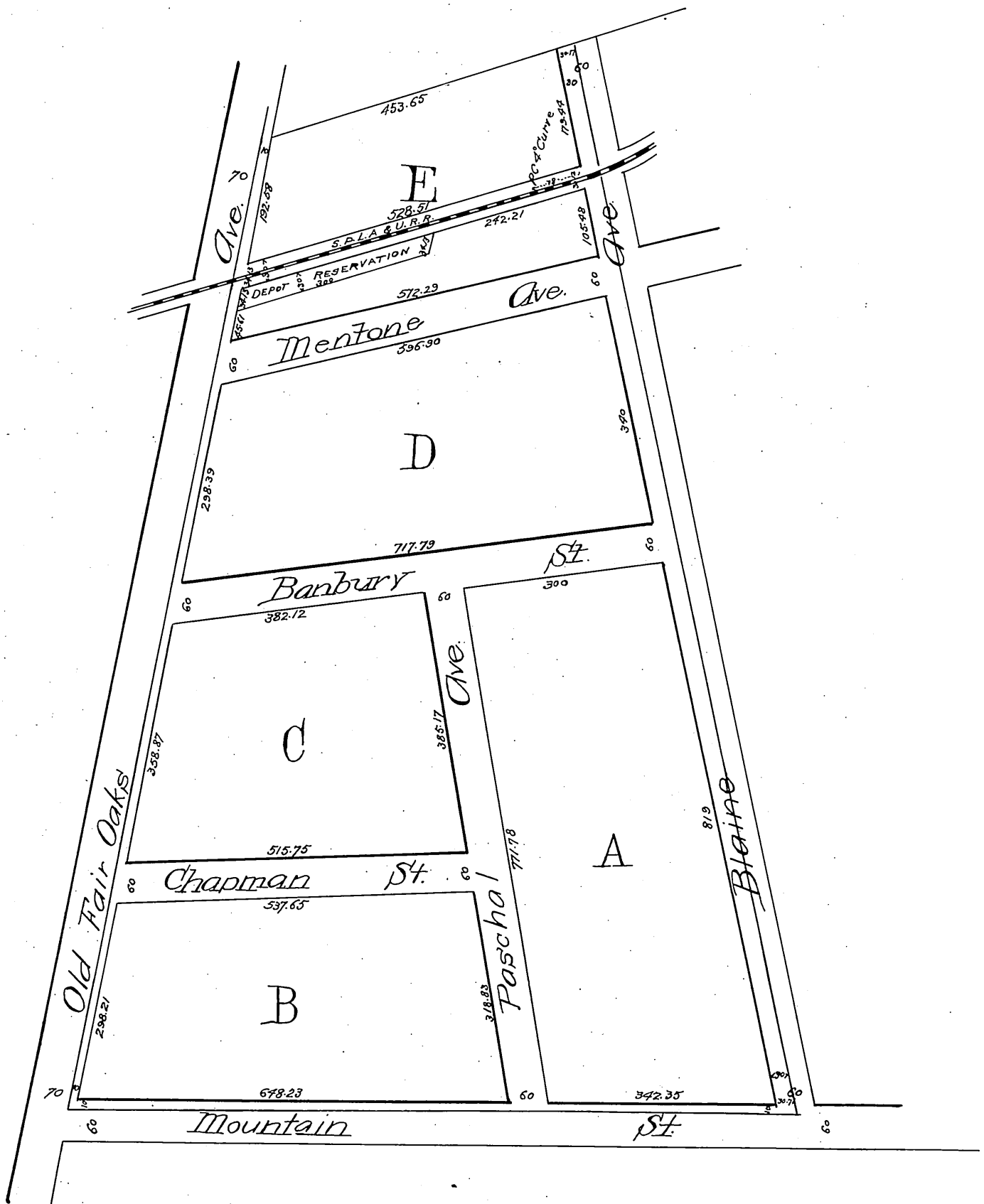

(Reduced to the scale of 200 feet to one inch)
Recorded February 12, 1889 at request of
S. Chapman.

James E. Place