

Ocean View Tract

A. H. Pickering's Subdivision of Lots 2, B & 4, Block 1,
of the Pickering Land and Water Company's
Subdivision of the John M. Thomas Ranch.
Los Angeles County, Cal.

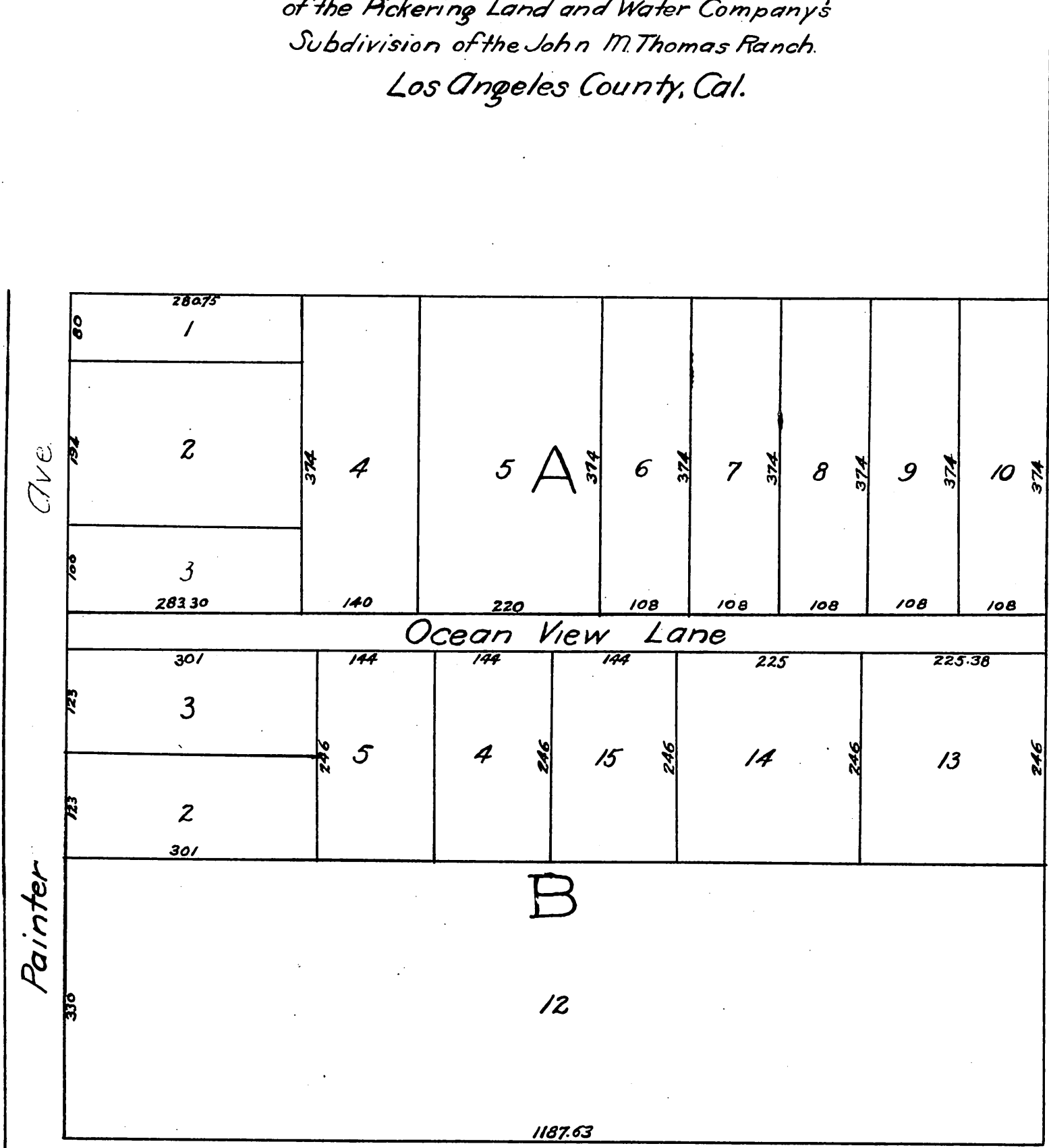

A full, true and correct copy of the original
(reduced to the scale of 150 feet to one inch)
recorded March 30, 1889 at 45 min past 9
A.M. at request of A. H. Pickering
John C. Francis County Recorder.
By George Hughes Deputy.