

REPLAT
of a portion of the
Town of San Dimas
Los Angeles County, Cal.
as per map recorded in Book 16 pp 53 and 54
Miscellaneous Records of Los Angeles Co.

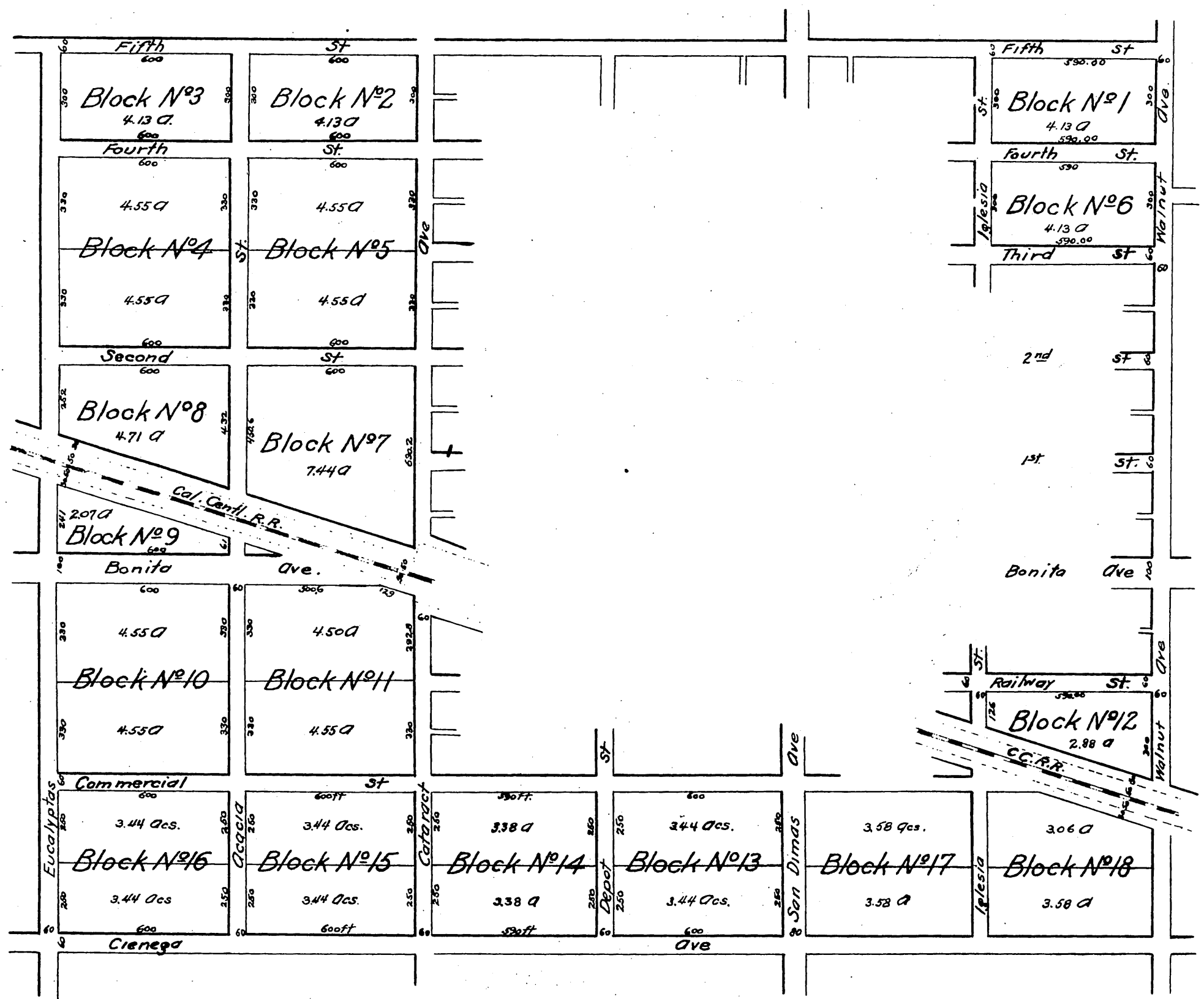

A full, true and correct copy of the original
(reduced to the scale of 400 feet to one inch)
recorded April 9, 1889 at 30 min past 3 P.M.
at request of M. L. Wicks.
John W. Francis County Recorder
By George Dugbey Deputy.