

North Pasadena Tract

A subdivision of that part of Lot 29, Block A San Pascual Tract
marked J.H. Painter on the Pasadena map.

Scale 120 feet to 1 inch

(Reduced to the scale of 150 feet to one inch)

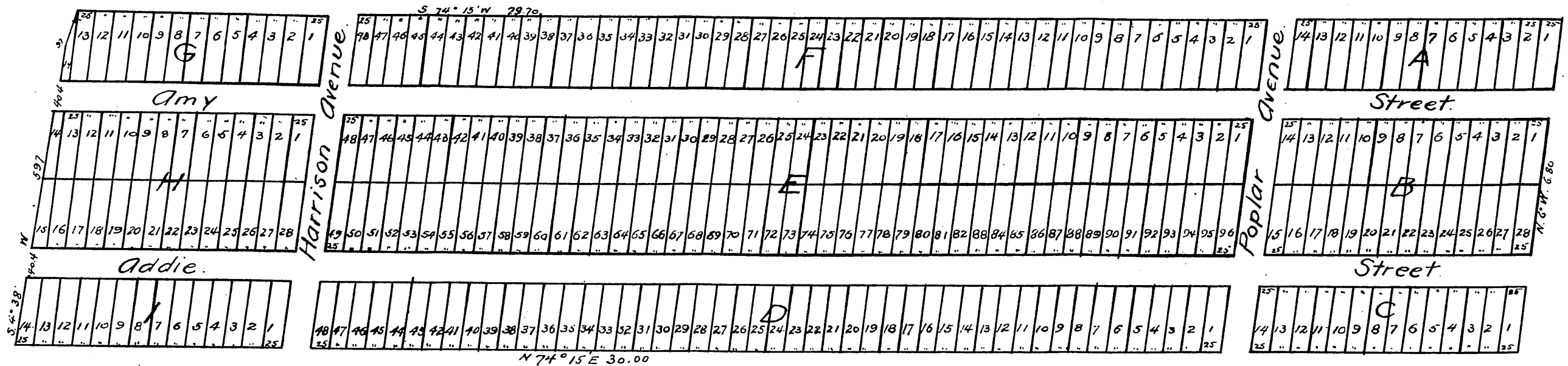

A full, true and correct copy of the original
recorded May 9, 1889 at 4 min past 4 P.M.
at request of C.S Taylor

John W. Francis, County Recorder,
By George Dugbey, Deputy.