

MAP

showing Relocation of Route for

MAIN SEWER

between Stations 12+24 and 38+74.7

of the

City of Pasadena, Cal

through lands belonging to Emmons Raymond
and the Raymond Improvement Company

May 1889 Aug Meyer Engr.

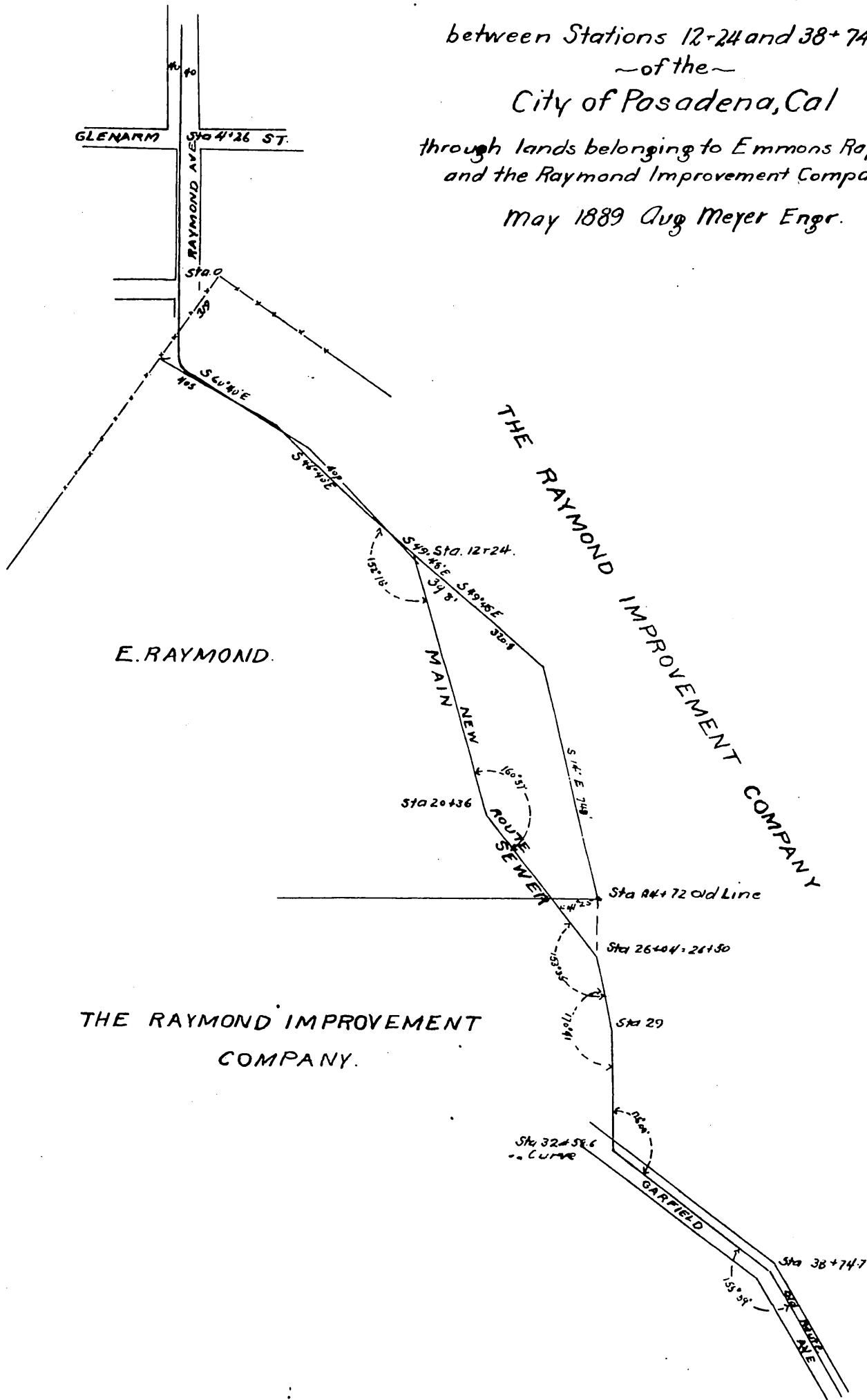

THE RAYMOND IMPROVEMENT
COMPANY.

A full, true and correct copy of the original
recorded Sep. 28, 1889 at 51 min past 8 O. M.
at request of F. J. Falley

John W. Francis County Recorder
By George Dugbee Deputy