



PLAT

SHOWING

Dr. Hagan's Subdivision

of Lots 1, 2, 3, 4, 5, 6, of Block "D" and Lots 1, 2, 3, 4, 5, 6 of Block "C" of the "Lake Shore Tract"

map thereof being recorded in book 13 on page 29 of the Miscellaneous Records of Los Angeles County

F. D. Lanterman

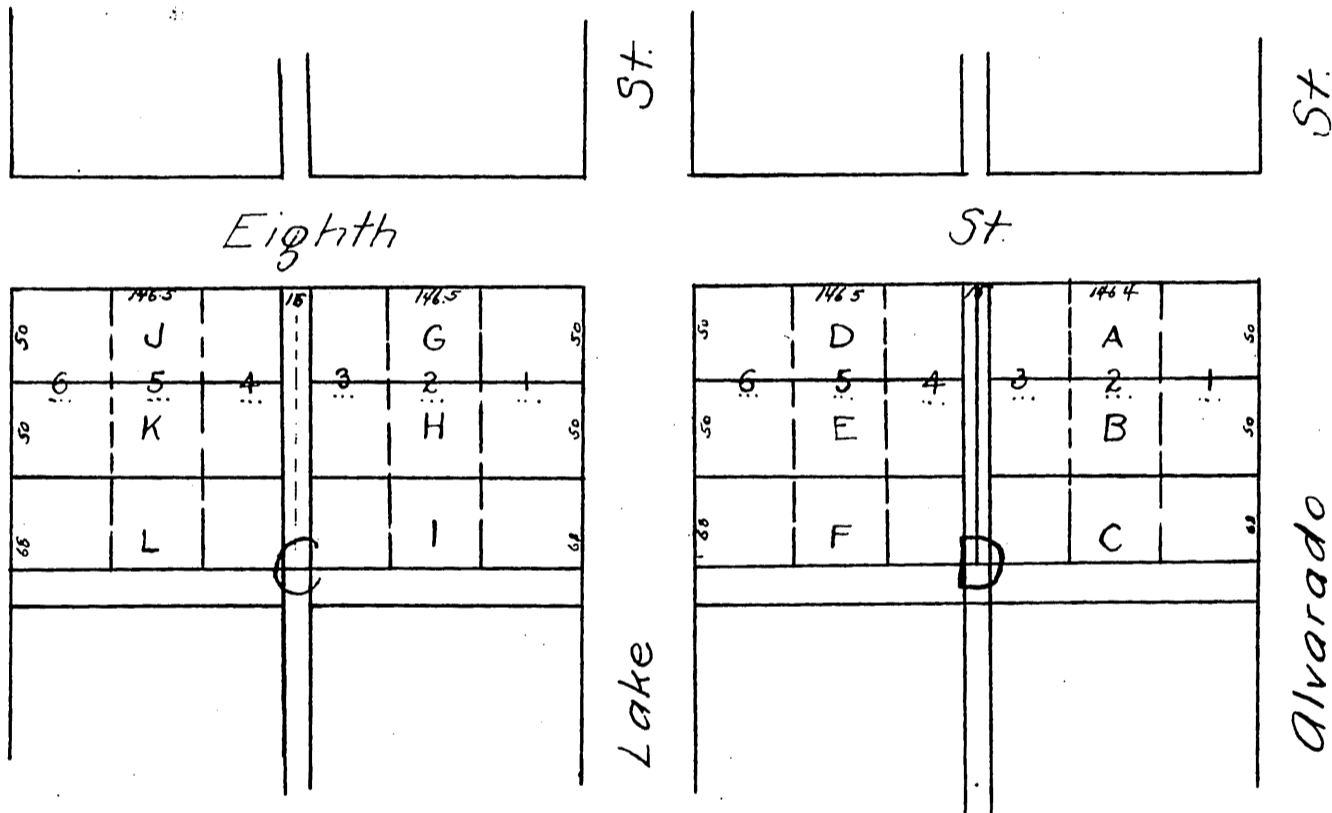

Note: Dotted lines and underlined figures show old survey.

Note: The alley showing in this plat as part of lots C, F, I, L, was vacated by City Council by ordinance No 397.

A full, true and correct copy of the original (reduced to the scale of 100 feet to one inch) recorded Oct. 16, 1889 at 2 min past 1 P. M. at request of Dr. M. Hagan.

John W. Francis, County Recorder.
By: George Bugbee Deputy.