

J. W. Beebe's Re-subdivision

OF

Lots 26, 28, 30, 32, 34, 36 and 38 of Barclay's Subdivision
of the Gilmore Vineyard Tract Pasadena, Los
Angeles County, California

For map of Barclay's Subdivision
see Book of Miscellaneous Records 5 at Page 522

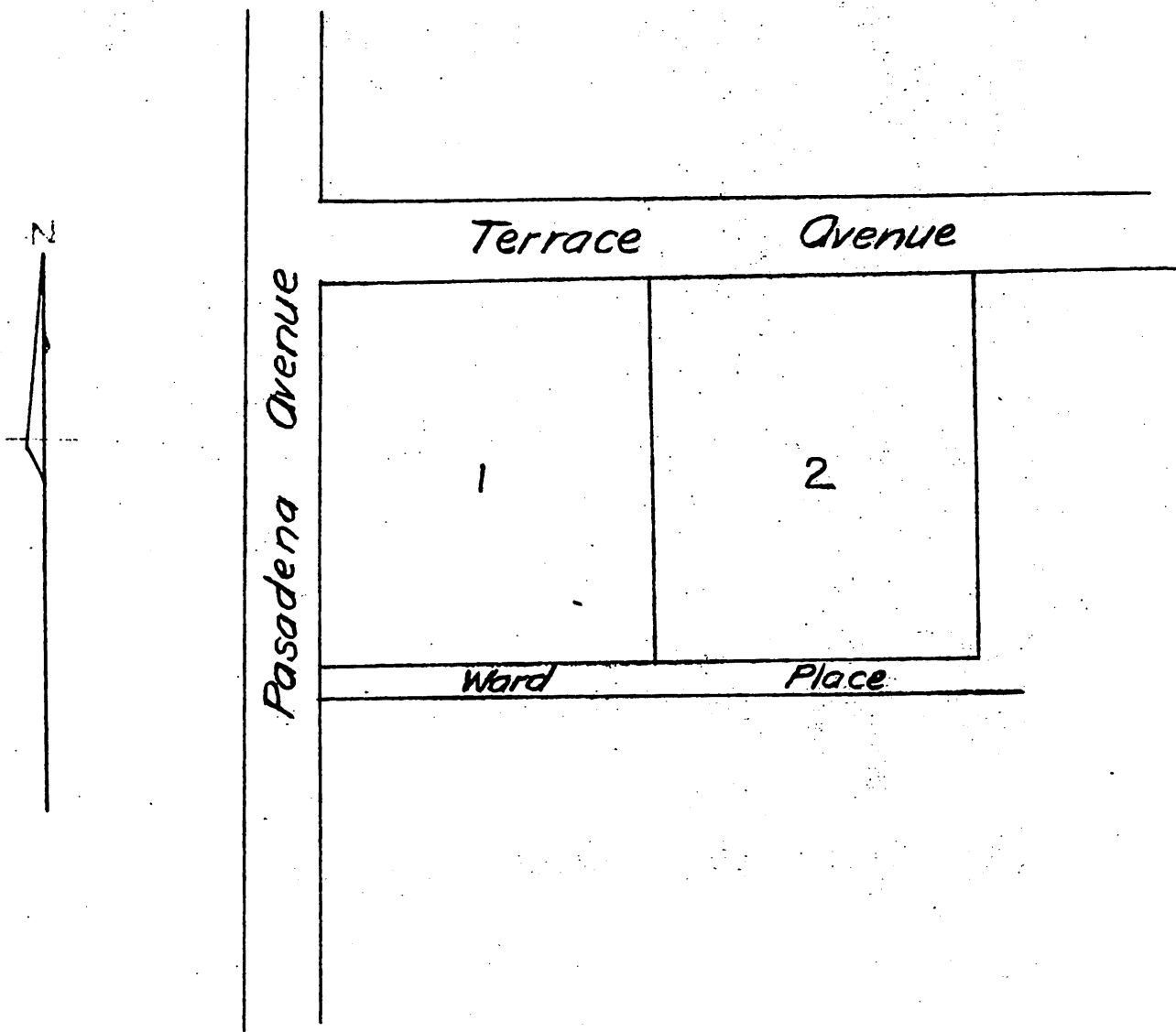

A full, true and correct copy of the original
recorded Mar 20 1890 at 45 min past 11 am
at request of J. W. Beebe
John W. Francis County Recorder
By George Bugbee Deputy