

REPLAT
of Lots 7, 8, 9, 10 & 11 of
G. Roscoe Thomas Subdivision
as recorded in Book 15, Page 53 Misc'l records
of Los Angeles Co. Cal.

Scale 60^{ft} to 1 inch

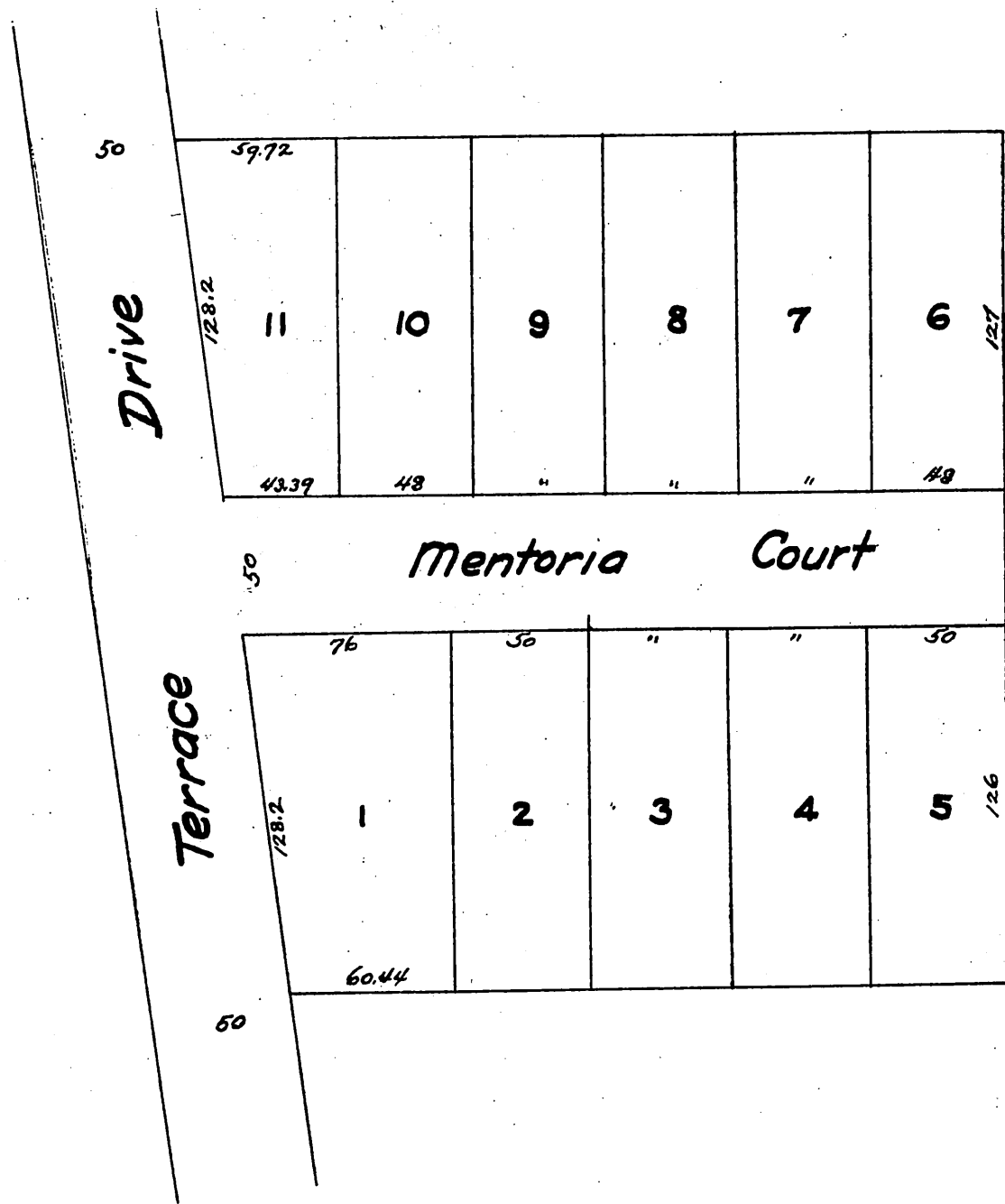

A full, true and correct copy of the original
recorded March 27, 1890 at 35 min past 3 P.M.
at request of G. Roscoe Thomas
John W. Francis County Recorder
By George Bugbee Deputy.