

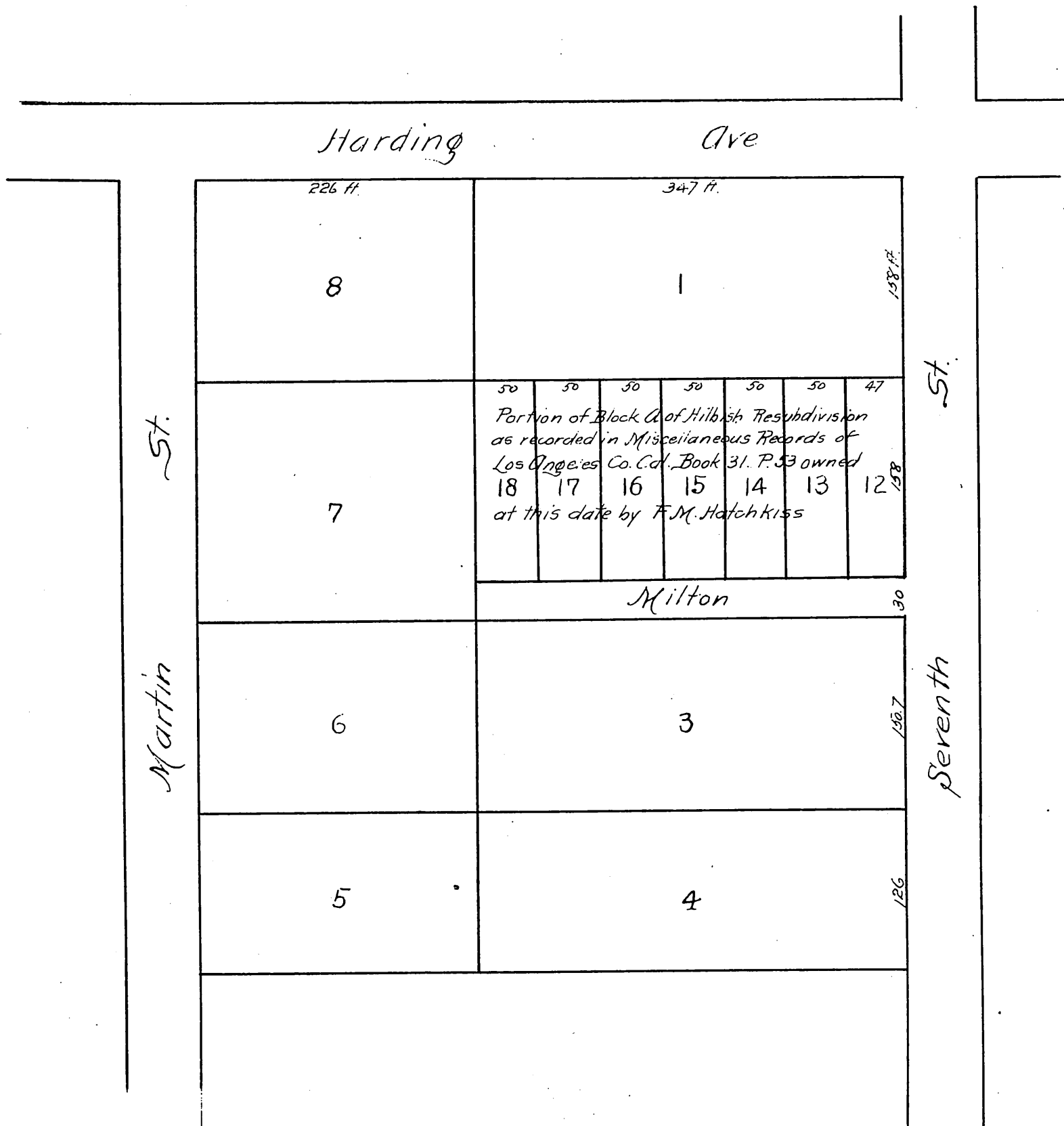

# MAP OF Hilbish Division

of the North 8<sup>00</sup>/<sub>100</sub> acres of Block 128 of the  
MacLay Rancho ex-Mission de San Fernando  
resubdivided in accordance with a resolution  
of the Board of Supervisors of Los Angeles County  
California passed Aug 15, 1890.



A full, true and correct copy of the original  
(reduced to the scale of 100 feet to one inch)  
recorded Aug 19, 1890 at 9 min past 12 M  
at request of J.M. Hilbish.  
John W. Francis, County Recorder.  
By George Augbee Deputy.