

4033

MAP

showing South 40 Acres of the Central Park Tract
after restoring same to acreage, by order of the Board of
Supervisors Dec 15th 1890, being Blocks C, D, E, F, L and M, as
shown on Map recorded in Vol. 21 Pages 1 and 2 Mis. Rec.

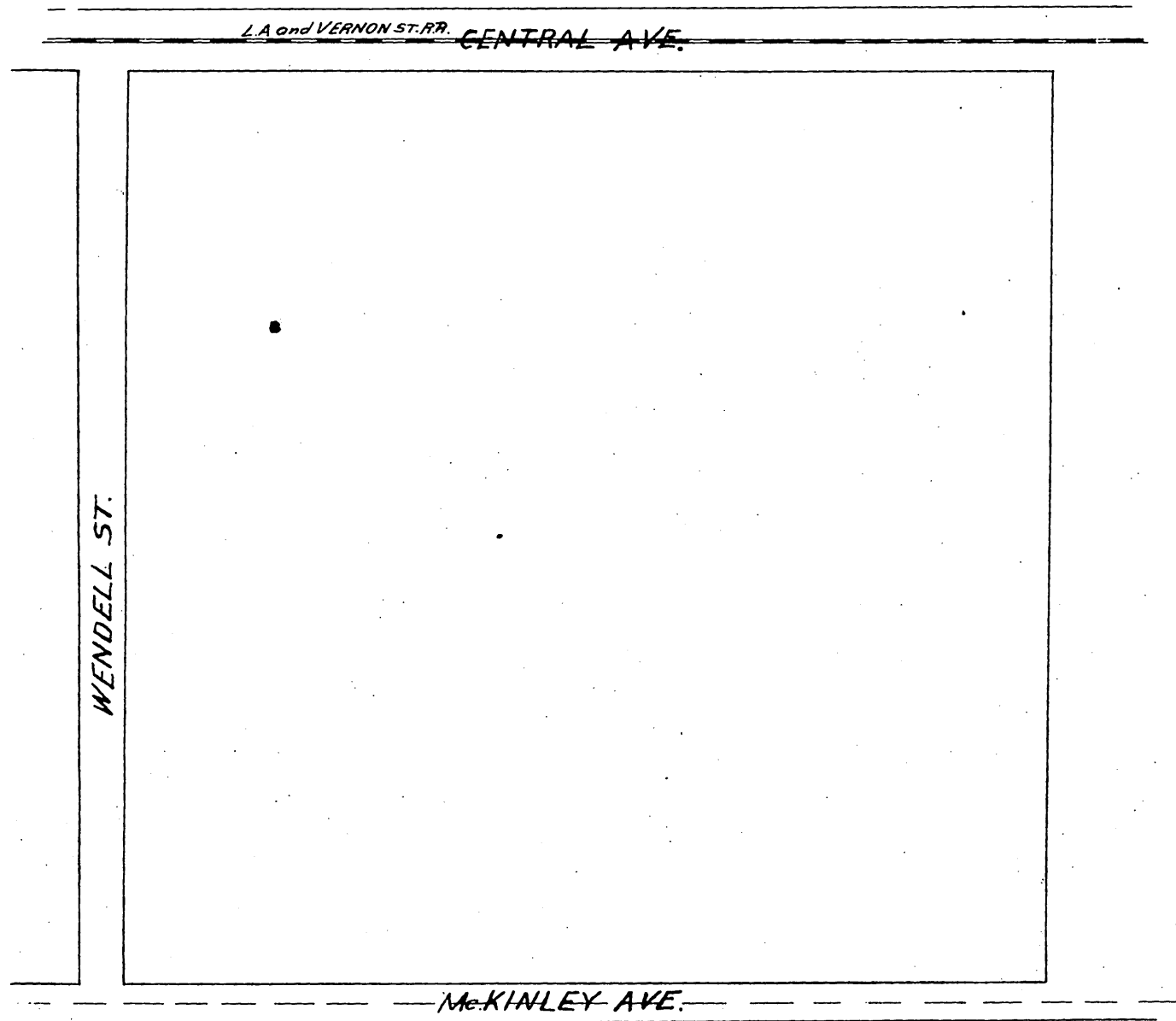

A full true and correct Copy of the Original
(Scale reduced one half) Recorded Dec 17 1890
at 35 min. past 9 A.M. at request of E. F. Kysor.
C. W. Francis County Recorder.
By Wm W. Mills Deputy.