

# Map of Resurvey EULALIE TRACT

COUNTY OF LOS ANGELES, STATE OF CALIFORNIA  
Showing land after abandonment of streets by the Board of Super-  
visors, County of Los Angeles, State of California, at a public hearing  
Minute Book No. 3 at page 45 April 27th 1891

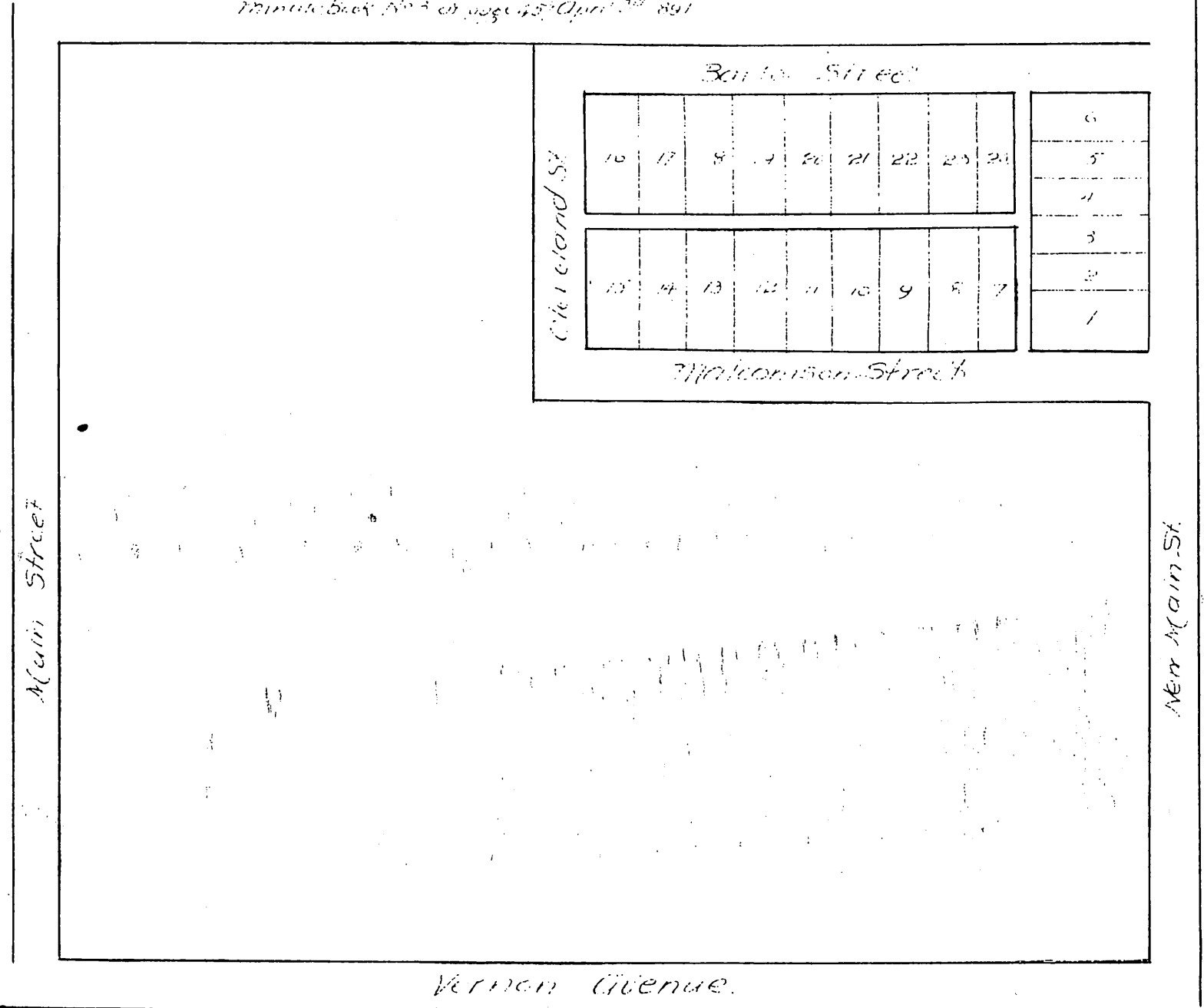

A full true and correct copy of the Original  
Recorded April 10 1891 at 3:55 p.m. and 2 p.m.  
at request of Nicholas Barlow  
J. C. Keller, County Recorder  
By R. B. Mills, Deputy.