

Re Plat
 of part of Arcadia.
 as shown on Map Book 16 page
 58 Miscellaneous Records in
 this office: as ordered by
 Board of Supervisors June
 23rd 1891.

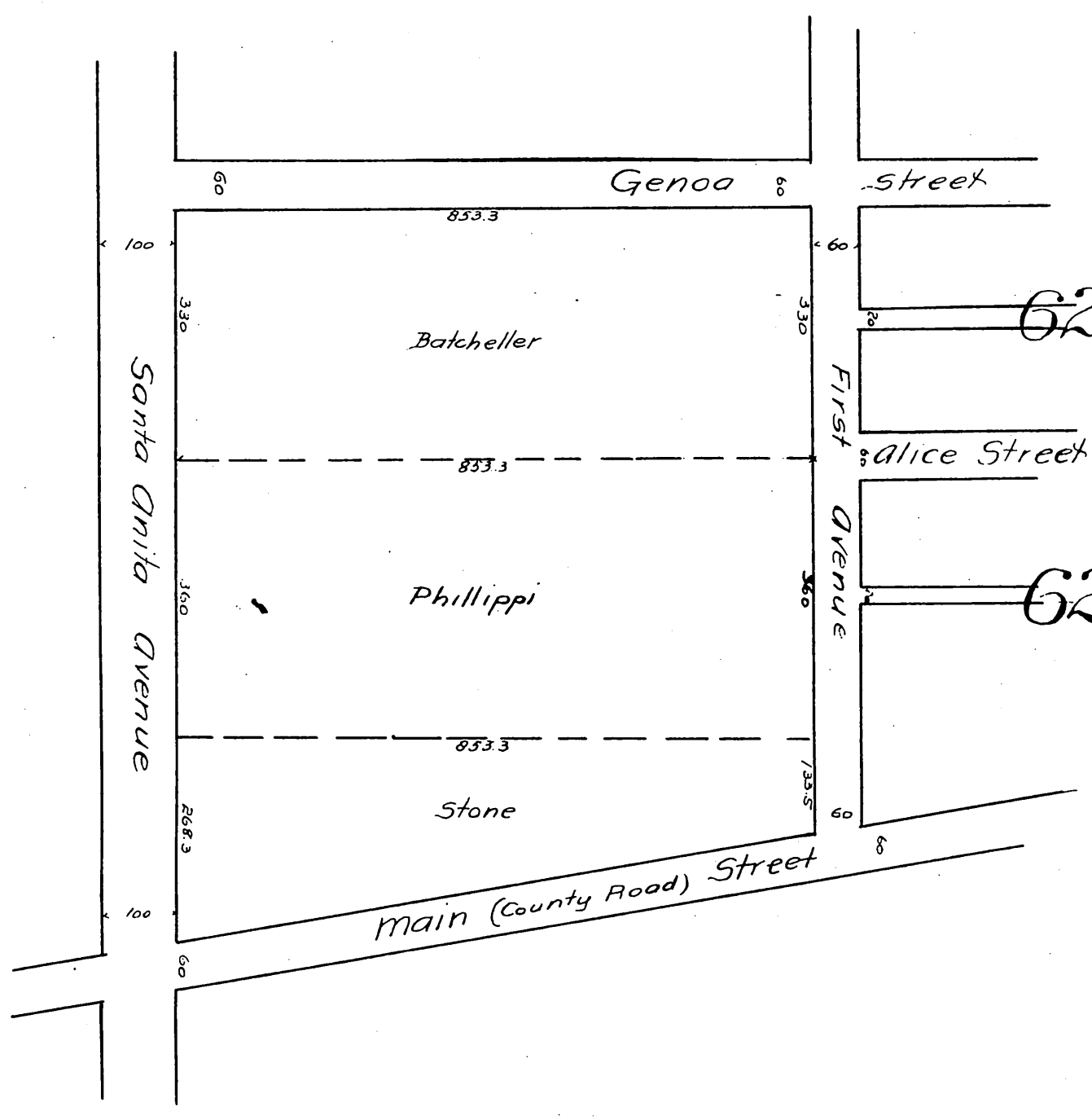

Note: The numbers "62" and "62 1/2" indicate block numbers. The other numbers indicate feet and tenths of feet.

A full, true, and correct copy of Original.
 recorded Jun 30, 1891 at 15 min past 12 M.
 at request of Petitioners.
 J. A. Kelly County Recorder
 By W. W. Mills Deputy