

Map of part of Altadena, Los Angeles County, California, showing that part of Mendocino Street which was Vacated by order of the Board of Supervisors of said County dated Sep 29, 1891, being all of Mendocino St between the east line of Santa Rosa Ave and the west line of Santa Clara Ave and indicated on the map by dotted redlines

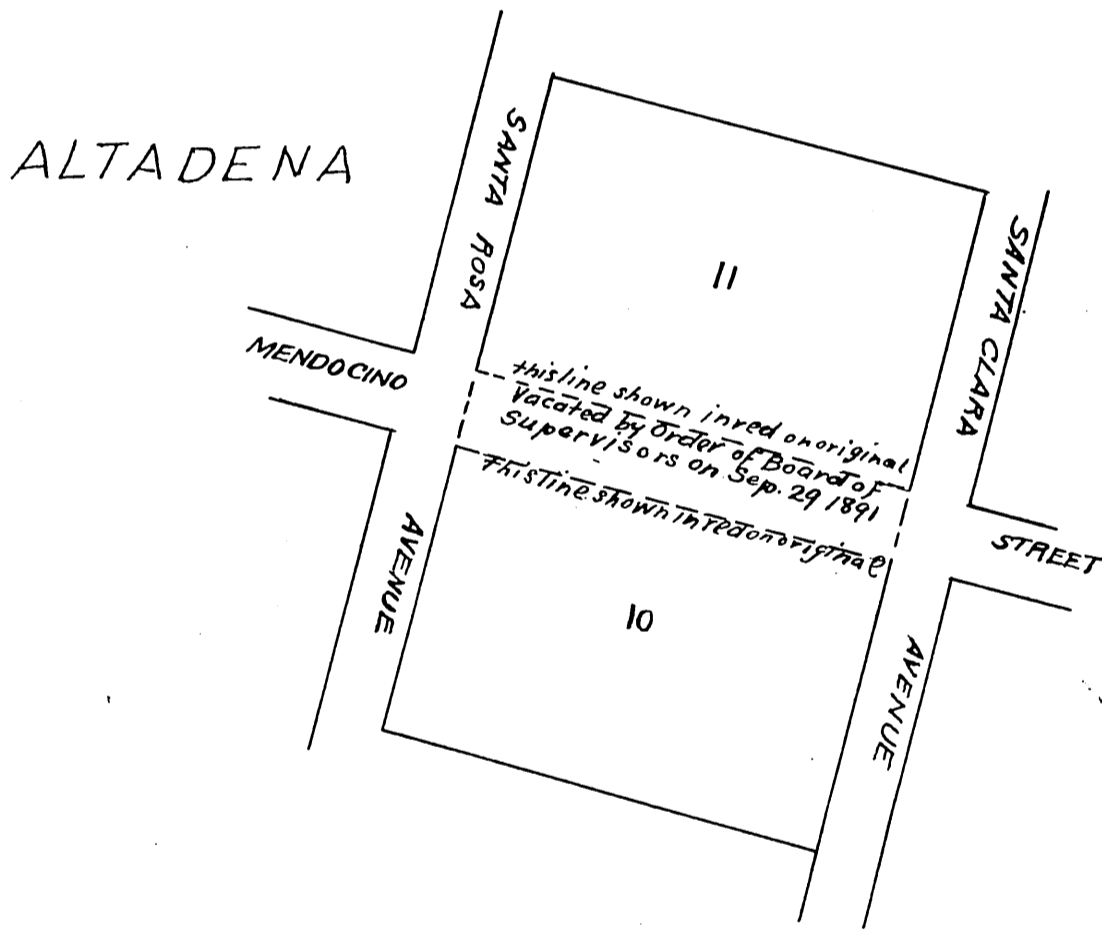

A full, true and correct copy of original recorded Oct 14, 1891 at 15 min past 2 pm at request of Anderson, Melcalfe + Anderson
 J. A. Kelly County Recorder
 By W. W. Mill Deputy