

44

A SUBDIVISION  
OF  
BRADBURY'S ADDITION  
to the City of Monrovia  
Los Angeles County, California

SCALE 1 INCH  
= 200 FEET.

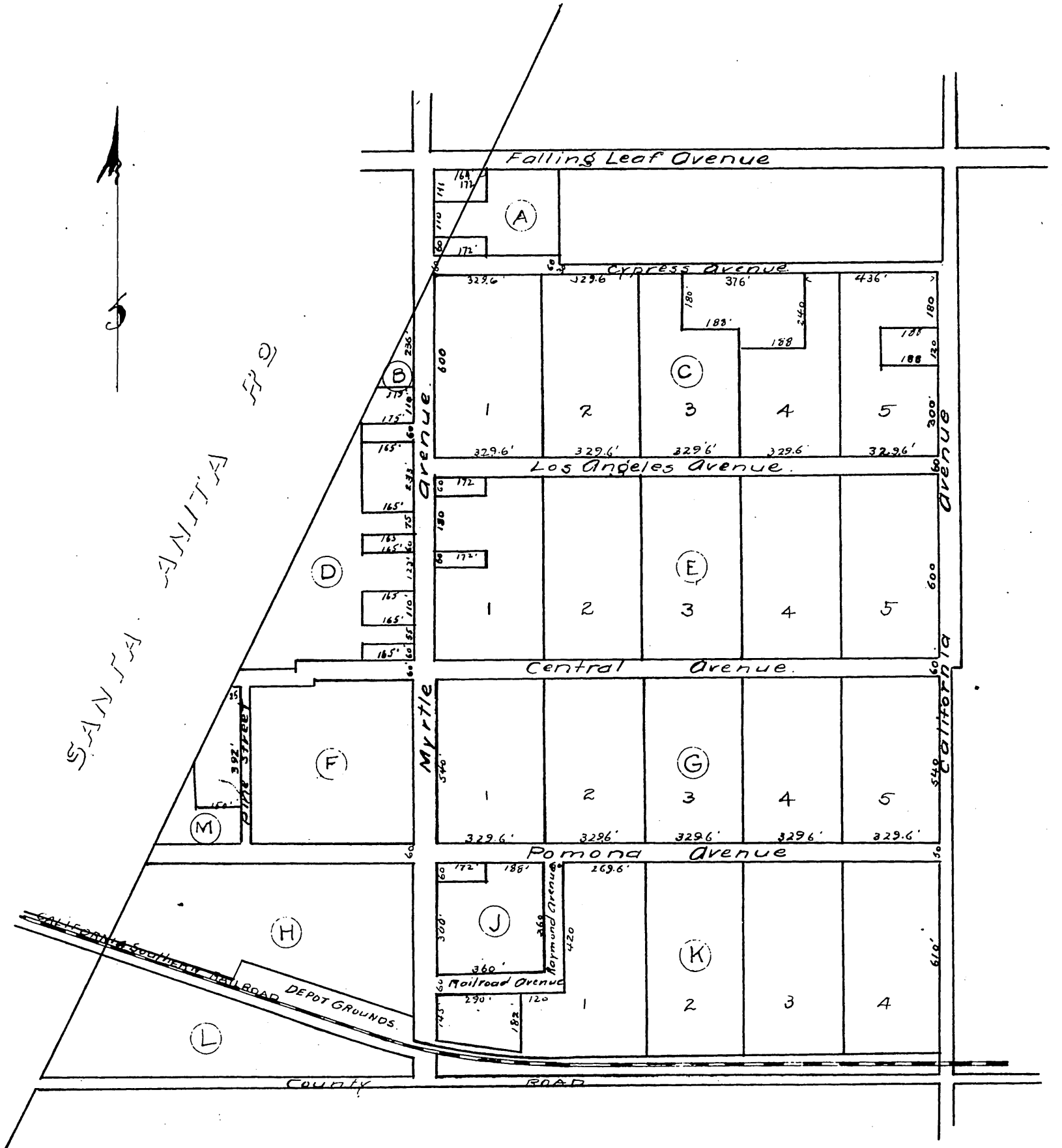

A full, true, and correct copy of original.  
(scale reduced to 400 feet to one inch)  
recorded Mar. 4 1892 at 12 M. at request  
of L. L. Bradbury

J. C. Kelly County Recorder.  
By H. H. Milla Deputy.