

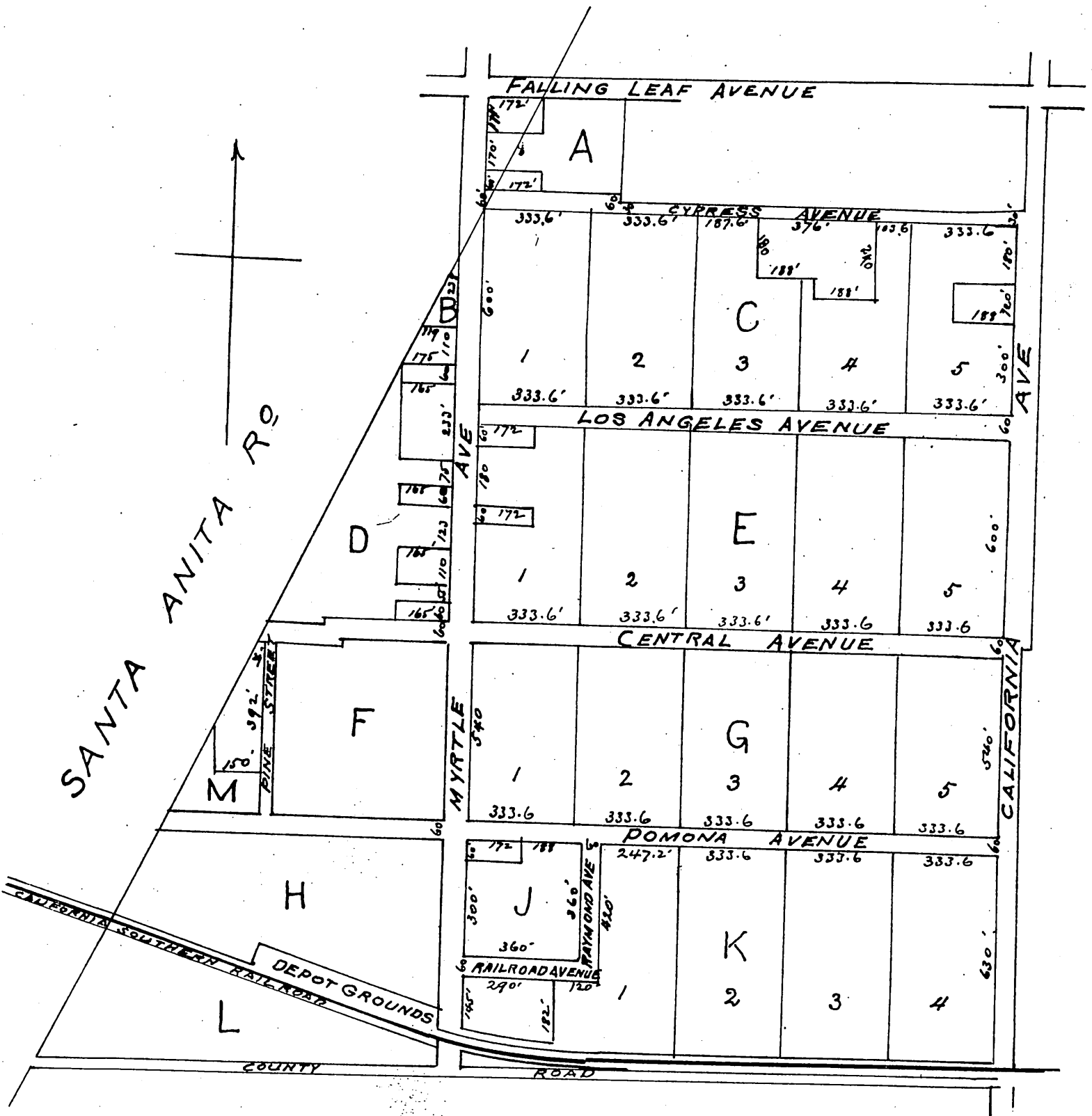

A SUBDIVISION  
 OF  
 BRADBURY'S ADDITION  
 TO THE CITY OF  
 MONROVIA  
 Los Angeles County  
 California

Scale 1 inch = 200 feet



A full true and correct copy of original  
 (scale reduced to 400 feet to one inch)  
 recorded May 20 1892 at 10 min past 10 am  
 at request of L L Bradbury  
 J A Kelly County Recorder  
 By W W Mills Deputy