

NE Cor Lot 4. B27 HS

82.50

S. 26° 43' W 1223.62

BELLEVUE AVE

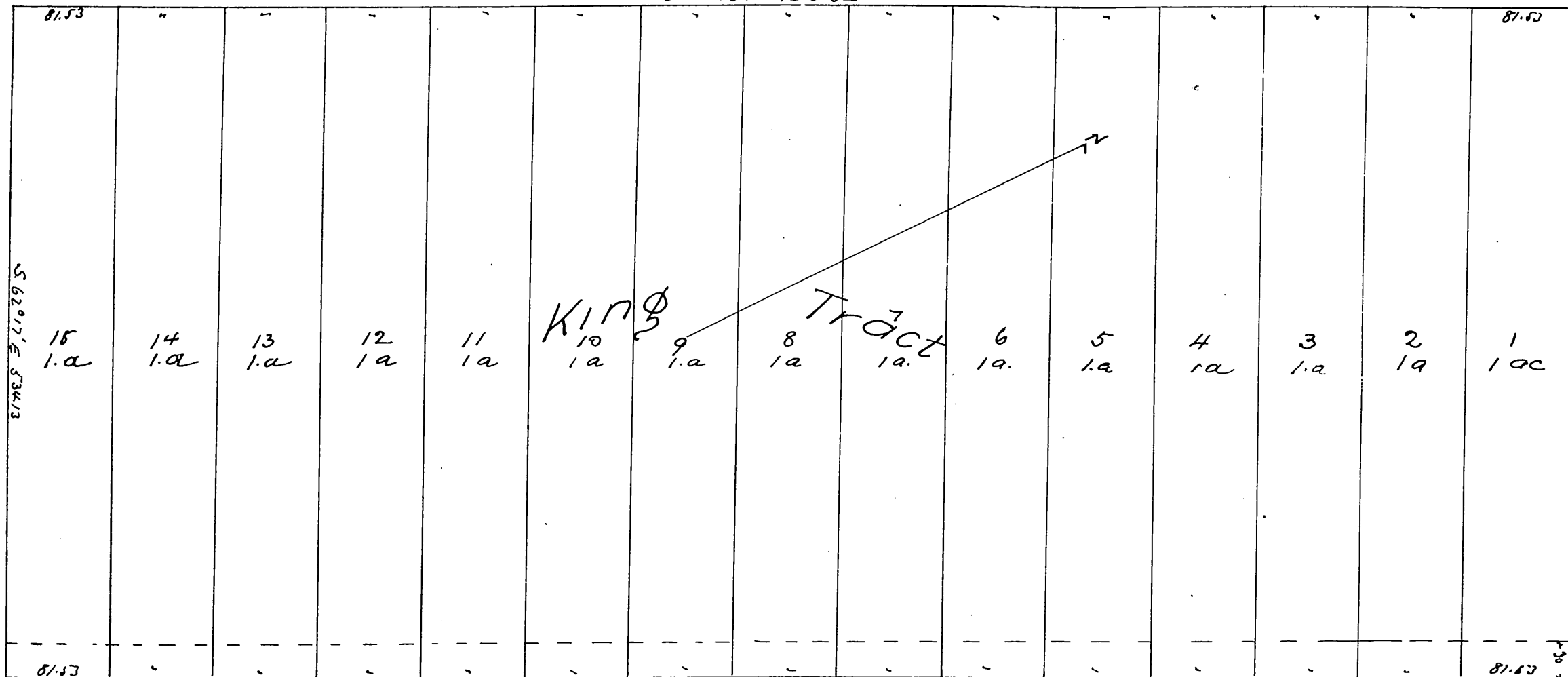

N.W. Cor Lot 6 B28 HS

KING ST

N 26° 43' E 1223.62

82.00

BRYAN

SUBDIVISION

PLAT OF
THE PROPERTY OF
Fitzroy A. King

Being a subdivision of the west
15 acres of Lot 6, B. 28 Hancock's
Survey, Los Angeles Cal. Surveyed
by F. B. Cook April 1891
Scale 100' = 1"

A full true and correct copy of original
recorded Jun 15 1892 at 5:11 PM past 12 M
at request of F. A. King
J. A. Kelly County Recorder
by W. W. Mills Deputy.