

Map of that part of the Schmidt Addition to Los Angeles, California, in which Ward Street and Edward, Frederick, and Copenhagen Avenues were vacated and abandoned by act of The Board of Supervisors of Los Angeles County, California, on the 28<sup>th</sup> day of Sept. 1892; being the S<sup>1</sup>/<sub>2</sub> of the E<sup>1</sup>/<sub>2</sub> of the S E<sup>1</sup>/<sub>4</sub> of Sec. 24 T. 1 S. R. 14 W S. B. M. Containing 40 acres of land, including highways adjacent thereto.

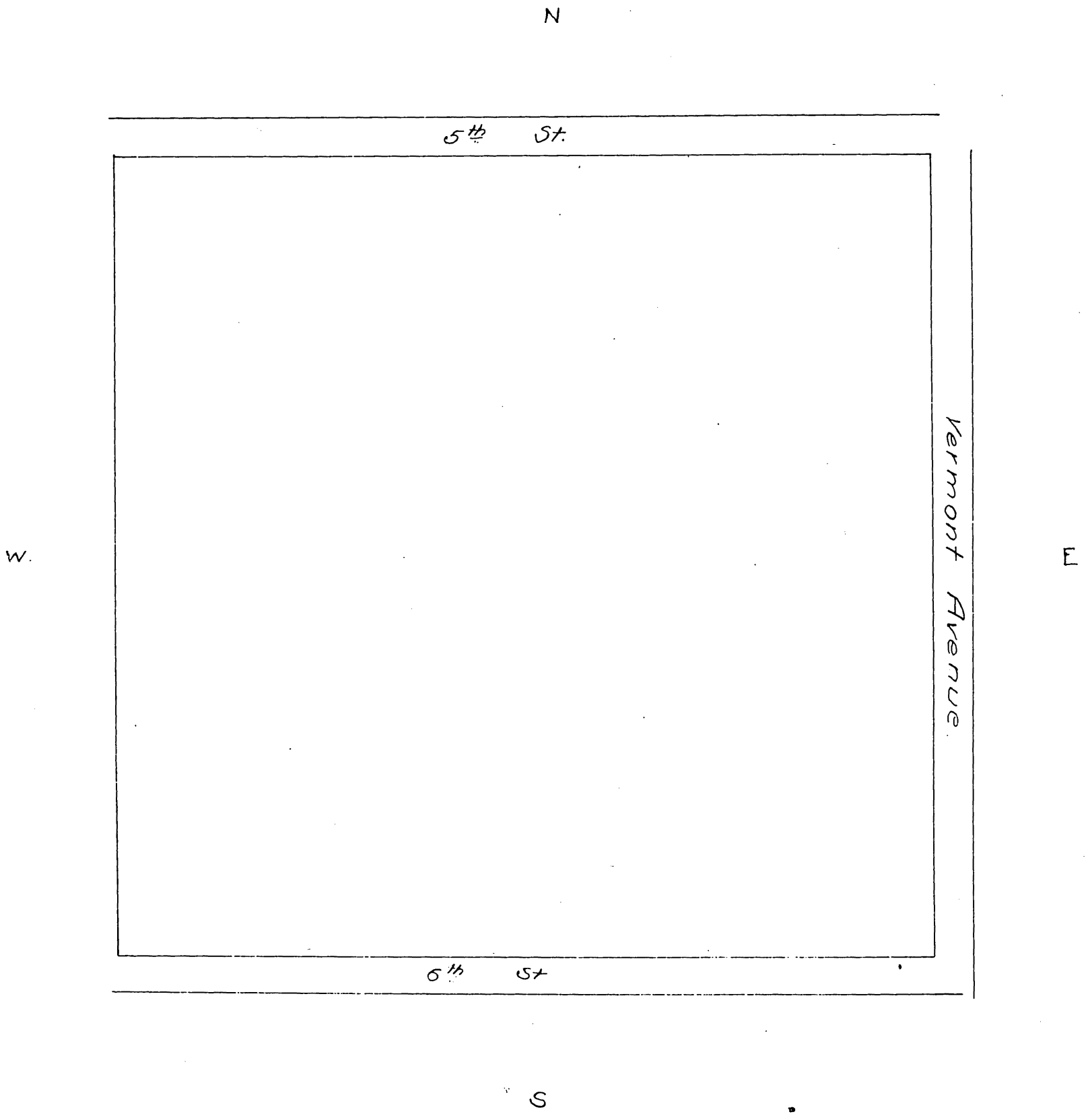

A full, true and correct copy of original recorded Sep. 28 1892 at 40 min past 2 P.M. at request of Edward Schmidt.  
 J. A. Kelly County Recorder.  
 By Wm. Miller Deputy