

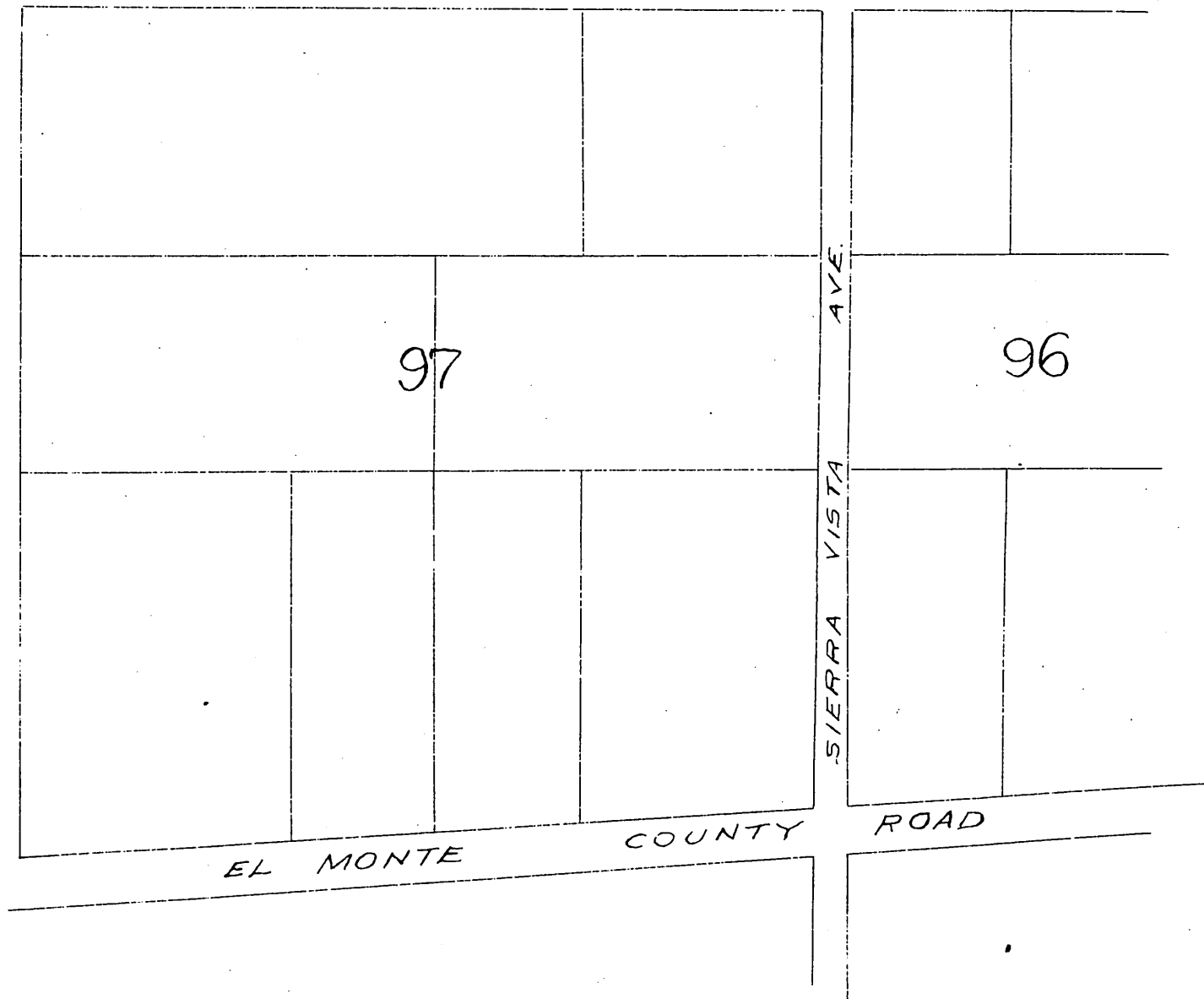

Map

showing that part of Sierra Vista Avenue lying north of the El Monte County Road, in the Townsite of Ramona; for a more particular description of which, reference is had to a map of said Ramona, of record in the office of the County Recorder of said County of Los Angeles in Book 16 of Miscellaneous Records pages 79 80 81 82 83 84 85 86.



MINUTES OF THE BOARD OF SUPERVISORS  
ROAD BOOK 4 PAGE 238

Thursday, March 9<sup>th</sup> 1893.

Board met pursuant to adjournment Present - Supervisors Cook, Forrester, Francisco, Hay and Hanley and the Clerk.

Page 240  
IN RE VACATION OF  
SIERRA VISTA AVE  
RAMONA

This matter having been regularly set for hearing at this time and due notice thereof having been given and no objection having been filed, the petition was read; J. DeBarth, who has sworn and testified and, on motion of Supervisor Forrester, duly carried. Ordered that the Petition be granted as follows: that that portion of Sierra Vista Street lying north of the El Monte Road in the Townsite of Ramona, as shown by Map No 2 of Ramona, be vacated conditioned upon the petitioners filing with the County Recorder a map showing such reversion.

STATE OF CALIFORNIA }  
COUNTY OF LOS ANGELES } ss. I, T. H. Ward, County Clerk and ex-officio Clerk of the Board of Supervisors of Los Angeles County do hereby certify the foregoing to be a full, true and correct copy of the original minutes of the Board of Supervisors, "in the Vacation of Sierra Vista Ave. Ramona," as appear in Road Book 4, page 240, on file in my office, and that I have carefully compared the same with the original. In Witness Whereof, I have hereunto set my hand and affixed the seal of the Board of Supervisors, this twenty-first day of March, 1893.

T. H. Ward  
County Clerk and  
ex-officio Clerk of the Board of Supervisors  
By J. E. Carse Deputy.

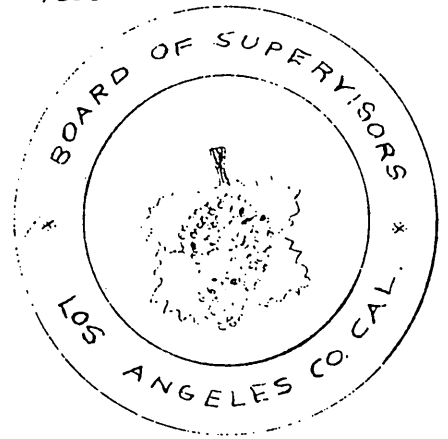

A full true and correct copy of original, recorded Apr 8 1893 at 18 min past 9 A.M. at request of J. S. Spawes  
Arthur Bray  
County Recorder.  
By W. W. Mills Deputy.