

MAP OF
 LOS ANGELES OLIVE GROWERS ASSOCIATION
 LANDS a part of the
 MACLAY RANCHO
 EX MISSION DE SAN FERNANDO
 Los Angeles County, California.

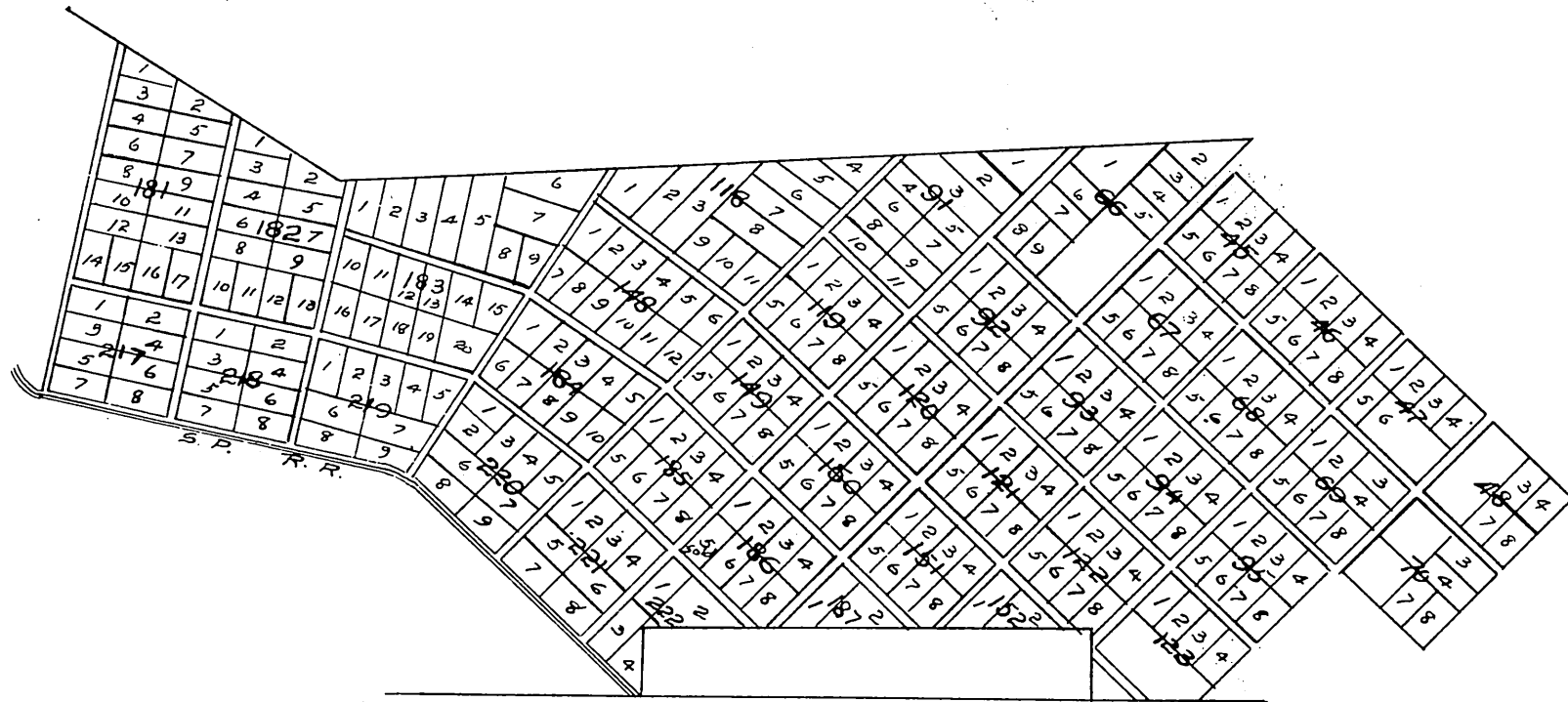

A full true and correct copy of original
 recorded May 8 1893 at 2 p.m. at request
 of D. O. Millimore.
 Arthur Bray
 County Recorder.
 By W. W. Mills Deputy.

