

# Map of A. C. SHAFERS RE-SUBDIVN.

of Lots 24 to 31 and Lots 60 to 63 and a Strip of Land lying along the north side of Lots 46 to 60 and 63 of the DAMAN and MILLARD TRACT in the City of Los Angeles State of California, as per map recorded in Book 23 page 39 miscellaneous records.

Common cor. Lots 1, 2 & 46 Misc. 23-39  
 100 Feet  
 28  
 27  
 26  
 25  
 24  
 23  
 22  
 21  
 20  
 19  
 18  
 17  
 16  
 15  
 14  
 13  
 12  
 11  
 10  
 9  
 8  
 7  
 6  
 5  
 4  
 3  
 2  
 1

South line of H. L. Flash's Main Street Subdivision Misc. 18 p. 95

Los Angeles Cal, Dec 9<sup>th</sup> 1893  
 I hereby certify and acknowledge that I am the owner of the land shown in this map, which map was made at my request and correctly represents my intentions  
 G. W. Tubbs.

STATE OF CALIFORNIA } ss.  
 COUNTY OF LOS ANGELES }

On this 9th day of December in the year of our Lord One thousand eight hundred and ninety three before me Theodore A. Simpson a Notary Public in and for said County of Los Angeles State of California, residing therein duly commissioned and sworn, personally appeared G. W. Tubbs, personally known to me to be the person, whose name is subscribed to the foregoing instrument, and he acknowledged to me that he executed the same. In Witness Whereof I have hereunto set my hand and affixed my official seal the day and year in this certificate first above written.



Theodore A. Simpson  
 Notary Public in and for Los Angeles County State of California.

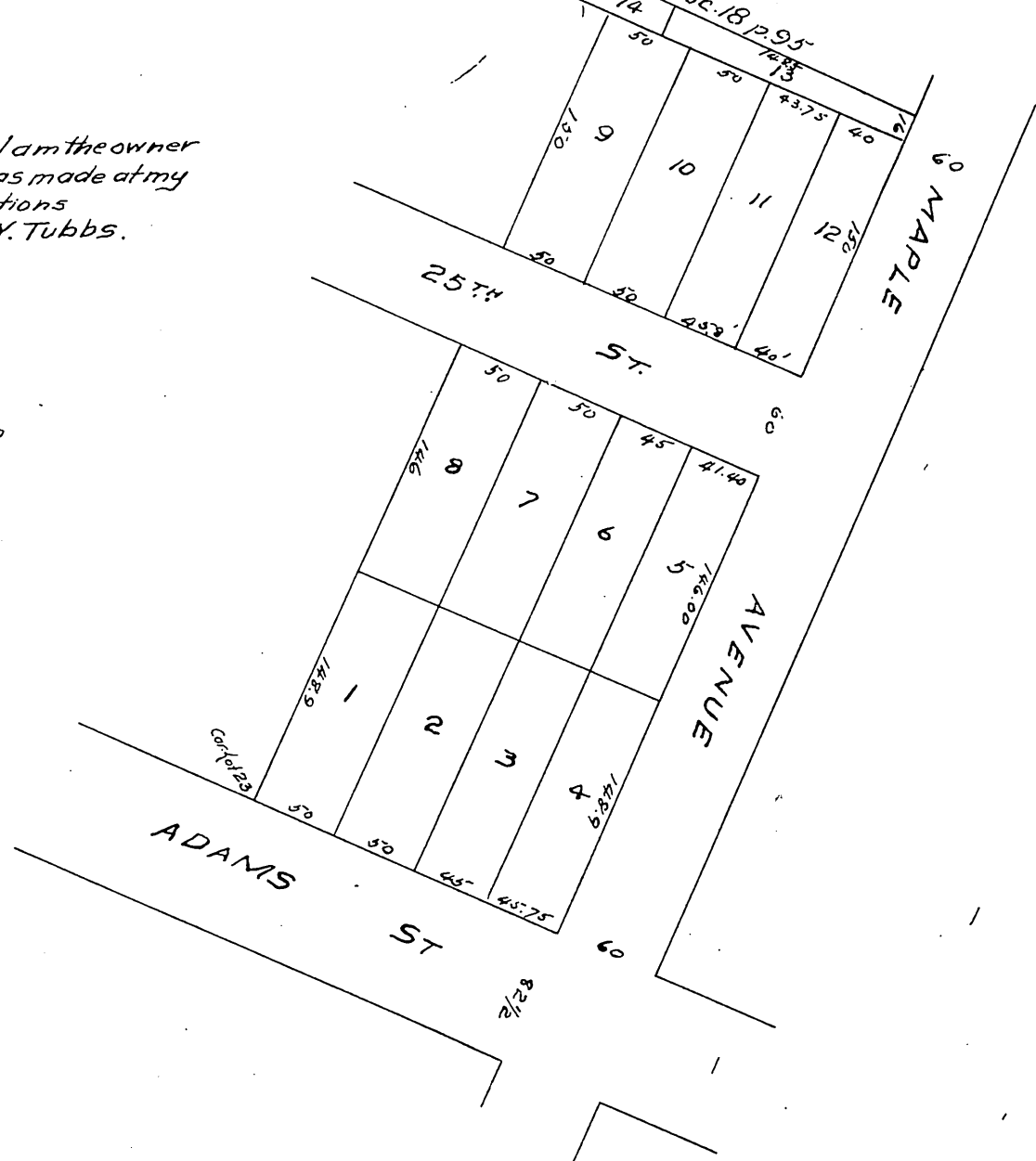

A full true and correct copy of original  
 Recorded Feb 6, 1894 at 16 min past 11 a.m.  
 at request of G. W. Tubbs Arthur Bray

By W. W. Mills  
 COUNTY RECORDER.  
 DEPUTY.

