

W. J. Fishers

re-subdivision of the Kohler & Frohling Tract

July 11/94

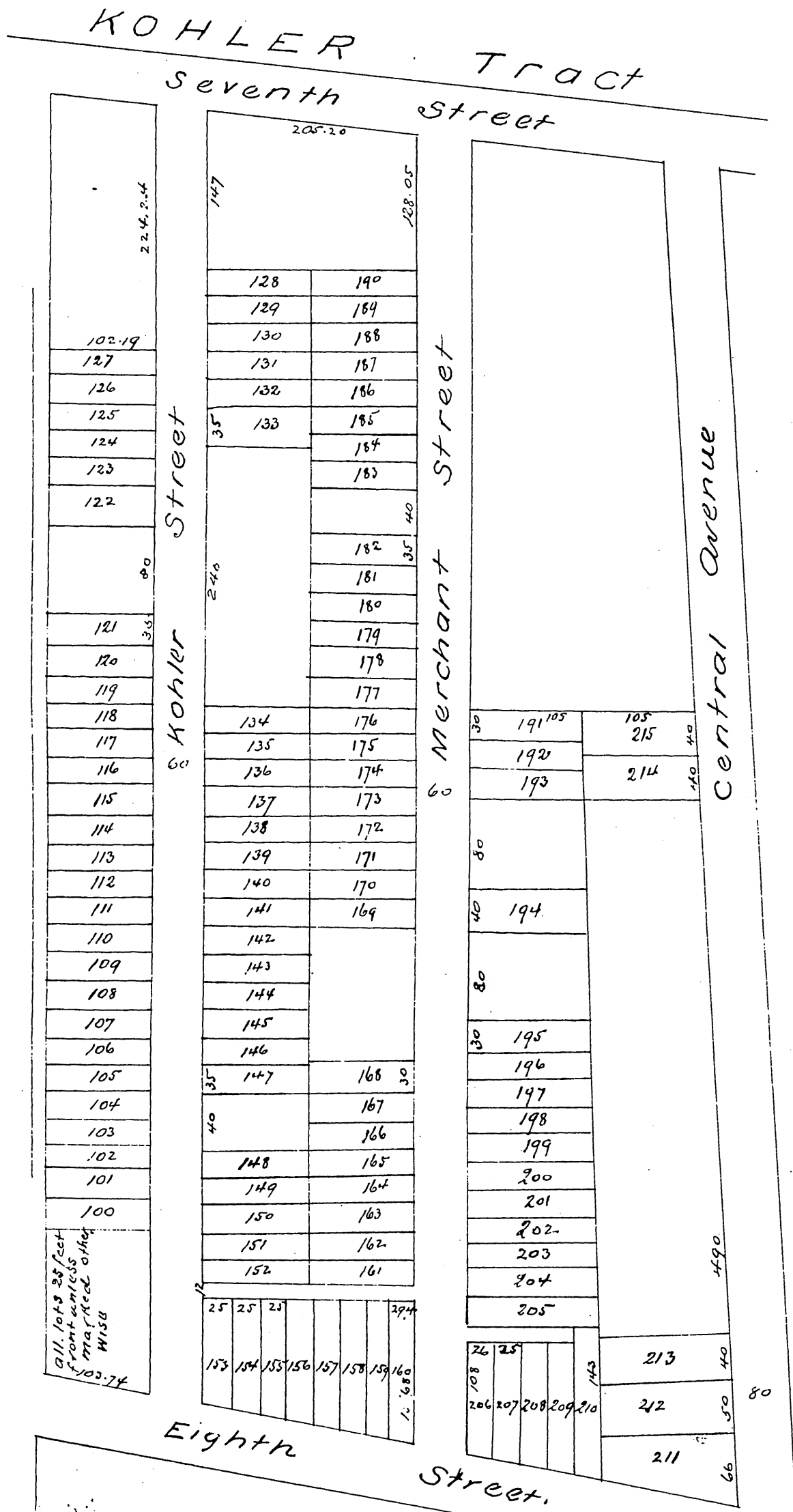

Appendix. for details as to courses distances and depths of lots reference is hereby made to map of Kohler and Frohling tract recorded in book 21, page 46 of Misc. Records of Los Angeles Co. California July 17th 1894. W. J. Fisher

Owner W. J. Fisher

A full true and correct copy of the original (size of map reduced to an exact one-half size) recorded July 17, 1894 at 28 min past 2 p. m. at request of So. Cal. Natl Bank

Arthur Gray, Co. Recorder
by W. W. Mills Deputy