

commencing near the Town of Santa Monica at Engineer Station 150+00 in the center line of the branch of Southern Pacific Railroad extending from Los Angeles to Santa Monica, and generally known as the Los Angeles and Independence Railroad, thence at right angles to the center line of said railroad, as now constructed, North 13°55' West 350 feet; thence at right angles South 76°05' West parallel to and at a uniform distance of 350 feet north westerly, from said center line produced from Engineer Station 128+64, 4000 feet; thence at right angles South 13°55' East 700 feet; thence at right angles North 76°05' East parallel to and at a uniform distance of 350 feet south-easterly from the center line of said railroad and said line produced 4000 feet; thence at right angles 13°55' West 350 feet, to the point of beginning, containing 55 acres, more or less be and the same hereby are vacated and abandoned provided that the Southern Pacific Company grant to this County, a right of way, across its Railroad, right of way, at a point East of the tract described in said petition, to be designated by the Board of Supervisors

27th St. changed to Anita Ave. Ord. 39,425  
Anita Ave. " 122nd Ave. Ord. 46124

All streets within the territory inclosed in red lines hereon, are vacated by said Order.

Recorded Jan. 9 1895  
at request of J. D. Bicknell

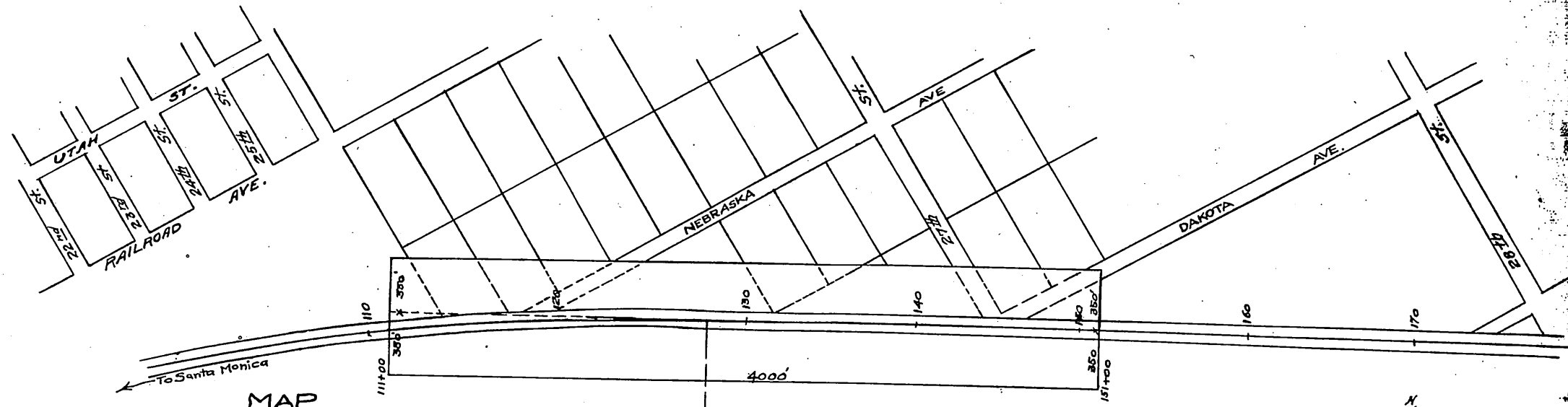

MAP

Showing portions of Streets vacated by order of the Board of Supervisors of the County of Los Angeles, California, made and entered on the 23<sup>rd</sup> day of November, 1894, in the Subdivision of a portion of the R<sup>o</sup> San Vicente Santa Monica, lying East of and adjoining the City of Santa Monica

Scale. 800 Ft = 1 inch.

RANCHO SAN VICENTE Y SANTA MONICA

RANCH BOUNDARY

*Handwritten signature*