

MAP OF HICKLIN'S SUBDIVISION

of South 1/2 of Hicklin Tract situated east of Ellen St. & south of Alvarado St. City of Pomona, Los Angeles Co. Cal. Surveyed and platted for J. Hicklin April 9 and 10, 1895, by W. H. Sanders C.E. Scale 50 = 1"

W. H. Sanders C.E.

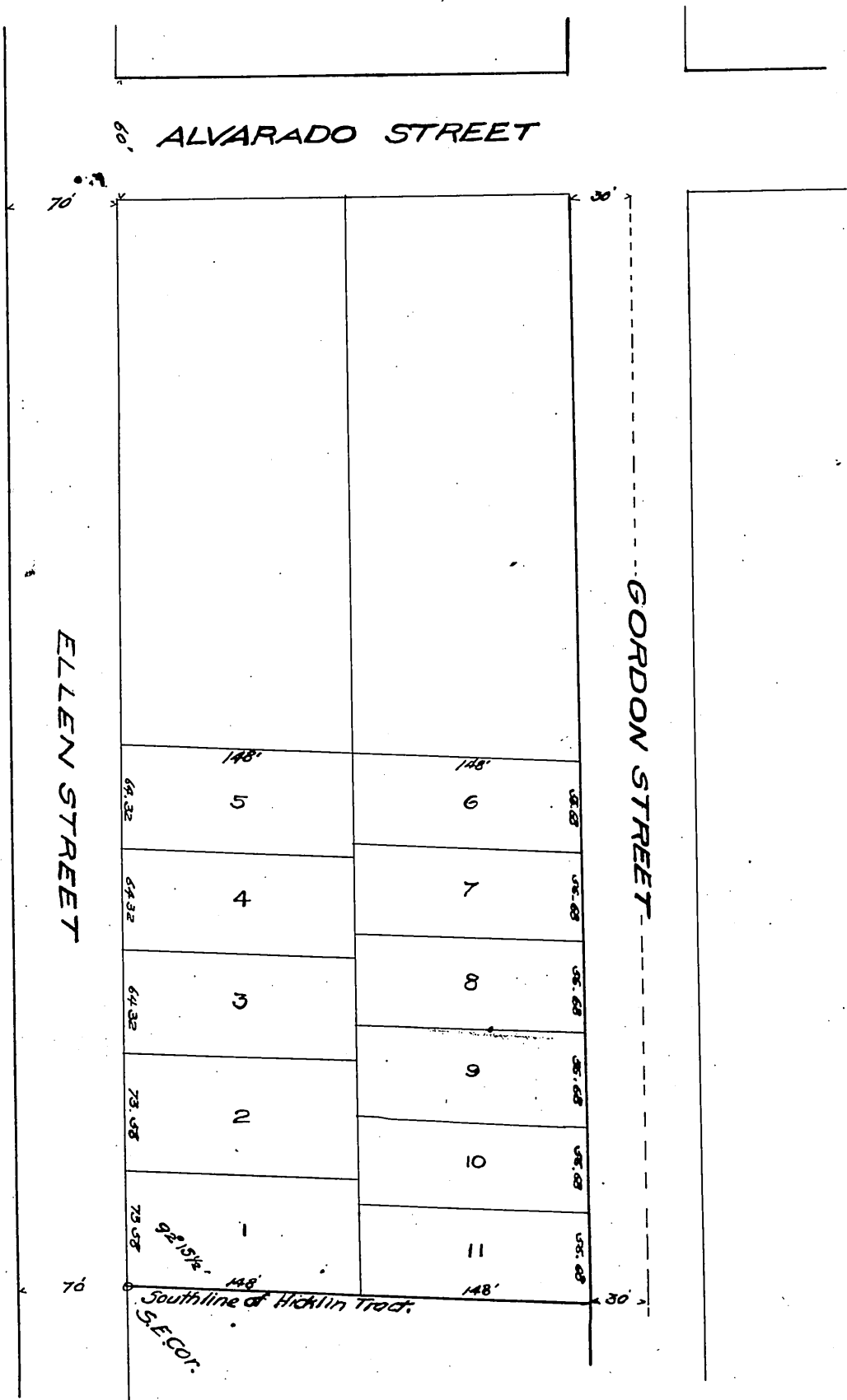

owners,
Josephus Hicklin Seal
Emma Hicklin Seal

Ellen St changed to Park Ave Ord 300 D-6-180

Recorded at request of Goodwin & Macy Apr. 23 1895.
(Scale reduced to exact one-half size)

Compd
C.H.C.