

Map of ALAMITOS BEACH TOWNSITE

IN LOS ANGELES CO, CAL.
Part of the Rancho Los Alamitos

Recorded for the purpose of supplying lot numbers and distances omitted from map of Alamitos Beach Townsite as recorded in Book No. 10, Pages 51 and 52, Miscellaneous Records of Los Angeles County, Cal. Note: location of street alley, lot and block lines remain the same as in original map recorded in Book 10, Pages 51-52

Scale: 500ft to 1 inch.

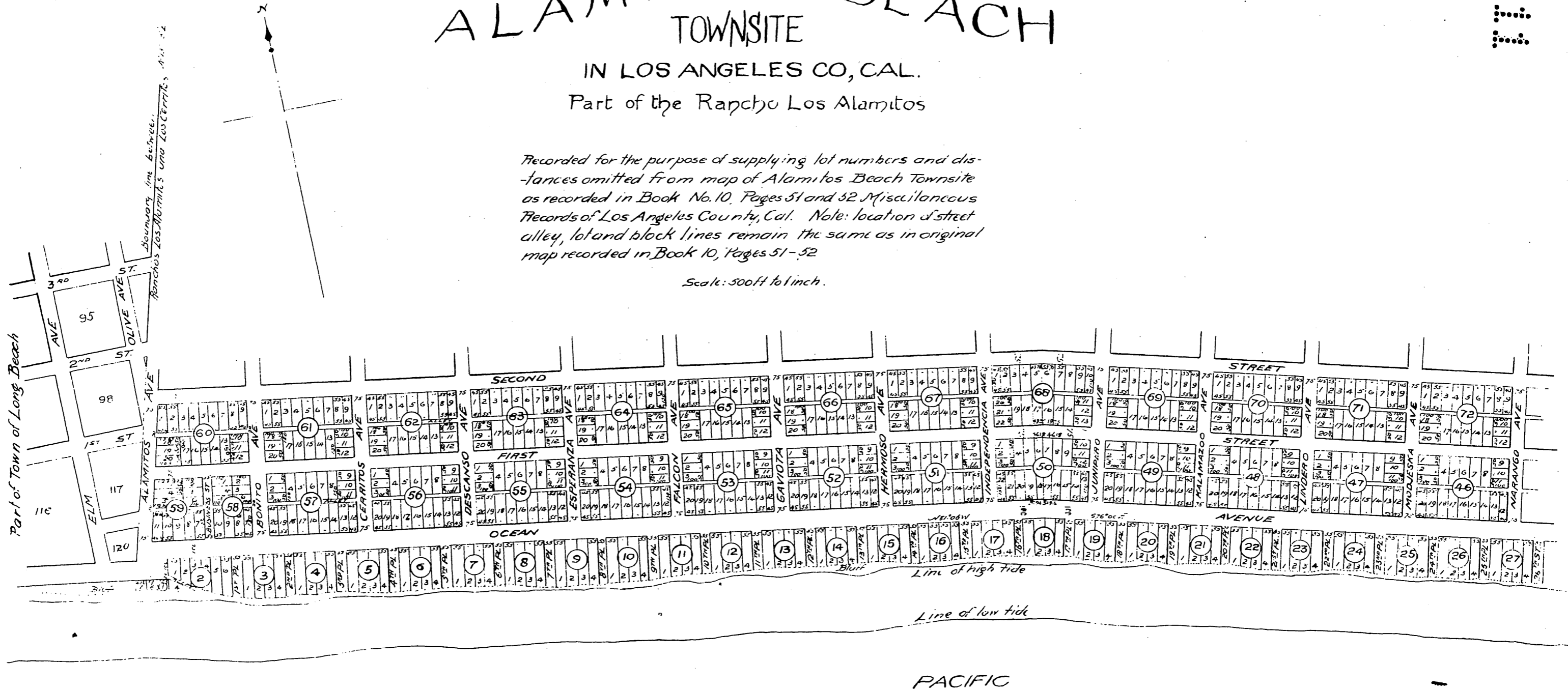

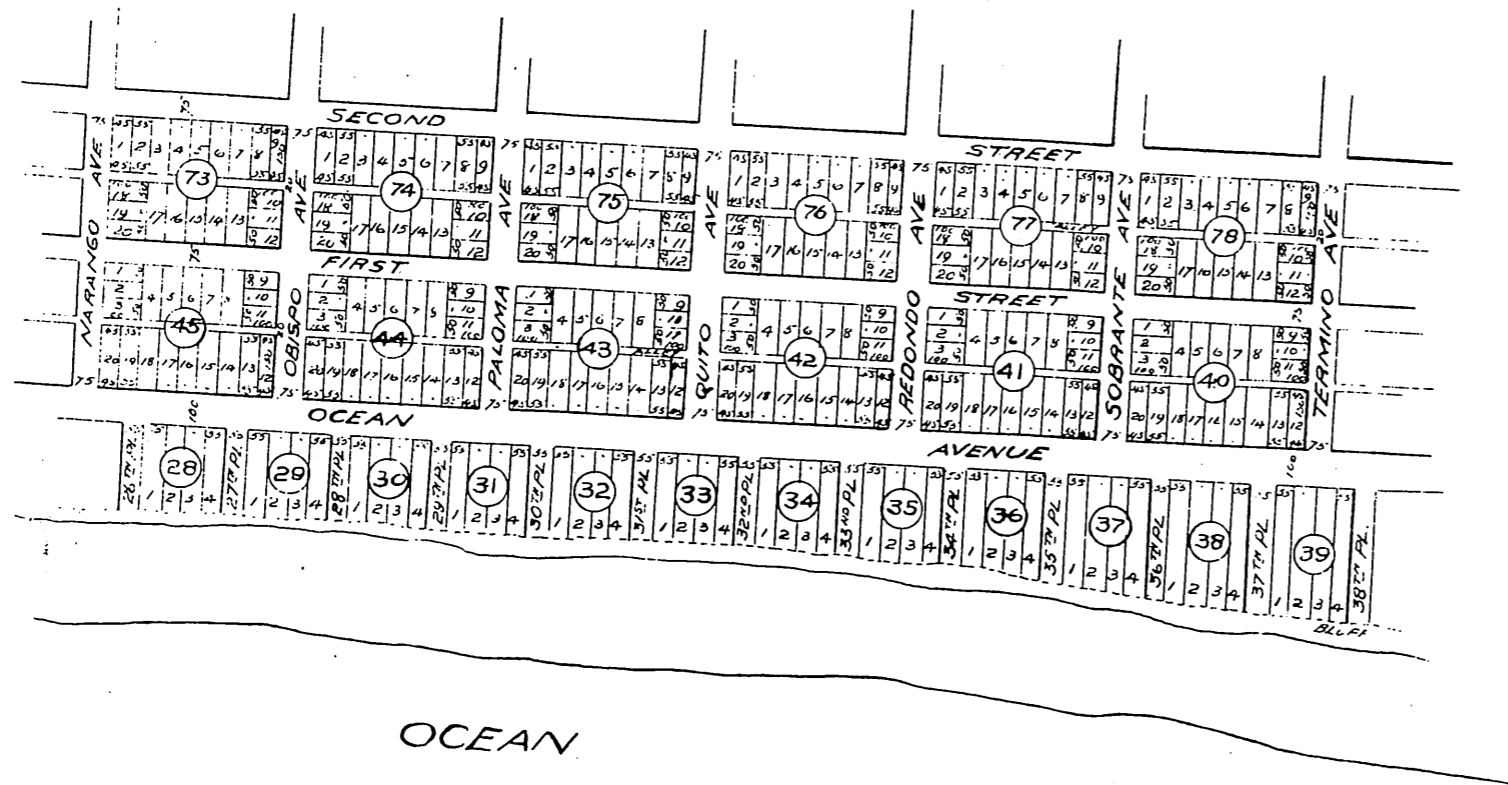
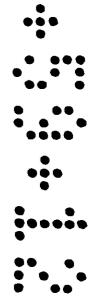

*See also
Plat of the Standard Co.*

*This is true and correct copy of the original
Recorded Nov 16 1895, at 46. Min past 3 P.M.
at request of L. Babby*

E.C. Hodgman, County Recorder.

*By E.T. Wright,
County Surveyor and ex officio Deputy County Recorder.*