

Map of the Wilshire Boulevard Tract

being a subdivision of lot 2 Block 25 Hancock's Survey
of the City of Los Angeles, State of California
Surveyed December 1895 by
V. J. Rowan Licensed Surveyor
Scale 100 feet to one inch
True bearings calculated from U.S. Standard Meridian
All distances noted are in feet

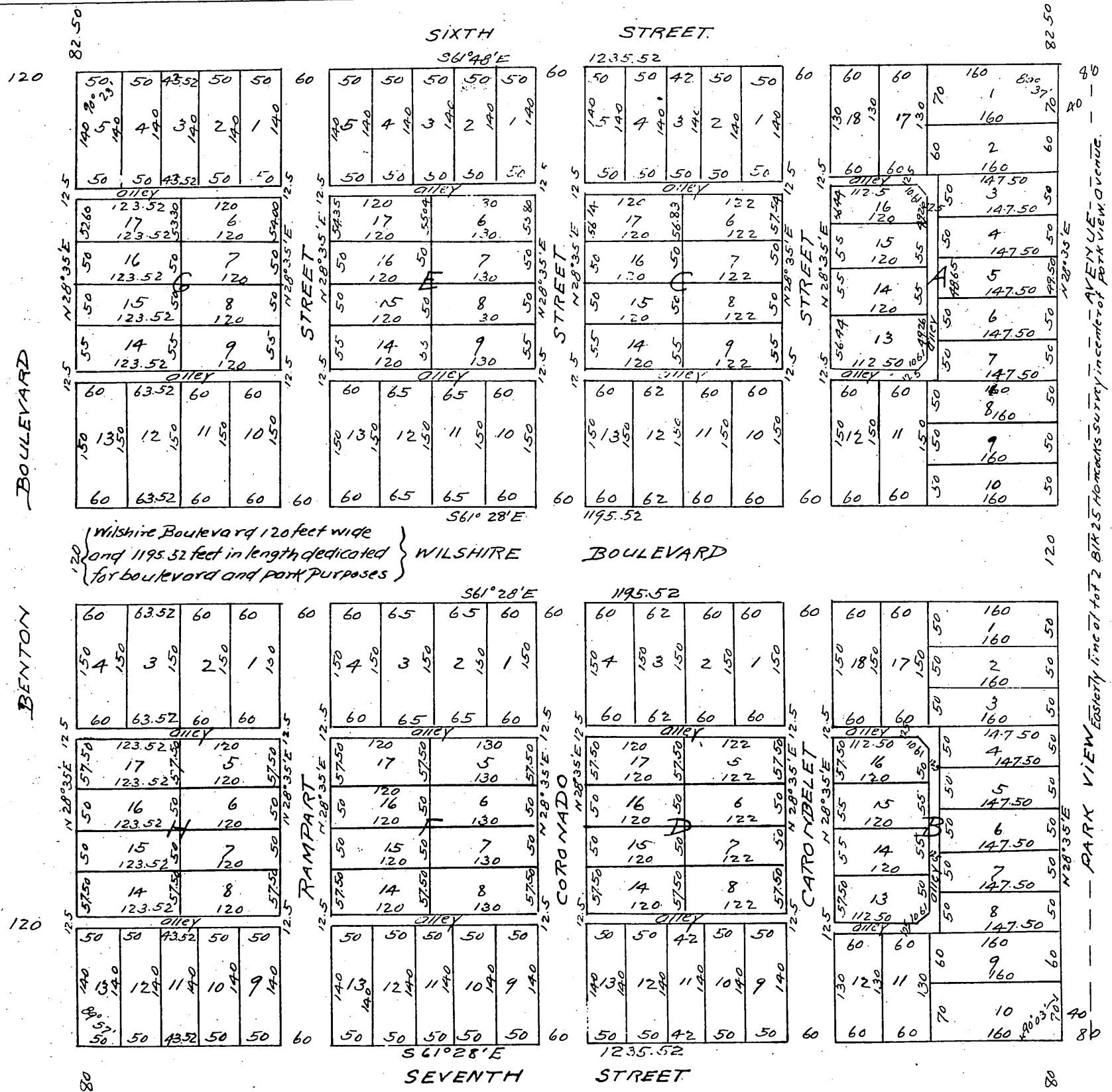

We H.G. Wilshire and W.B. Wilshire hereby certify that we are the owners of the lands shown on this map which map was made at our request and shows the subdivision of said lands into blocks, lots, streets, boulevards, parks, and alleys
Los Angeles California
December 21st 1895

H.G. Wilshire.
W.B. Wilshire.

A full, true and correct copy of the original.
(Scale reduced to 150 feet to one inch,
Recorded Dec 21, 1895 at 5 min Past 3 P.M.
at request of Wilshire and Co
E.C. Hodgman County Recorder.

By E.T. Wright.
County Surveyor and ex officio Deputy County Recorder.