

Plat showing showing
 frontage of blocks in the
Boettcher Tract
 on San Pedro St
 and all streets connecting with same on the East side
 Dec 31st 1896
 Scale = 100 per inch

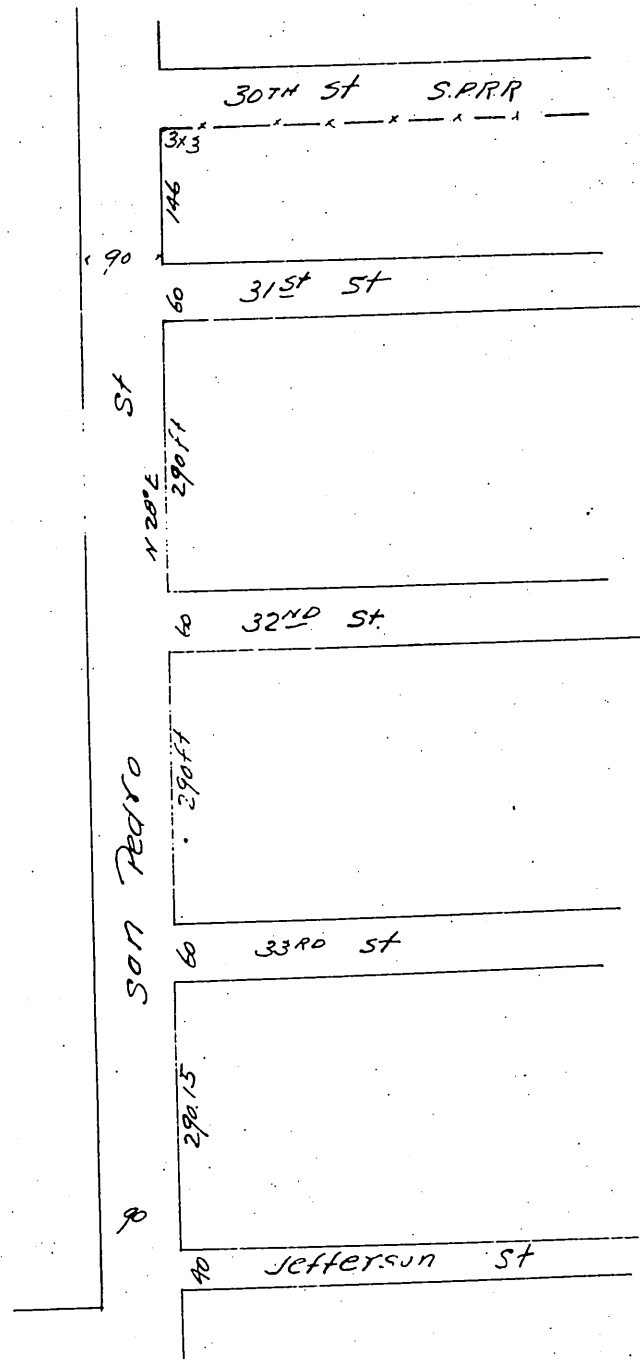

Henry H. Boettcher

A full, true and correct copy of the original
 (Scale reduced to 200 feet to 1 inch)
 Recorded Jan 2 1897, at 20 min past 2 P.M.
 at request of H. Boettcher

EC Hodgman County Recorder
 BY E.T. Wright Co Surveyor