

TAN RIAW SBM

Scale 1000=1"

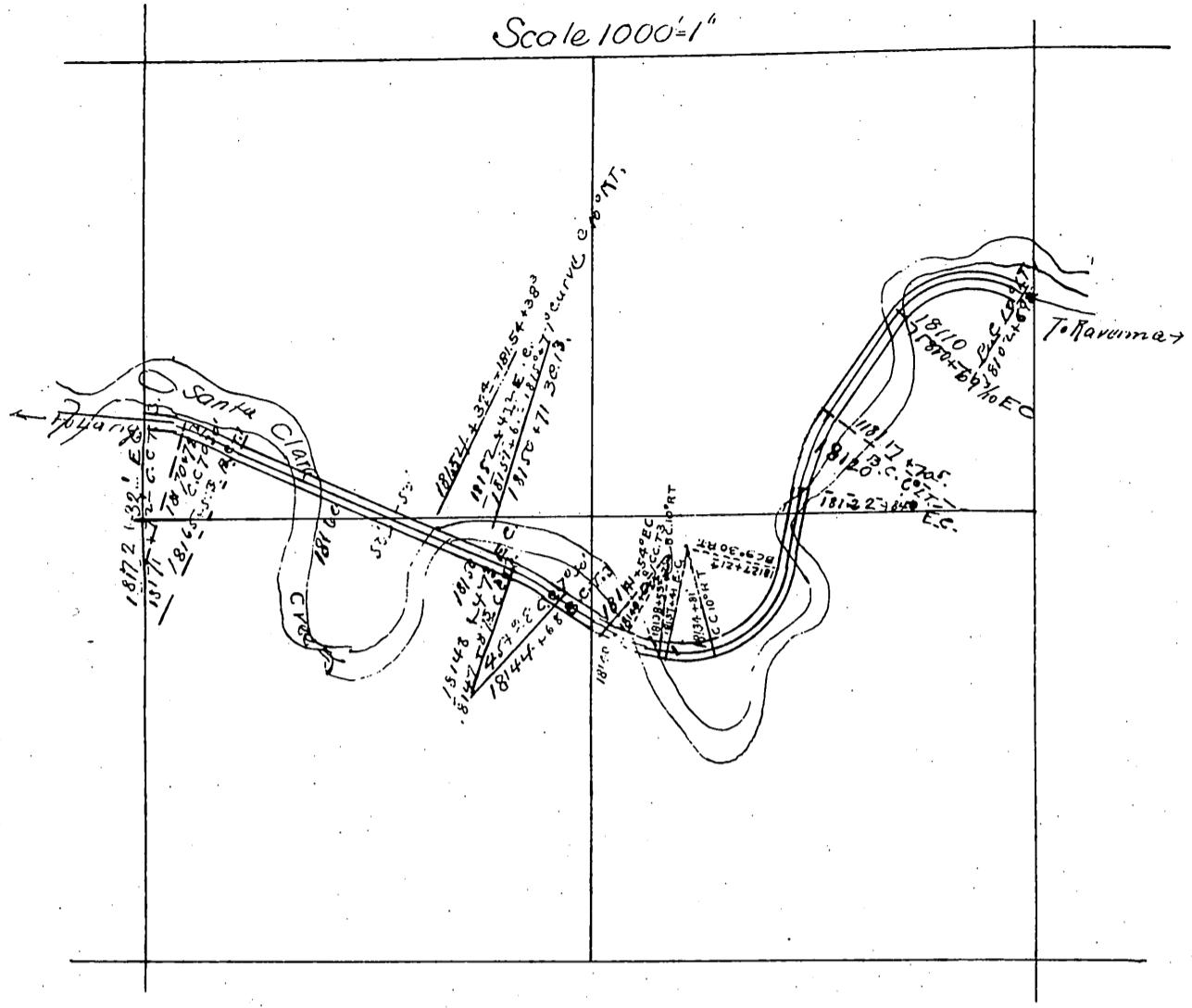

A full true and correct copy of the original recorded Sept 14 1898
 at 40 min past 11 am at request of J. C. Miner

E. C. Hodgman Co Rec
 By E. T. Wright Co. En.

Note: The above map correctly shows the land selected, taken and obtained, by the Southern Pacific Railroad Co for the use of its railroad over and through Section 16 - T. 4 N. R. 14 W S. B.M.; such land being a right of way strip 7043 feet in length, having a width of 50 feet on each side of the located line of said railroad, following the course thereof, and containing an area of $16 \frac{95}{100}$ acres - within the said Section 16