

Pecks Subdivision of Block 2

OF THE,

Palos Verdes Tract

Being a part of Lot 1 in Lot M of the Original Partition of the Rancho Los Palos Verdes in the County of Los Angeles

Scale 100ft to one inch

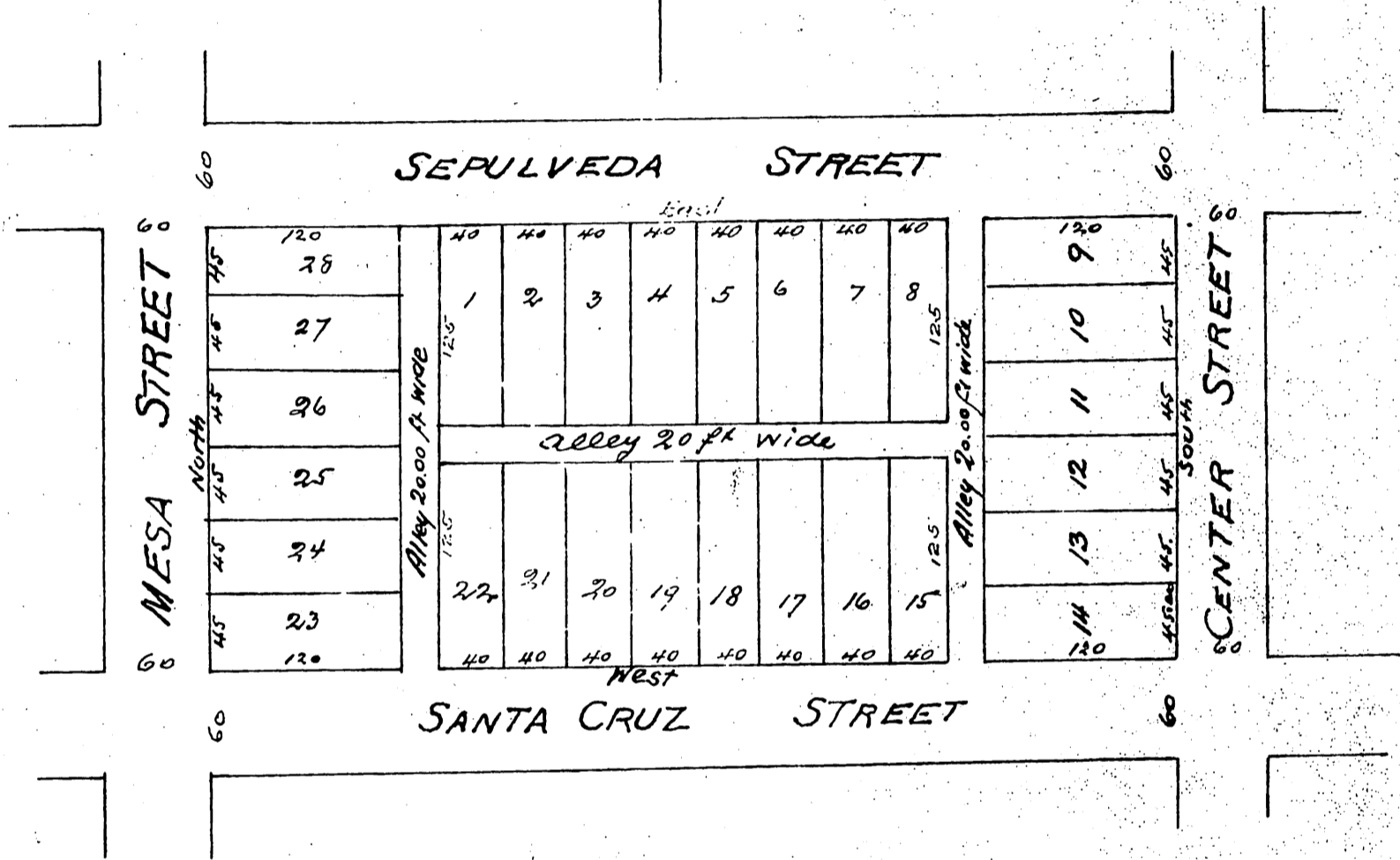

I hereby certify that I am the proprietor of the property subdivided as shown by this map and further that I caused such subdivision and map to be made and dedicated for public use the streets and alleys as shown on this map

Geo. H. Peck Jr.

A full true and correct copy of the original recorded Dec. 9 1898 at 27 min. past 11 o'm at request of Geo. H. Peck Jr. E.C. Hodgman Co Rec. by E.T. Wright Co Sur.