

Map of the Northwest quarter of Section 5 Township 1 South Range 8 West, S.B.M. showing reversion to acreage of said quarter section as delineated on map of Piedmont, recorded in Book 34 at page 99 of Miscellaneous Records of Los Angeles County, Cal.  
 W.E. Mount, C.E. Draughtsman.  
 Scale 300 feet to one inch.

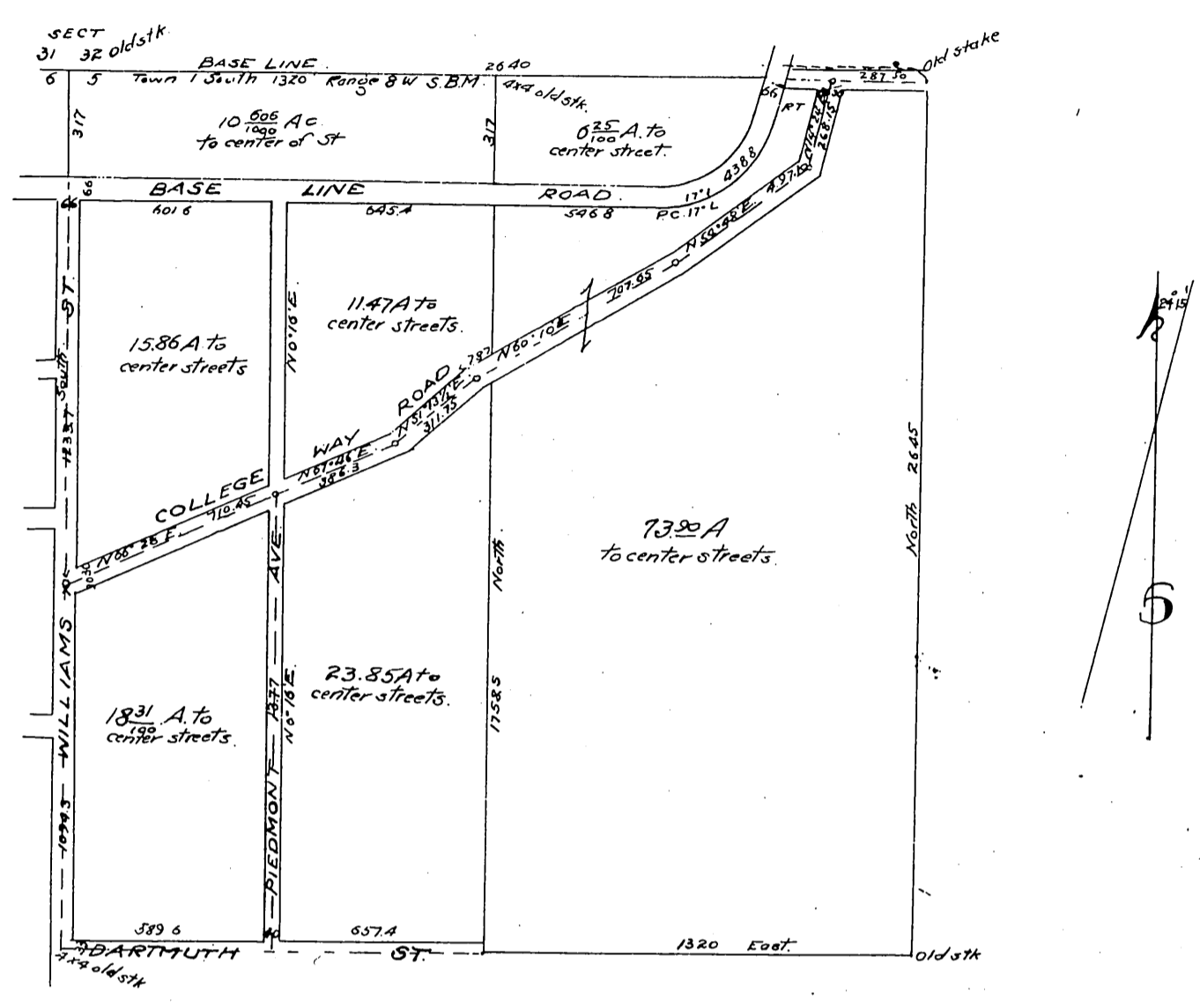

Road Book 6 Page A45  
 Office of the Board of Supervisors  
 of Los Angeles County, California. February 18th 1902.

The Board met in regular session pursuant to adjournment. Present: Supervisors E. S. Field, Chairman presiding, Geo. Alexander, James Hanley, O. W. Longden and P. J. Wilson, and C. W. Bell, Clerk, by R. Williams, deputy.

In re Vacation of Piedmont Avenue  
 San Jose Road District.  
 Petition of C. E. Straight, et al.

This being the time regularly set by order of continuance of this

Board for hearing herein, the matter is taken up. And upon motion of Supervisor Longden, duly seconded and carried it is ordered that 15 feet off each side of Piedmont Avenue in San Jose Road District, from the south line of Base Line Road to the north line of Dartmouth St., be and the same is hereby vacated and abandoned and the land therein contained restored to acreage, thus making - Piedmont Avenue 40 feet wide.

This order is conditioned upon the petitioners filing for record in the office of the Recorder of Los Angeles County a certified copy hereof together with a map showing all lands as affected thereby.

State of California }  
 County of Los Angeles } S.S. No...  
 I, C. W. Bell, County Clerk and ex-officio Clerk of the Board of Supervisors of said County, do hereby certify the foregoing to be a full, true and correct copy of the original Minutes of the Board of Supervisors as appears in Road Book No. 6 Page A45... In re Vacation of Piedmont Avenue, San Jose Road District, Petition of C. E. Straight, et al on file in my office, and that I have carefully compared the same with the original.

A full, true and correct copy of the original (Scale reduced to 500 feet to one inch) Recorded Apr. 5, 1902, at 47 Min. past 11 A.M. at request of Owner

R. D. Wade, County Recorder.  
 By Jos. H. Smith  
 County Surveyor and ex-officio Deputy County Recorder.

In Witness Whereof, I have hereunto set my hand and affixed the seal of the Board of Supervisors this 5th day of April, 1902  
 C. W. Bell, County Clerk.  
 By R. Williams Deputy.

