

PLAT OF  
 SURVEY OF LAND SITUATED ON  
 NORTHWEST CORNER OF  
 WASHINGTON ST AND GRAND AVE.  
 LOS ANGELES CITY, CALIFORNIA  
 SURVEYED BY J. H. DOCKWEILER  
 MARCH 23 1901  
 SCALE 100 FEET TO 1 INCH.

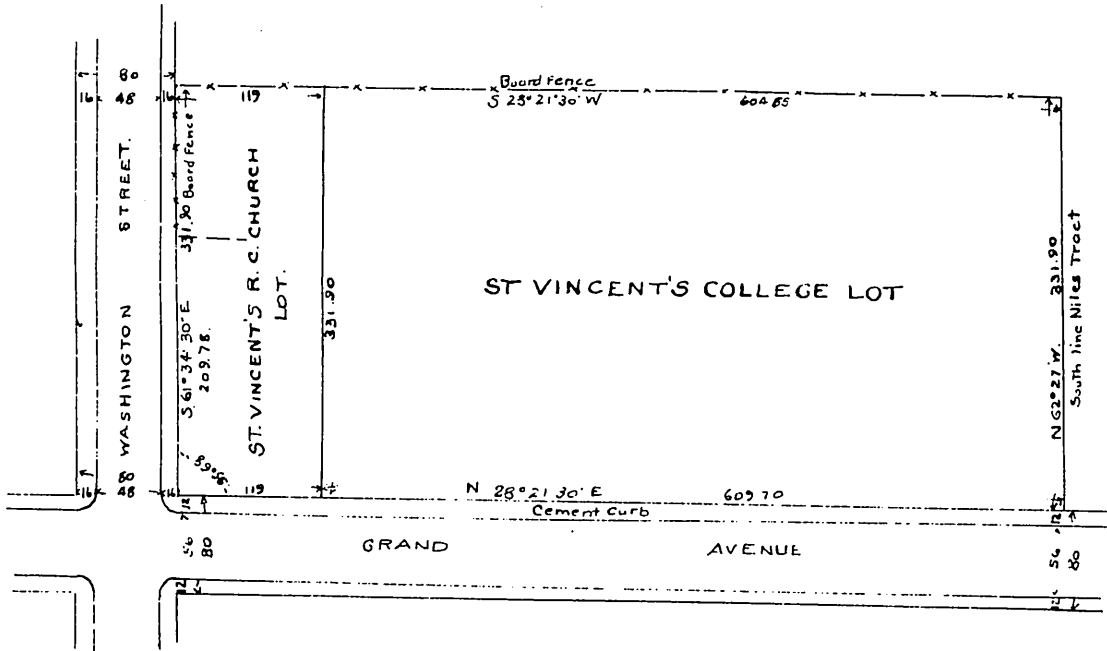
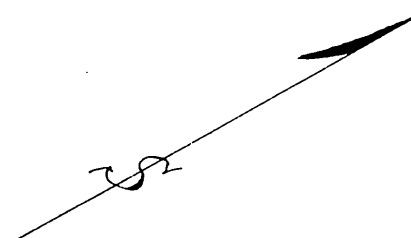

State of California }  
 County of Los Angeles } S.S.

The undersigned the President and Board of Trustees of Saint Vincent's College a corporation does hereby certify and acknowledge that it is the owner and proprietor of the land shown upon this map and within the red colored lines thereon; that it caused this map to be made out; that this map accurately and particularly sets forth and describes and represents its subdivision of said land. In witness whereof, said corporation the President and Board of Trustees of Saint Vincent's College has caused its name to be hereunto subscribed by its President and its seal to be hereunto affixed by its Secretary by resolution of its Board of Trustees duly and regularly adopted on the 17th day of April 1901.

"President and Board of Trustees of Saint Vincent's College" a corporation

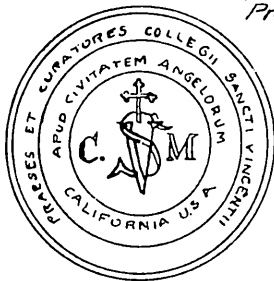

By J. A. Linn & Co. President  
 Attest W. X. McCabe & Co. Secretary

State of California }  
 County of Los Angeles } S.S.

On this 18th day of April in the year one thousand nine hundred and one before me DH Laubersheimer, a Notary Public in and for said County of Los Angeles, State of California residing therein duly commissioned and qualified personally appeared J. A. Linn & Co. known to me to be the President, and W. X. McCabe & Co. known to me to be the Secretary of the "President and Board of Trustees of Saint Vincent's College" the Corporation that executed the within instrument and acknowledged to me that such corporation executed the same.

In witness whereof, I have hereunto set my hand and affixed my official seal the day and year in this certificate first above written.

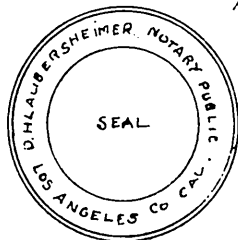

D. H. Laubersheimer  
 Notary Public in and for Los Angeles County, State of California.

A full true and correct copy of the original  
 (Scale reduced to 150 feet to one inch)  
 Recorded Apr 18 1901 at 54 Min past 12 M.  
 at request of J. A. Linn

By J. H. Smith  
 County Surveyor and ex-officio Deputy County Recorder.