

Block A.

107-52

Being a Re-subdivision of Blk. A, and the southern portion of Blks. C, and P, of Rosedale

Cemetery.

Scale 50' = 1" =

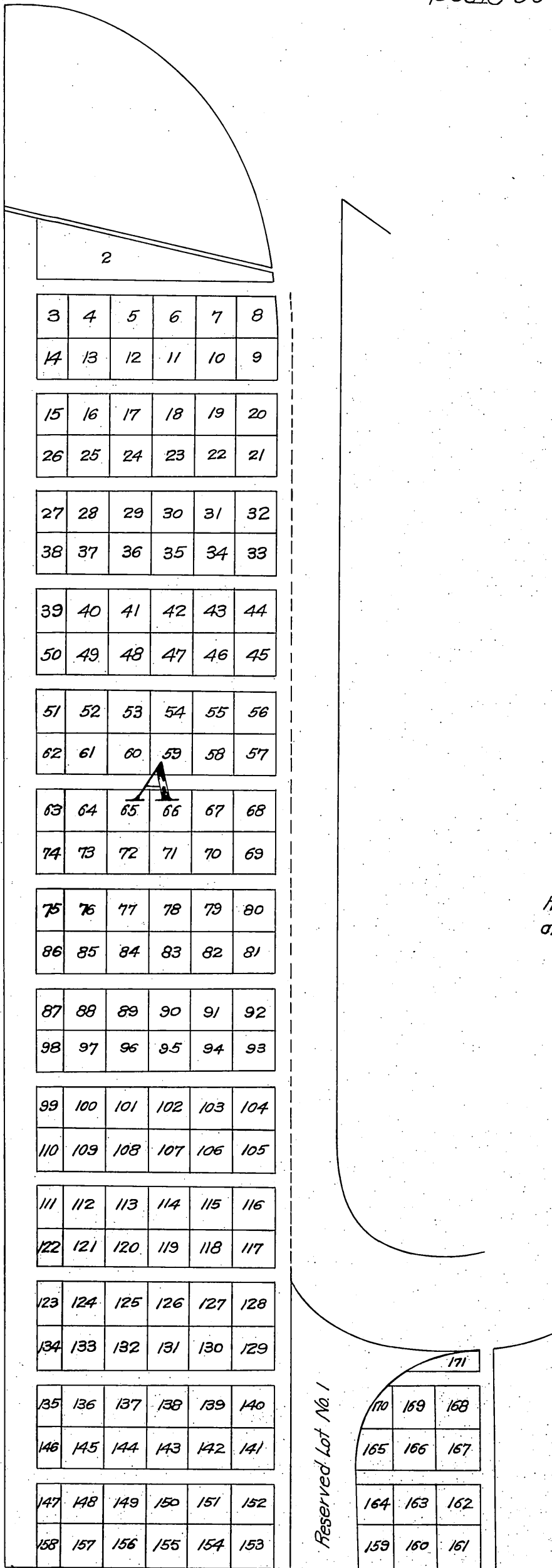

owner:-

The Rosedale Cemetery Association

Geo. D. Cochran Vice President.

Simpson M. Sinsabaugh Sec.

Recorded at request of Owner May 1, 1905
at 1 min. past 3 P.M.

For ReSub See MR 107-303-4-5

Reserved Lot No. 1

