

107-111

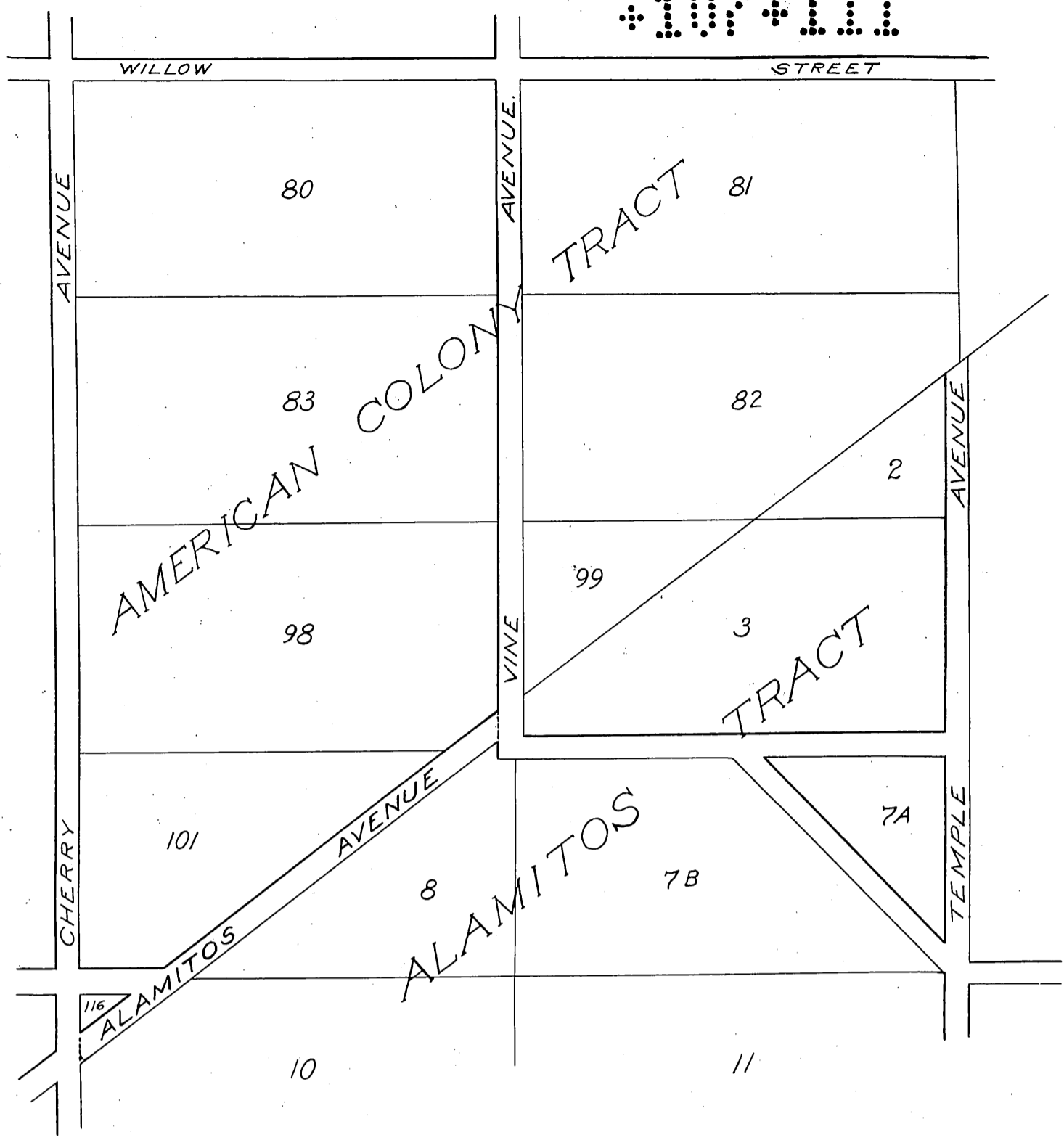

Colored portion shows street vacated.

Office of the Board of Supervisors
of Los Angeles County, California
April 18, 1905.

In Re Vacation of Alamos Avenue }
Long Beach Road District }

It is ordered that all that portion of Alamos Avenue situate, lying and being, in the Long Beach Road District, County of Los Angeles, State of California, described as follows to-wit: "All that portion of Alamos Avenue commencing at the east line of Cherry Avenue and extending to the west line of Vine Avenue, all as shown on the Map of the Alamos Tract recorded in Book 36, page 37, et seq, Miscellaneous Records of the County of Los Angeles" be and the same is hereby vacated and abandoned and the land therein contained restored to acreage.

Recorded at request of owner Jan. 16, 1906
at 8 min. past 1 P.M.

F.O.K.
Sht. O.K.

comp-
H.B.G.

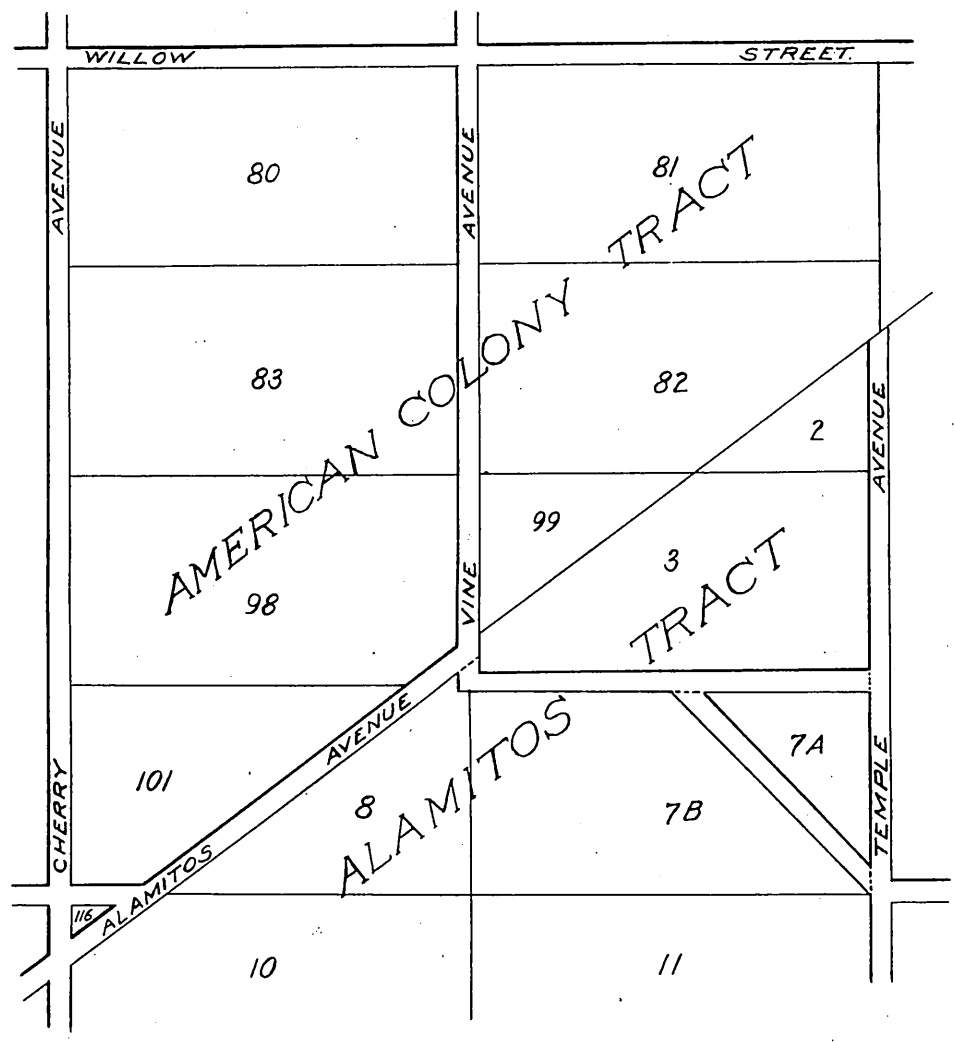

Colored portion shows Streets vacated

Office of the Board of Supervisors
of Los Angeles County, California
April 18, 1905

*In Revocation of Certain Unnamed Streets
in the Long Beach Road District*

It is ordered that the following described Streets or public highways situate, lying and being in the Long Beach Road District, County of Los Angeles, State of California, to-wit "That certain Street running in a Northwesterly and Southeasterly direction between the westerly line of Farm Lot Seven "A" (7A) and the easterly line of Farm Lot Seven "B" (7B) of the Alamos Tract, as per Map thereof recorded in Book 36, page 37-44, et seq., Miscellaneous Records of the County of Los Angeles, and commencing at the Easterly boundary line of said Farm Lot 7A produced to the Northerly boundary line of Farm Lot Eleven (11) of the Alamos Tract, and ending at the North boundary line of said Farm Lot 7A produced Westerly to the Northern boundary line of said Farm Lot 7B; said Street being shown on said Map of the Alamos Tract recorded in said Book 36, page 37-44, Miscellaneous Records of the County of Los Angeles, as having no name; also, "That certain Street running in a general easterly and westerly direction along the south boundary line of Farm Lot Three (3) of said Alamos Tract and extending from the West line of Temple Avenue to the East line of Alamos Avenue, as shown on said Map of said Alamos Tract; said Street being shown on said Map of said Alamos Tract as having no name" be and the same are hereby vacated and abandoned and the land therein contained restored to acreage.

Recorded at request of owner Jan. 16-1906
at 9 min. past 1 P.M. (Scale reduced to 600'-1")

F.O.K.
Sht. O.K.

Comp.
H.C.T.