

SHOWING THAT PORTION OF

College St.  
Vacated as per minutes of the  
Board of Supervisors  
as appears in  
Road Book #9 Page 142.

H.T. Hazards East Side Addition

M. R. 24-25

BROOKLYN AVE.

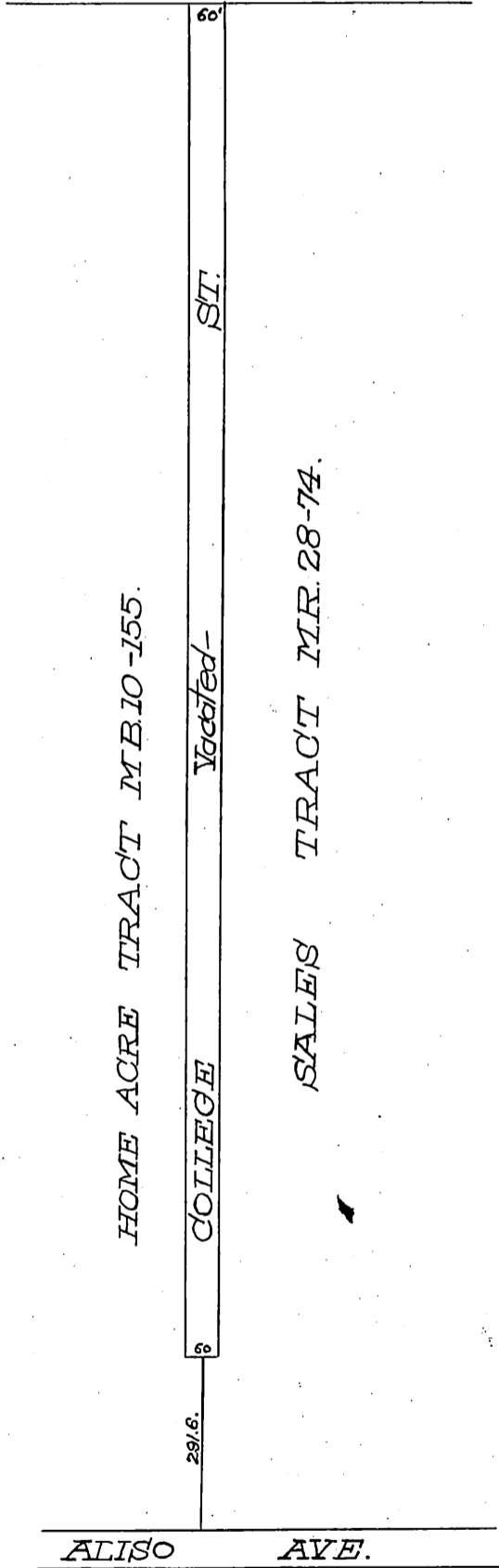

Office of the Board of Supervisors,  
of Los Angeles, County, California  
Monday, October 22, 1906.

In Re-vacation of a Portion of College Street  
in the Alhambra Road District

It is ordered that the  
following described public highway, situate lying and being in the Alhambra Road District,  
County of Los Angeles, State of California, to-wit: That portion of College Street between Brook-  
lyn Avenue and a point two hundred ninety one and six-tenths (291.6) feet north of Aliso Avenue,  
be and the same is hereby vacated and abandoned and the land therein contained restored  
to acreage.

Recorded at request of Van Ness Co. Oct. 30  
1906. At 11 min. past 4 P.M.

comp  
H. 11