

MAP

107002

OF A PORTION OF THE

# Amended Map of Plummer Square

After vacation of Ave. as per attached certified copy of the order of  
The Board of Supervisors  
Scale 1"=200'

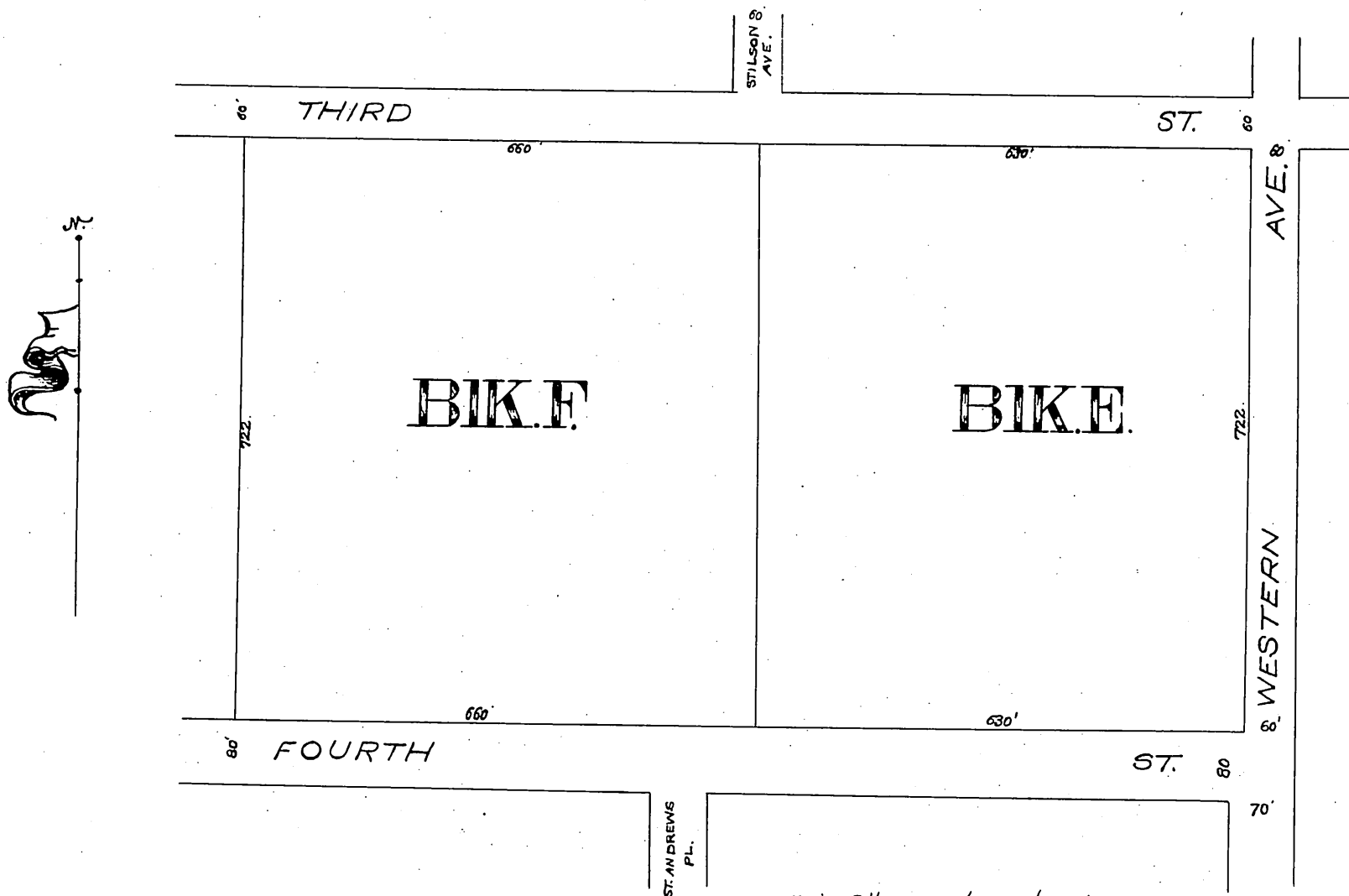

Office of the Board of Supervisors,  
of Los Angeles County, California,  
Monday, December 10, 1906.

In re vacation of Stilson Avenue in  
Chuenga Valley Road District.

It is ordered that the following described public highway situate, lying and being in the Chuenga Valley Road District, County of Los Angeles, State of California, to-wit: All that portion of Stilson Avenue as shown on the Amended Map of Plummer Square, as recorded in Book 66 at Page 8 of Miscellaneous Records of Los Angeles County, - That lies south of Third Street and North of the North line of Fourth Street as deeded to the County by deed recorded in Book 1206 at Page 50 of Deeds, -- be and the same is hereby vacated and abandoned and the land therein contained restored to acreage.

Recorded at request of W. Johnson Dec. 17  
1906 at 9 min. past 11 A.M.

S. O. K. A. O. K.

copy  
H. J. G.