

PLAT

—30F—

BLOCKS 15^{and} 16

California Cooperative Colony Tract
Showing vacated Street in Color

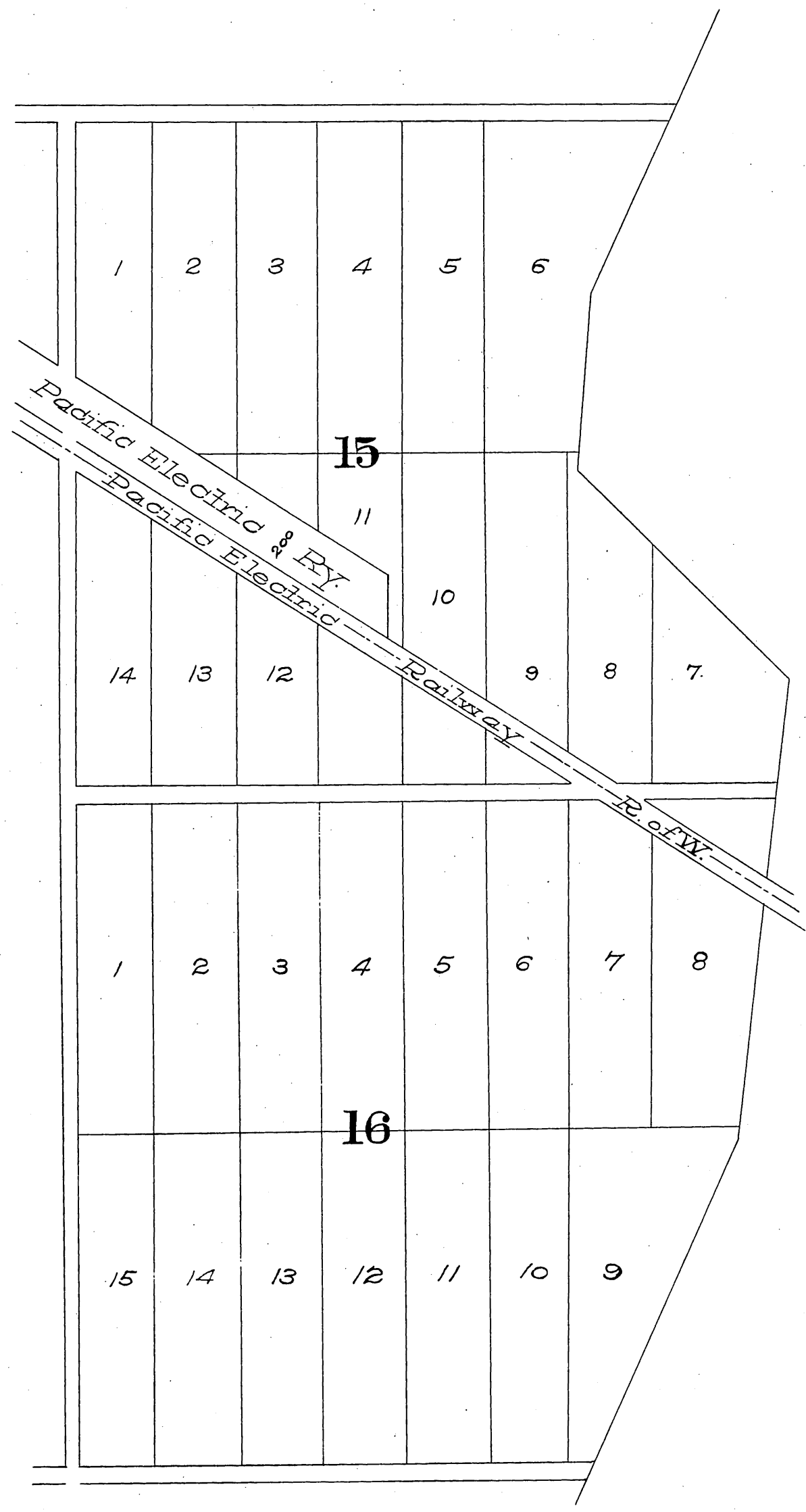

(Road Book 5, page 519)

Office of the Board of Supervisors
of Los Angeles County, California
Nov. 13th. 1899.

In Revocation of Certain Unnamed Streets
In the California Co-operative Colony Tract.

It is ordered that the following resolution be and the same is hereby adopted: Resolved that the prayer of the petitioners here in be and the same is hereby granted to the following extent: First. -- All that portion of that certain street ordered appearing on the map of said California Co-operative Colony Tract to-wit; commencing at Washington street, this point being the N. E. Corner of Block 13, and the N. W. Corner of Block 14, of said Tract; thence south between Block 13 and 14 to Center Street at the South side of said Block 13 and 14. Second. -- All that portion of that certain street or road appearing on the said map, commencing of the southeast corner of Lot 27 of Block 17 of said tract, and running thence south between Blocks 17 and 31, and 15, 16 and 32 of said tract, to the southern boundary of said tract. Third. -- And all that certain street or road appearing on said map running between Block 15 and 16 of said tract. And it is further Ordered that the streets or road heretofore described be and the same are hereby vacated and abandoned and the land therein contained restored to acreage.

Recorded at request of T. I. & T. Co. Jan. 11, 1908.