

LOS ANGELES RAILWAY CORPORATION

55

TO

THE CITY OF LOS ANGELES

SEWER EASEMENT

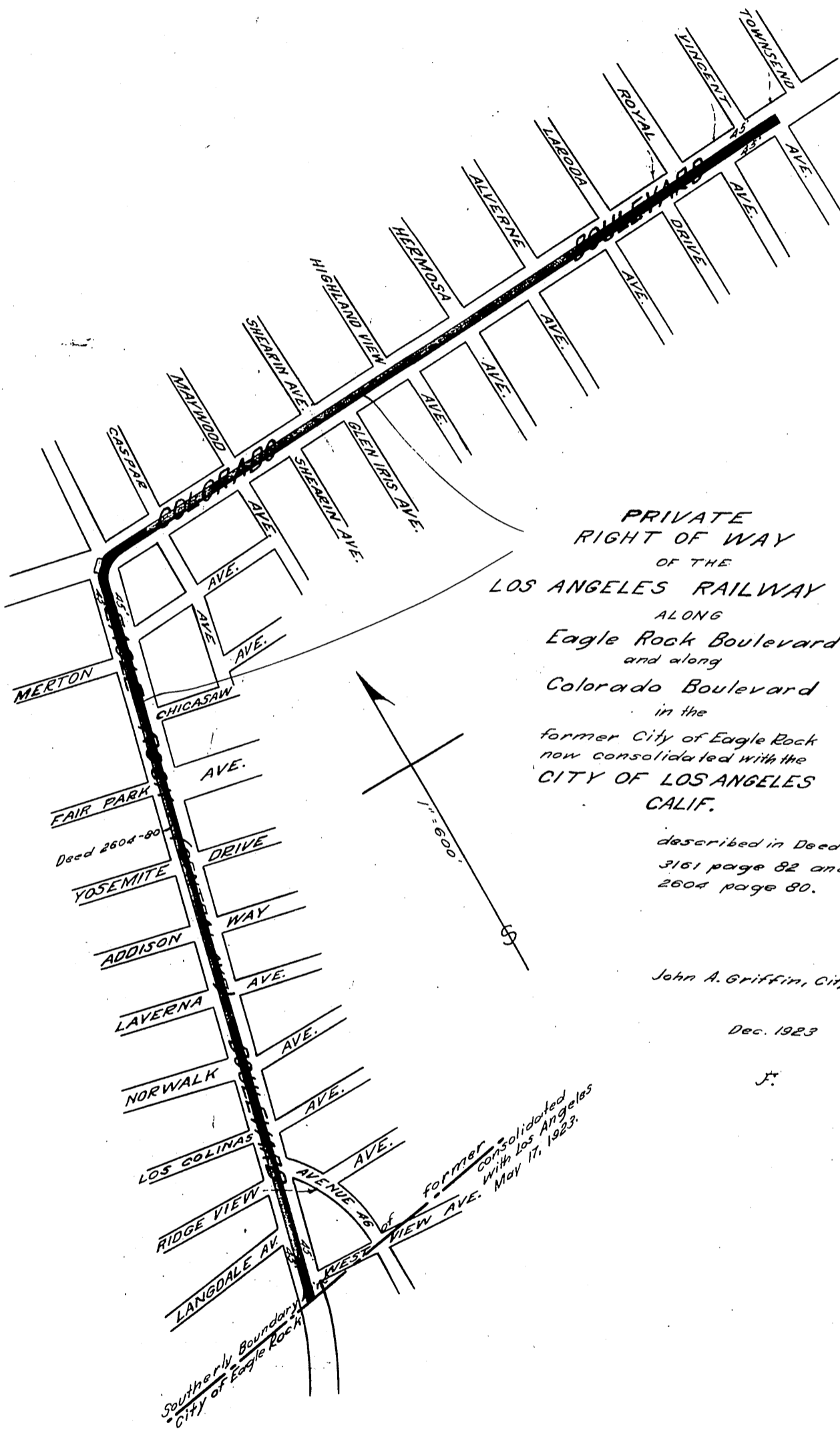

PRIVATE
RIGHT OF WAY
OF THE
LOS ANGELES RAILWAY CO.
ALONG
Eagle Rock Boulevard
and along
Colorado Boulevard
in the
former City of Eagle Rock
now consolidated with the
CITY OF LOS ANGELES
CALIF.

described in Deed Books
3161 page 82 and
2604 page 80.

John A. Griffin, City Engineer

Dec. 1923

J.

former consolidated
with Los Angeles
May 17, 1923.

southern boundary
City of Eagle Rock

C.W.
Comp. W.M.

A-527
A-528

RECORDED MAR. 29, 1924.