

89

ORM 3550-210 210

PACIFIC ELECTRIC RAILWAY COMPANY  
TO  
COUNTY OF LOS ANGELES

92

S30

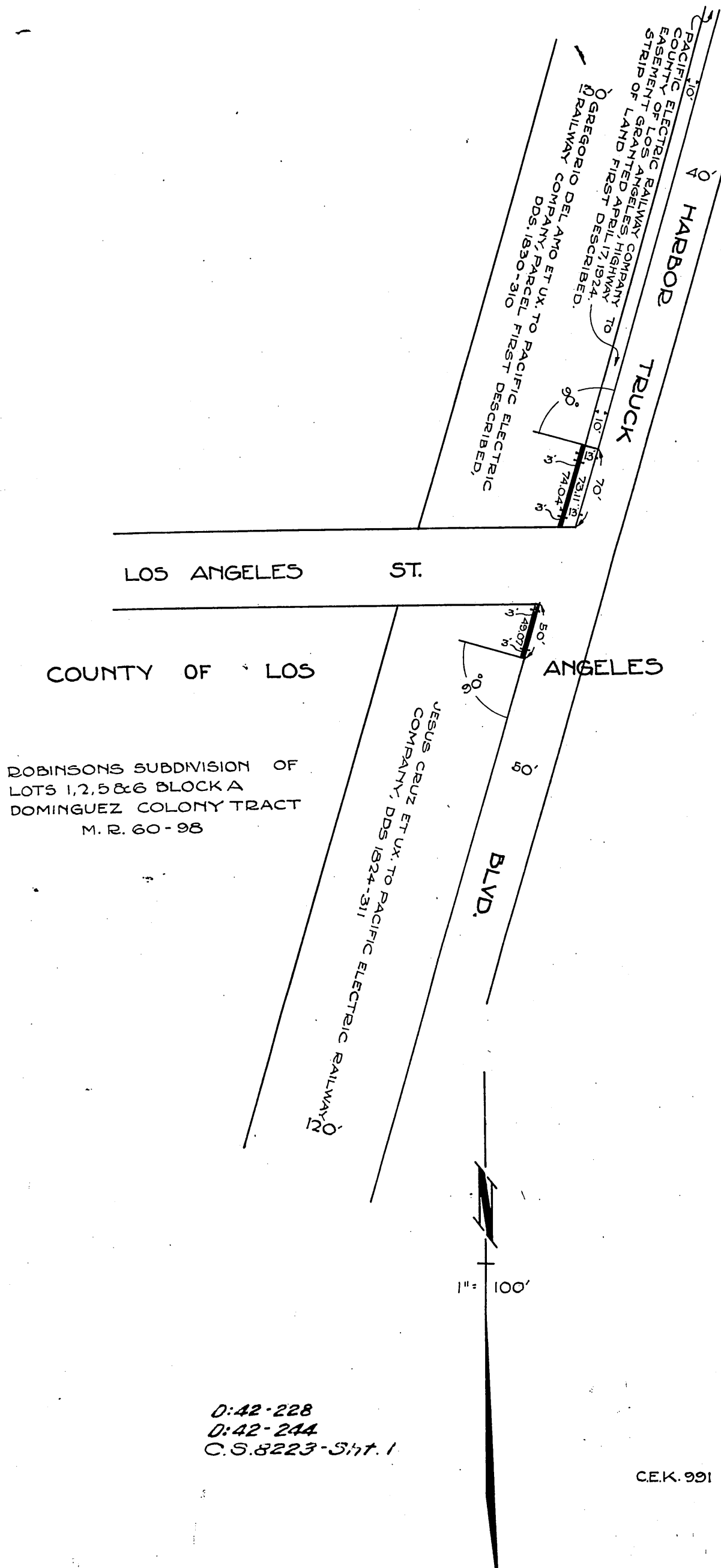

ROBINSONS SUBDIVISION OF  
LOTS 1, 2, 5 & 6 BLOCK A  
DOMINGUEZ COLONY TRACT  
M. R. 60-98

D:42-228  
D:42-244  
C.S. 8223-Sht. 1

CE.K. 991

Los Angeles St. changed to Del Amo St. D:49-33 R.B. 40-122

RECORDED NOV. 6, 1924

A-421  
A. 105

Sheet No. 20  
26

O.R. 3550